

# PS2H25 - Double Pumping Station

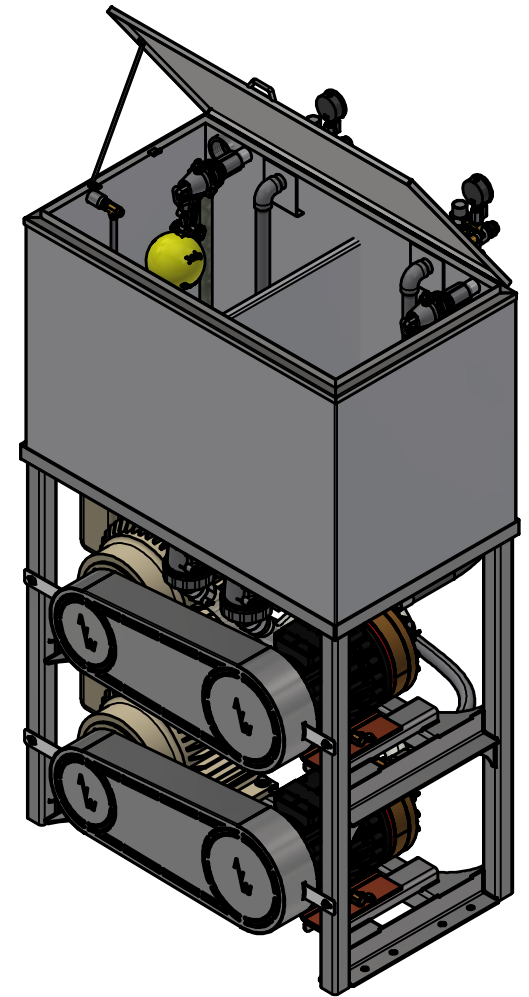
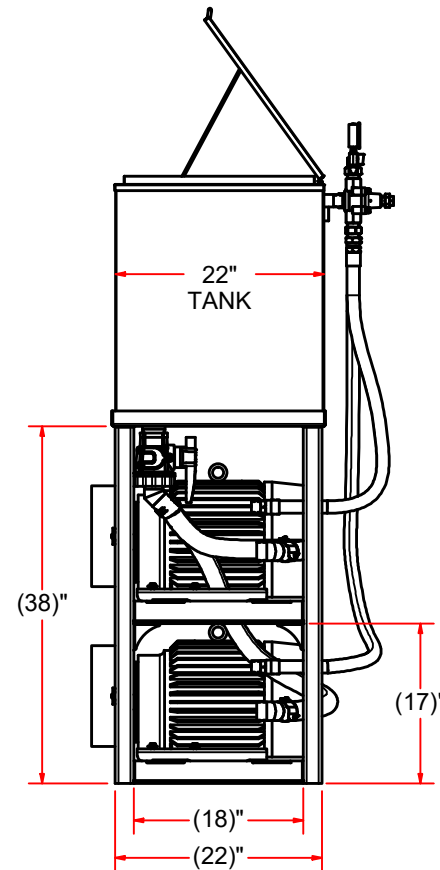
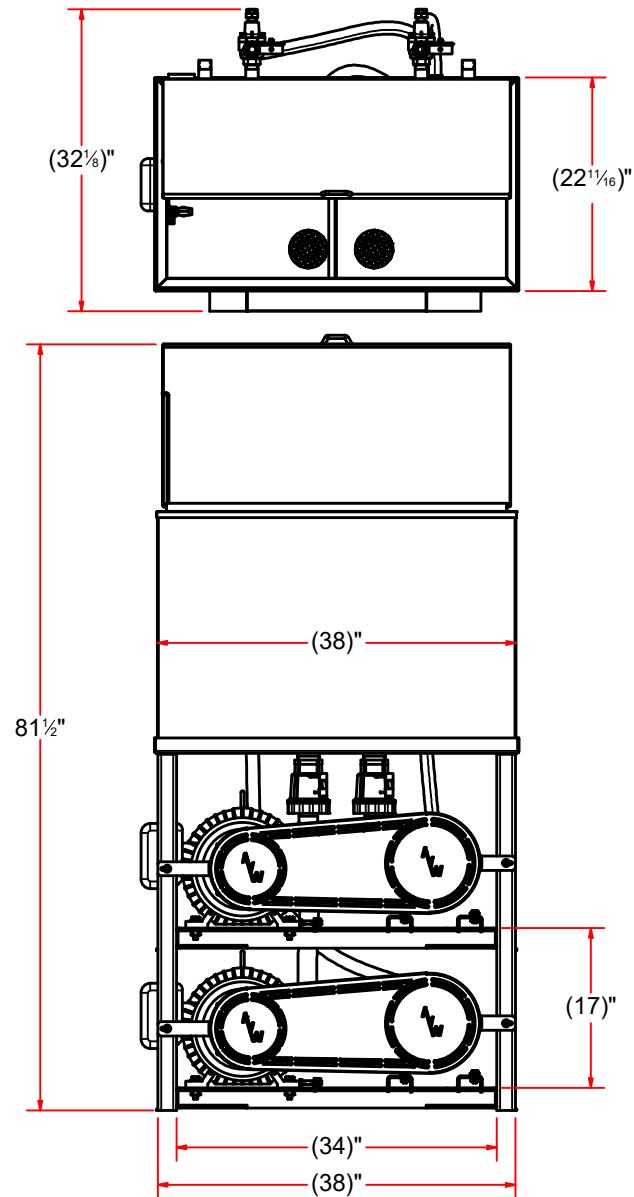

AVW EQUIPMENT CO., INC.  
105 S. 9TH AVENUE  
MAYWOOD, IL 60153  
Tel: 708-343-7738 Fax: 708-343-9065  
WWW.AVWEQUIPMENT.COM

## - COMPANY PROPRIETARY NOTE -

THIS DRAWING AND ITS DESIGNS ARE PROPERTY OF AVW EQUIPMENT CO. & IT IS NOT TO BE USED OR REPRODUCED WITHOUT THE PERMISSION FROM AVW CO.

DRAWN BY

Darpan

CUSTOMER: AVW EQUIPMENT CO.

CHECKED BY

PROJECT: PS2H25-DOUBLE STACK PUMPING STATION

QTY

DESCRIPTION: Double Pumping Station

RELEASE DATE

8/9/2018

PART NUMBER: PS2H25

REV# B

DIMENSION ARE IN INCHES & PROVIDED PRIOR TO SURFACE TREATMENTS, UNLESS NOTED.

SIZE A

EST WEIGHT: 449 lbmass

SHEET 1 of 25

PS2H25 - Double Pumping Station

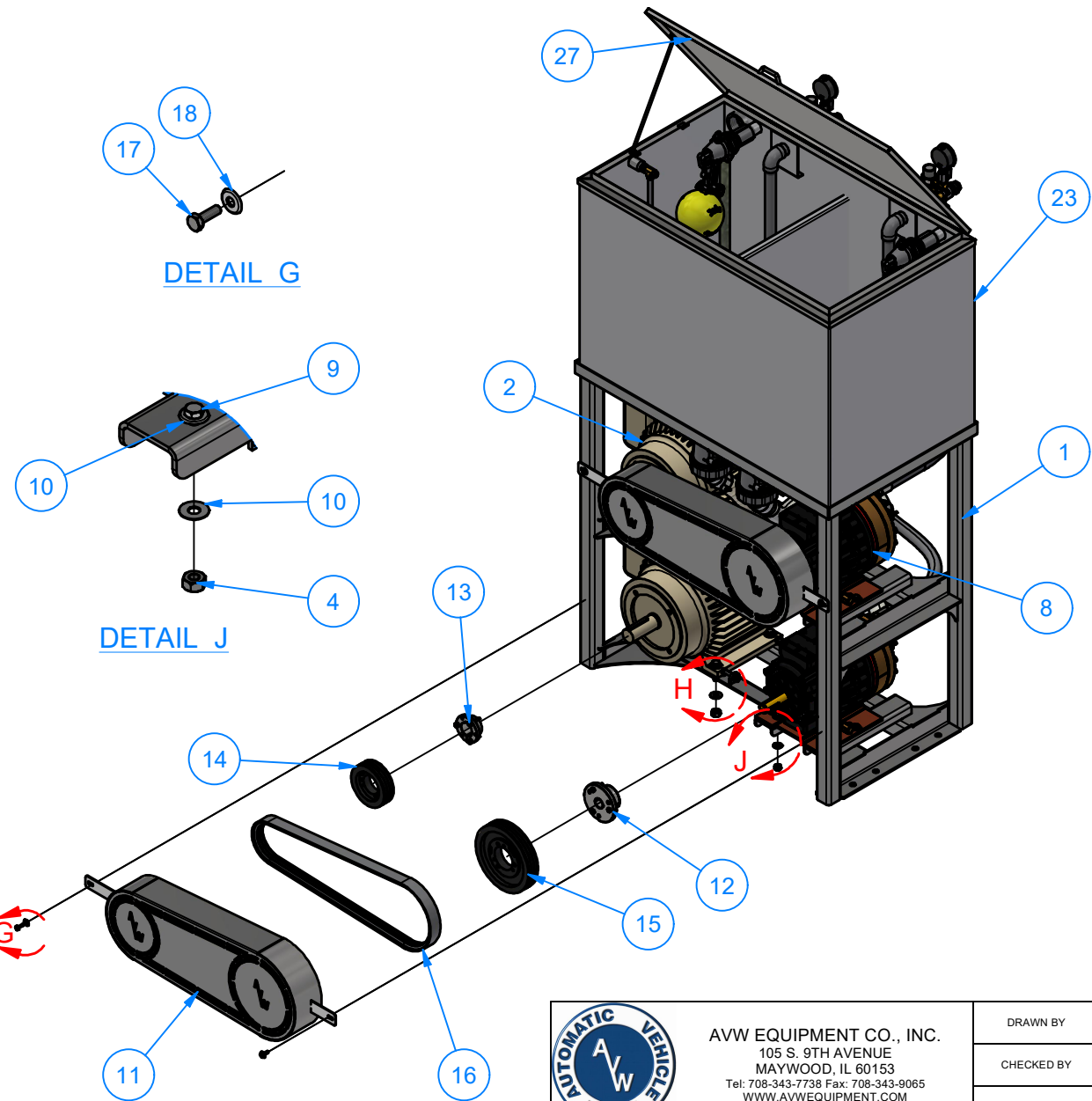

Parts List		
ITEM	QTY	DESCRIPTION
1	1	Double Pumping Station Stand
2	2	ELECTRIC MOTOR 15HP
3	4	3/8" - 16 x 2" UNC Hex Screw
4	12	3/8"-16 18-8ss Heavy Hex Nut
5	8	1/2"-13 x 2" L Hex Screw
6	16	1/2" Flat Washer
7	8	1/2-13 HEX NUT
8	2	Hydra Cell H25 Pump
9	8	3/8" - 16 x 1" UNC HEX SCREW
10	16	3/8" FLAT WASHER
11	2	H25 MOTOR BELT GUARD
12	2	SK 1-1/8 Pump Taper Bushing
13	2	3D3 1-5/8 Motor Taper Bushing
14	2	3V500SD3 Motor Pulley
15	2	3V800SK Pump Pulley
16	2	3VX600 Belt 60" LG
17	4	1/4"-20 UNC x3/4" LG. HEX SCREW
18	4	1/4" FLAT WASHER
23	1	Double Pumping Station Tank
27	1	Single Pumping Station Lid Assembly

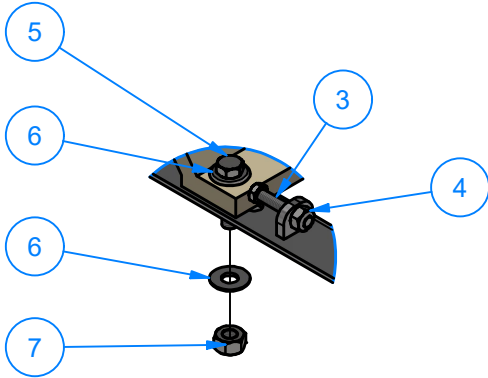

DETAIL H



AVW EQUIPMENT CO., INC.  
105 S. 9TH AVENUE  
MAYWOOD, IL 60153  
Tel: 708-343-7738 Fax: 708-343-9065  
WWW.AVWEQUIPMENT.COM

- COMPANY PROPRIETARY NOTE -  
THIS DRAWING AND ITS DESIGNS ARE PROPERTY OF AVW EQUIPMENT CO. &  
IT IS NOT TO BE USED OR REPRODUCED WITHOUT THE PERMISSION FROM AVW CO.

DRAWN BY	Darpan	CUSTOMER: AVW EQUIPMENT CO.	
CHECKED BY		PROJECT: PS2H25-DOUBLE STACK PUMPING STATION	
QTY		DESCRIPTION: Double Pumping Station	
RELEASE DATE	8/9/2018	PART NUMBER: PS2H25	REV# B
DIMENSION ARE IN INCHES & PROVIDED PRIOR TO SURFACE TREATMENTS, UNLESS NOTED.		SIZE A	EST WEIGHT: 449 lbmass
			SHEET 2 of 25

PS2H25 - Double Pumping Station

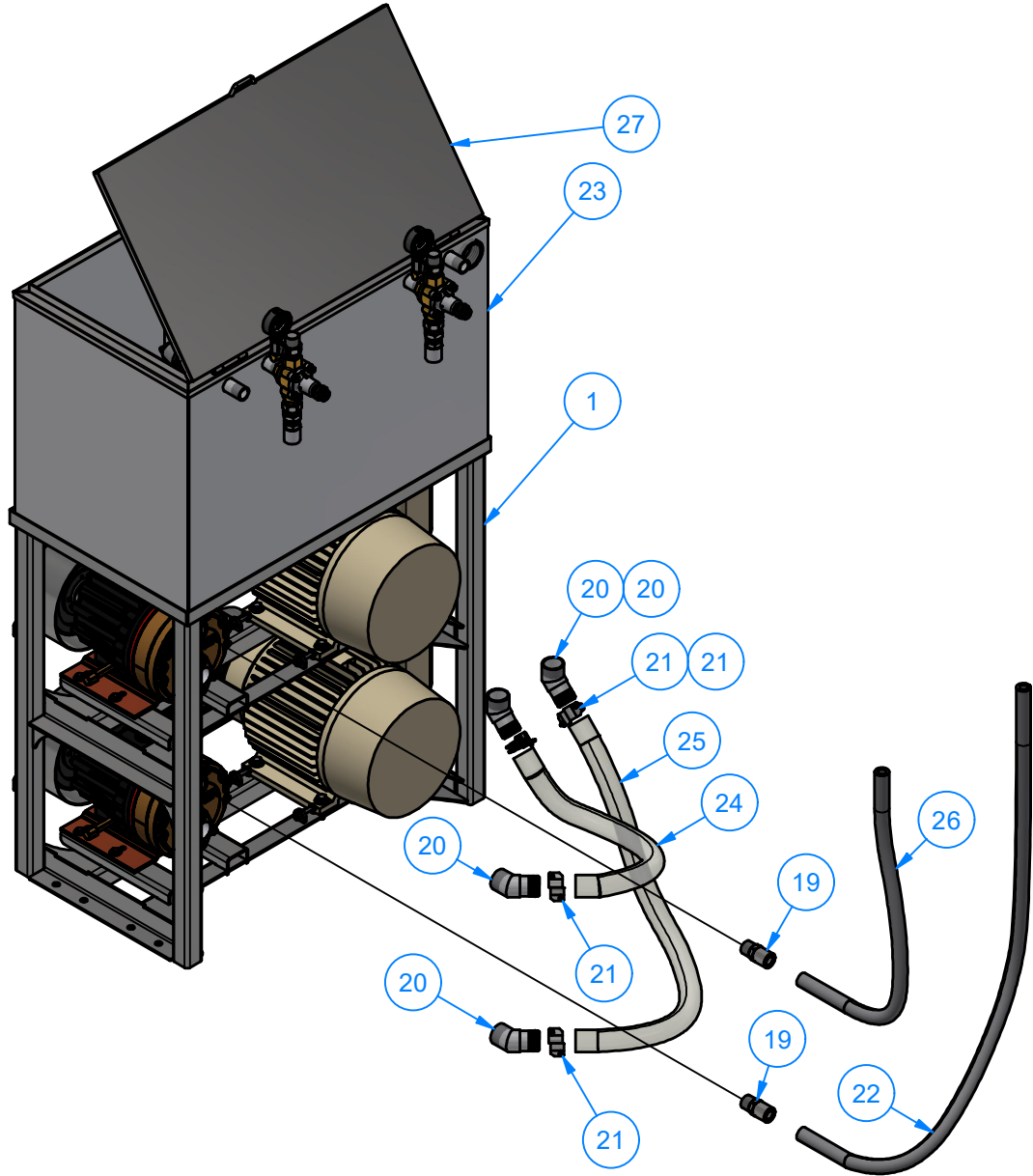

Parts List		
ITEM	QTY	DESCRIPTION
1	1	Double Pumping Station Stand
19	2	1" Global Crimp Fitting (male)
20	4	Angle Hose Barb 2" X 1-1/2" NPTM
21	4	1 1/2" Tiger Clamp
22	1	Discharge Hose (1" ID x 50" LG) - Lower Pump
23	1	Double Pumping Station Tank
24	1	Hose Intake (2" ID x 37" LG)
25	1	Hose Intake (2" ID x 40" LG)
26	1	Discharge Hose (1" ID x 41" LG) - Upper Pump
27	1	Single Pumping Station Lid Assembly



AVW EQUIPMENT CO., INC.  
105 S. 9TH AVENUE  
MAYWOOD, IL 60153  
Tel: 708-343-7738 Fax: 708-343-9065  
WWW.AVWEQUIPMENT.COM

- COMPANY PROPRIETARY NOTE -  
THIS DRAWING AND ITS DESIGNS ARE PROPERTY OF AVW EQUIPMENT CO. &  
IT IS NOT TO BE USED OR REPRODUCED WITHOUT THE PERMISSION FROM AVW CO.

DRAWN BY	Darpan	CUSTOMER: AVW EQUIPMENT CO.	
CHECKED BY		PROJECT: PS2H25-DOUBLE STACK PUMPING STATION	
QTY		DESCRIPTION: Double Pumping Station	
RELEASE DATE	8/9/2018	PART NUMBER: PS2H25	REV# B
DIMENSION ARE IN INCHES & PROVIDED PRIOR TO SURFACE TREATMENTS, UNLESS NOTED.		SIZE A	EST WEIGHT: 449 lbmass
			SHEET 3 of 25

# PS2H25A - Double Pumping Station Stand

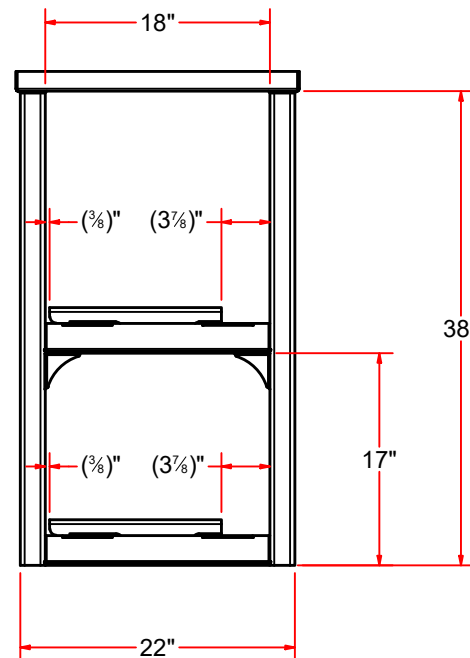
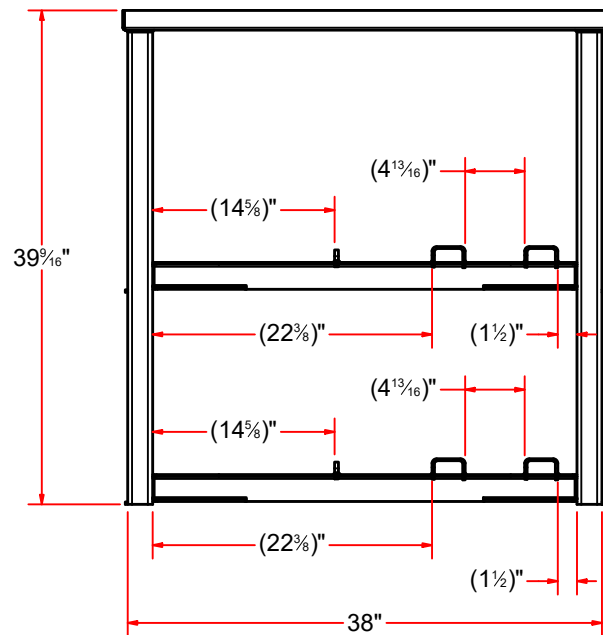
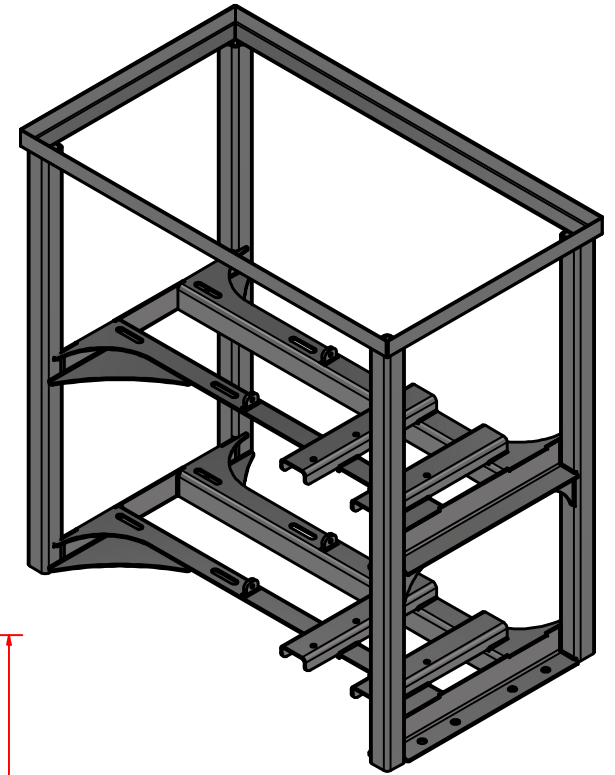
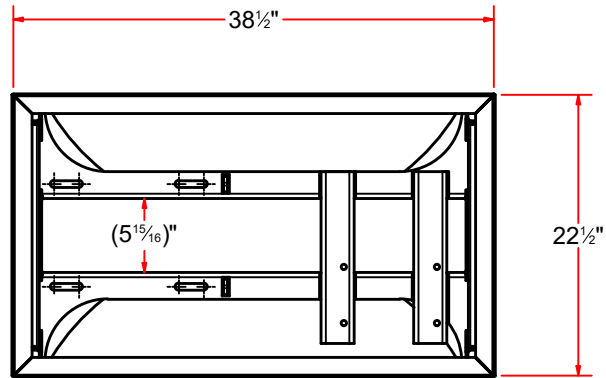

AVW EQUIPMENT CO., INC.  
105 S. 9TH AVENUE  
MAYWOOD, IL 60153  
Tel: 708-343-7738 Fax: 708-343-9065  
WWW.AVWEQUIPMENT.COM

## - COMPANY PROPRIETARY NOTE -

THIS DRAWING AND ITS DESIGNS ARE PROPERTY OF AVW EQUIPMENT CO. & IT IS NOT TO BE USED OR REPRODUCED WITHOUT THE PERMISSION FROM AVW CO.

DRAWN BY

Darpan

CUSTOMER: AVW EQUIPMENT CO.

CHECKED BY

PROJECT: PS2H25-DOUBLE STACK PUMPING STATION

QTY

DESCRIPTION: Double Pumping Station Stand

RELEASE DATE

8/9/2018

PART NUMBER: PS2H25A

REV#

DIMENSION ARE IN INCHES & PROVIDED PRIOR TO SURFACE TREATMENTS, UNLESS NOTED.

SIZE A

EST WEIGHT: 89 lbmass

SHEET 4 of 25

PATH:L:\Designs\Product Lines\Pumping Stations\H25\PS2H25 - Double Pumping Station - w revised tank\Parts\PS2H25-A - Double Stack Pumping Station Stand\_Revised\PS2H25-A.iam

PS2H25A - Double Pumping Station Stand

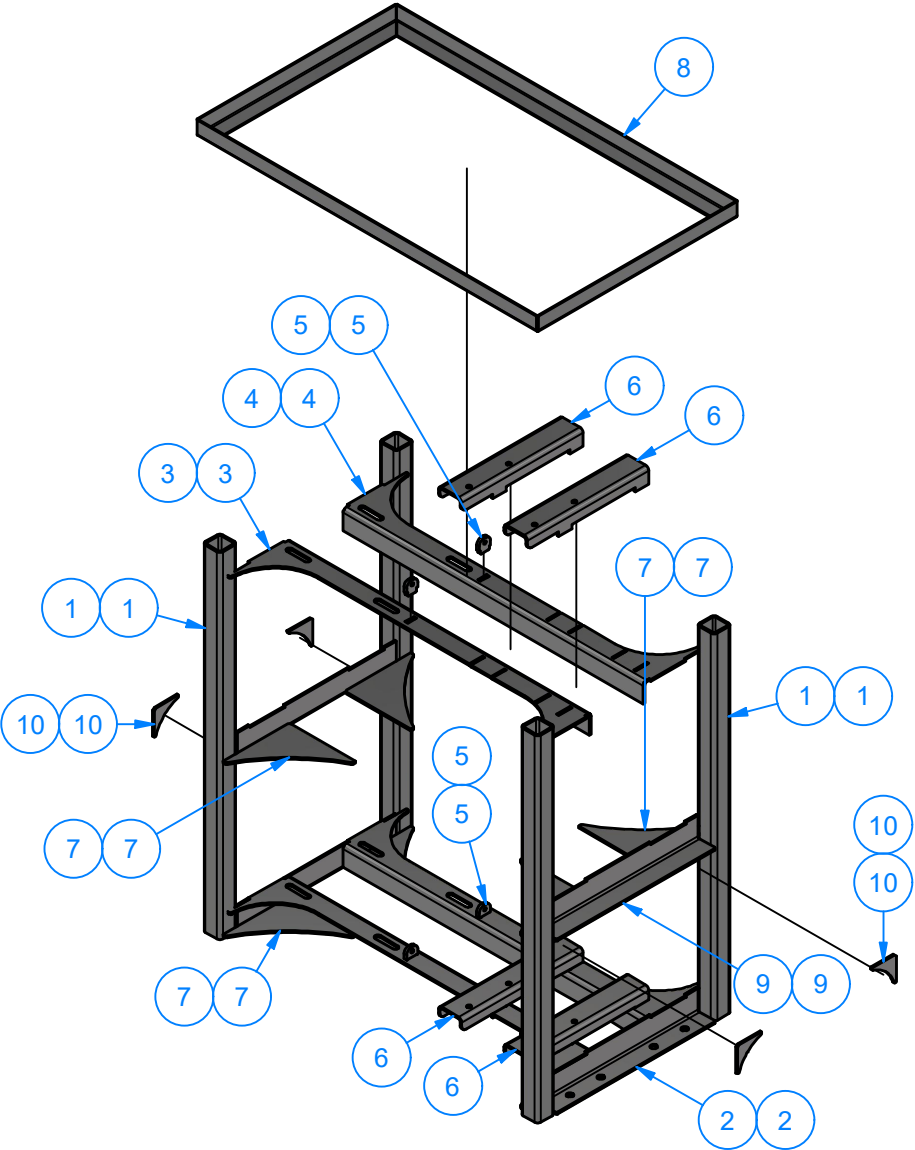

DOUBLE STACK PUMPING STAND		
ITEM	QTY	DESCRIPTION
1	4	Sqt. Tube #12Ga x 2" x 2" x 38" LG.
2	2	Plate #3/16" x 4 1/4" x 18" LG.
3	2	Plate #3/16" x 9" x 34 3/8" LG.
4	2	Plate #3/16" x 9" x 34 3/8" LG.
5	4	Plate #5/16" x 1 1/4" x 1 3/8" LG.
6	4	Plate #3/16" x 5 3/8" x 13 3/4" LG.
7	8	Gusset #3/16" x 7 1/2" x 7 1/2"
8	1	STAND TOP 22 1/2" x 38 1/2" LG.
9	2	Plate #3/16" x 4 1/4" x 18" LG.
10	4	Gusset #3/16" x 2 3/4" x 2 3/4"

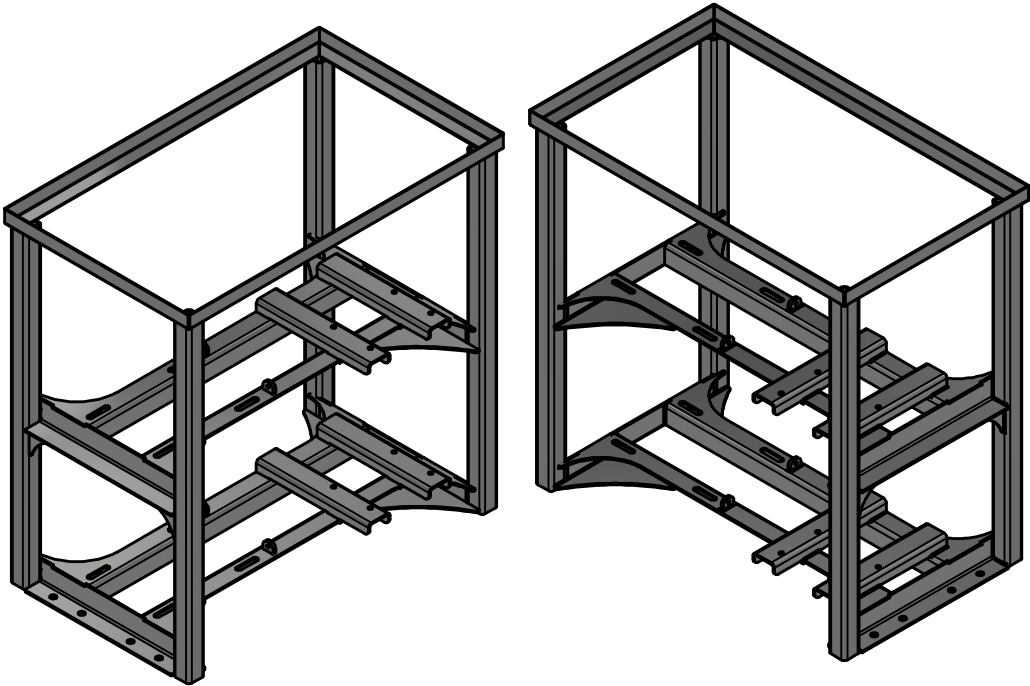

AVW EQUIPMENT CO., INC.  
105 S. 9TH AVENUE  
MAYWOOD, IL 60153  
Tel: 708-343-7738 Fax: 708-343-9065  
WWW.AVWEQUIPMENT.COM

- COMPANY PROPRIETARY NOTE -  
THIS DRAWING AND ITS DESIGNS ARE PROPERTY OF AVW EQUIPMENT CO. &  
IT IS NOT TO BE USED OR REPRODUCED WITHOUT THE PERMISSION FROM AVW CO.

DRAWN BY	Darpan	CUSTOMER: AVW EQUIPMENT CO.	
CHECKED BY		PROJECT: PS2H25-DOUBLE STACK PUMPING STATION	
QTY		DESCRIPTION: Double Pumping Station Stand	
RELEASE DATE	8/9/2018	PART NUMBER: PS2H25A	REV#
DIMENSION ARE IN INCHES & PROVIDED PRIOR TO SURFACE TREATMENTS, UNLESS NOTED.		SIZE A	EST WEIGHT: 89 lbmass
			SHEET 5 of 25

PARTS FOR PS2H25A DUAL STACK PUMPING STATION STAND



ITEM 1

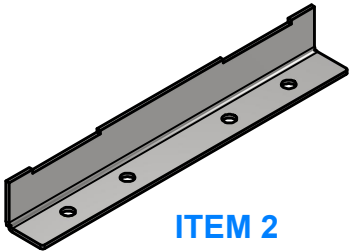
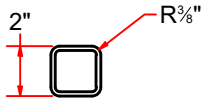
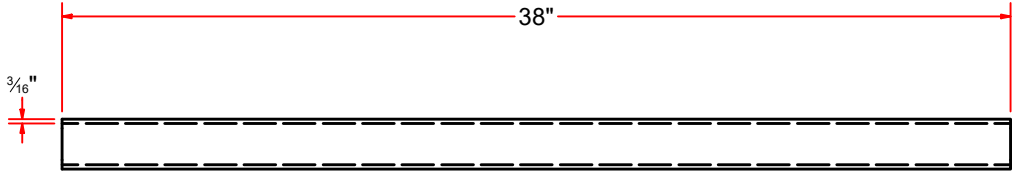

ITEM 2

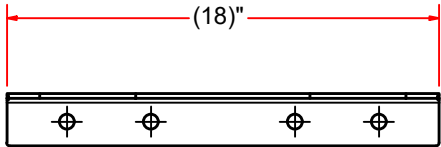
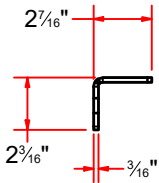

FORMED

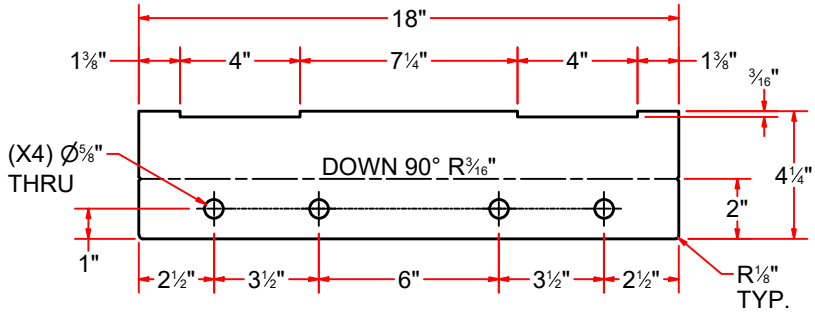

FLAT PATTERN

Plate #3/16" x 4 1/4" x 18" LG.



AVW EQUIPMENT CO., INC.  
105 S. 9TH AVENUE  
MAYWOOD, IL 60153  
Tel: 708-343-7738 Fax: 708-343-9065  
WWW.AVWEQUIPMENT.COM

- COMPANY PROPRIETARY NOTE -  
THIS DRAWING AND ITS DESIGNS ARE PROPERTY OF AVW EQUIPMENT CO. &  
IT IS NOT TO BE USED OR REPRODUCED WITHOUT THE PERMISSION FROM AVW CO.

DRAWN BY	Darpan	CUSTOMER: AVW EQUIPMENT CO.	
CHECKED BY		PROJECT: PS2H25-DOUBLE STACK PUMPING STATION	
QTY		DESCRIPTION: Plate #3/16" x 4 1/4" x 18" LG.	
RELEASE DATE	8/9/2018	PART NUMBER: PSH25AA	REV#
DIMENSION ARE IN INCHES & PROVIDED PRIOR TO SURFACE TREATMENTS, UNLESS NOTED.		SIZE A	EST WEIGHT:
			SHEET 6 of 25

PARTS FOR PS2H25A DUAL STACK PUMPING STATION STAND

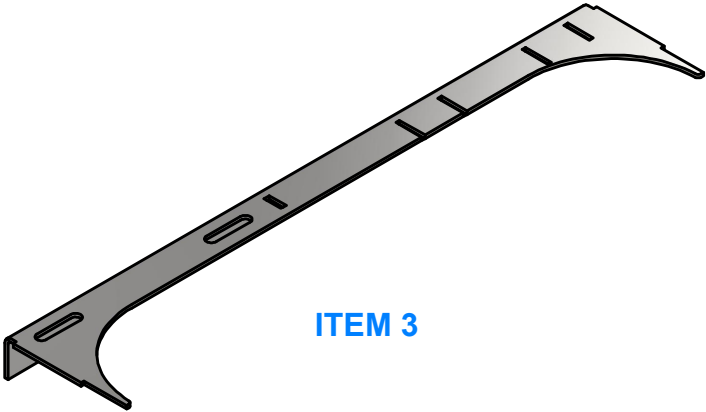

ITEM 3

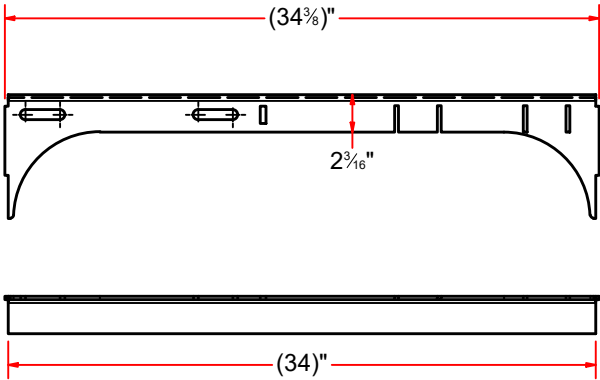

FORMED

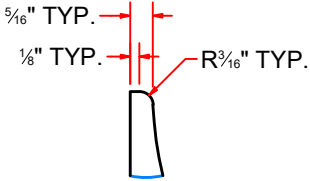
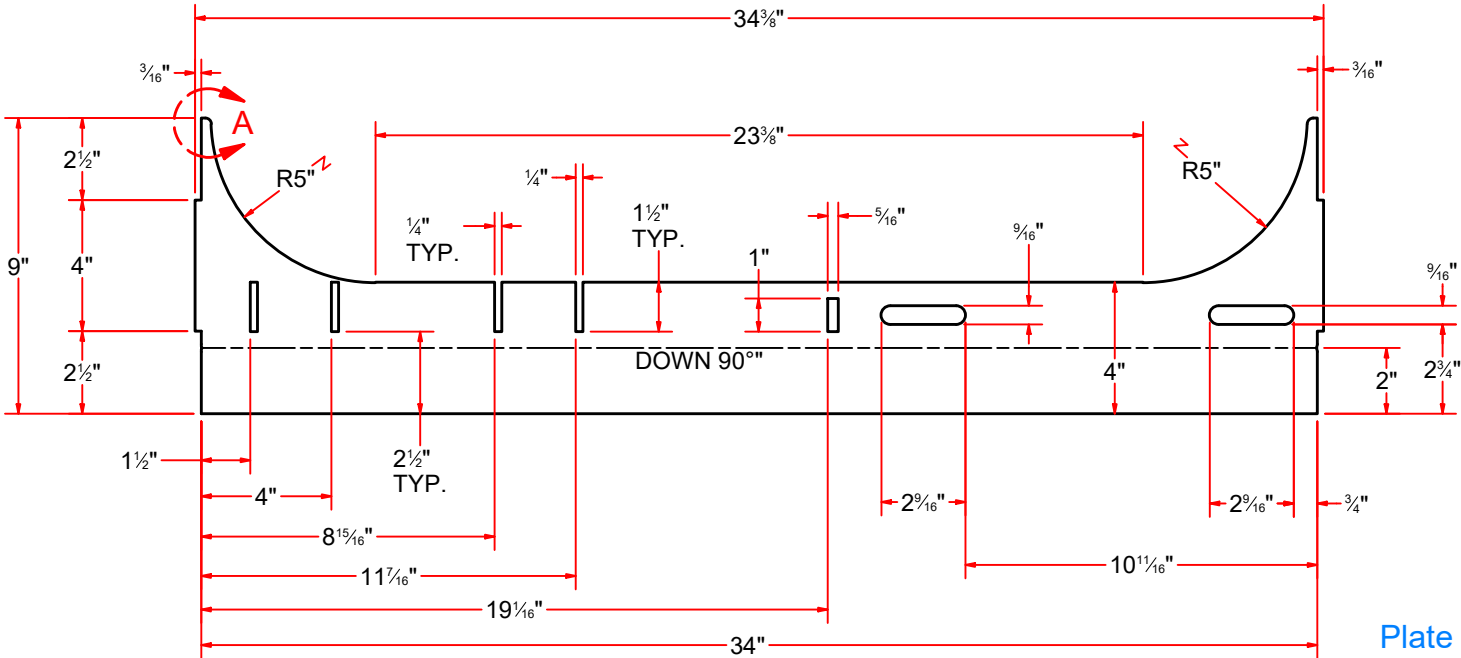
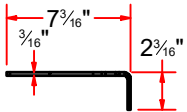

DETAIL A

FLAT PATTERN  
Plate #3/16" x 9" x 34 3/8" LG.



AVW EQUIPMENT CO., INC.  
105 S. 9TH AVENUE  
MAYWOOD, IL 60153  
Tel: 708-343-7738 Fax: 708-343-9065  
WWW.AVWEQUIPMENT.COM

- COMPANY PROPRIETARY NOTE -  
THIS DRAWING AND ITS DESIGNS ARE PROPERTY OF AVW EQUIPMENT CO. &  
IT IS NOT TO BE USED OR REPRODUCED WITHOUT THE PERMISSION FROM AVW CO.

DRAWN BY	Darpan	CUSTOMER: AVW EQUIPMENT CO.		
CHECKED BY		PROJECT: PS2H25-DOUBLE STACK PUMPING STATION		
QTY		DESCRIPTION: Plate #3/16" x 9" x 34 3/8" LG.		
RELEASE DATE	8/9/2018	PART NUMBER: PSH25AB	REV#	
DIMENSION ARE IN INCHES & PROVIDED PRIOR TO SURFACE TREATMENTS, UNLESS NOTED.		SIZE A	EST WEIGHT:	SHEET 7 of 25