

PSH25 - SINGLE PUMPING STATION

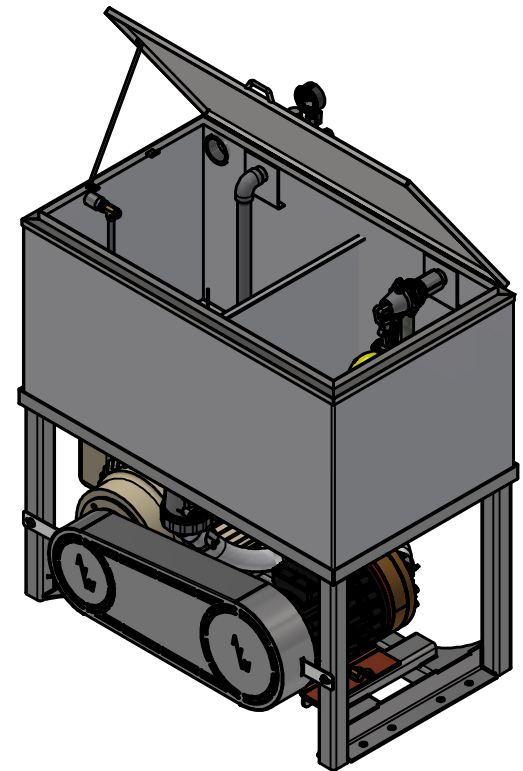
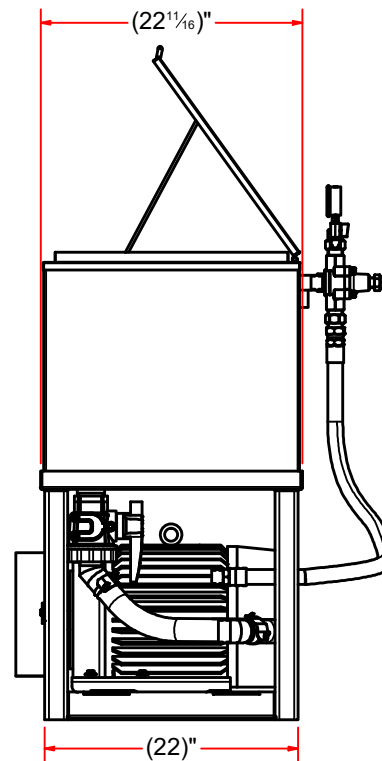
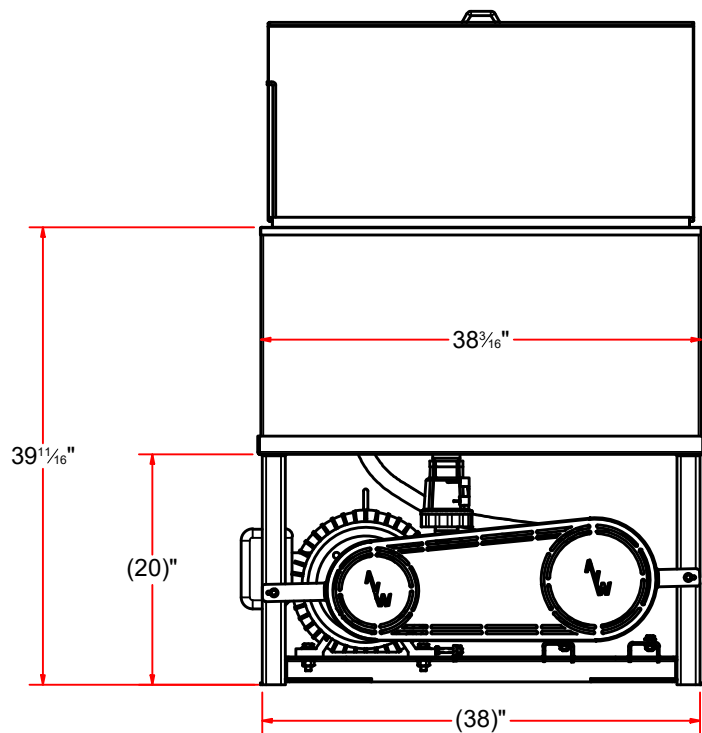
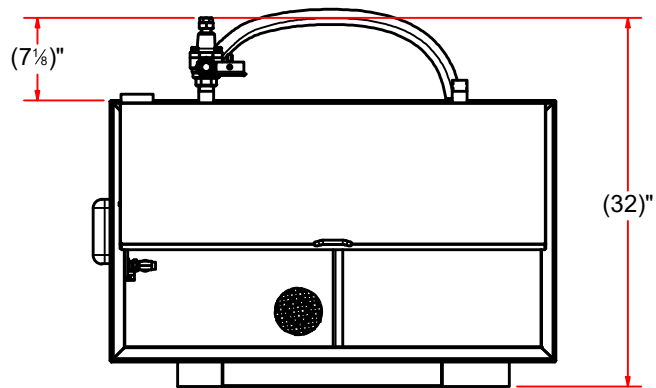

AVW EQUIPMENT CO., INC.
105 S. 9TH AVENUE
MAYWOOD, IL 60153
Tel: 708-343-7738 Fax: 708-343-9065
WWW.AVWEQUIPMENT.COM

- COMPANY PROPRIETARY NOTE -

THIS DRAWING AND ITS DESIGNS ARE PROPERTY OF AVW EQUIPMENT CO. &
IT IS NOT TO BE USED OR REPRODUCED WITHOUT THE PERMISSION FROM AVW CO.

DRAWN BY

Darpan

CUSTOMER: AVW EQUIPMENT CO.

CHECKED BY

PROJECT: PSH25 - SINGLE PUMPING STATION

QTY

DESCRIPTION: SINGLE PUMPING STATION

RELEASE
DATE

6/16/2021

PART NUMBER: PSH25

REV# 1

DIMENSION ARE IN INCHES & PROVIDED PRIOR
TO SURFACE TREATMENTS, UNLESS NOTED.

SIZE
A

EST WEIGHT: 301 lbmass

SHEET 1 of 23

PATH:L:\Designs\Product Lines\Pumping Stations\H25\PSH25 - Single Pumping Station - w revised tank\PSH25.iam

PSH25 - SINGLE PUMPING STATION

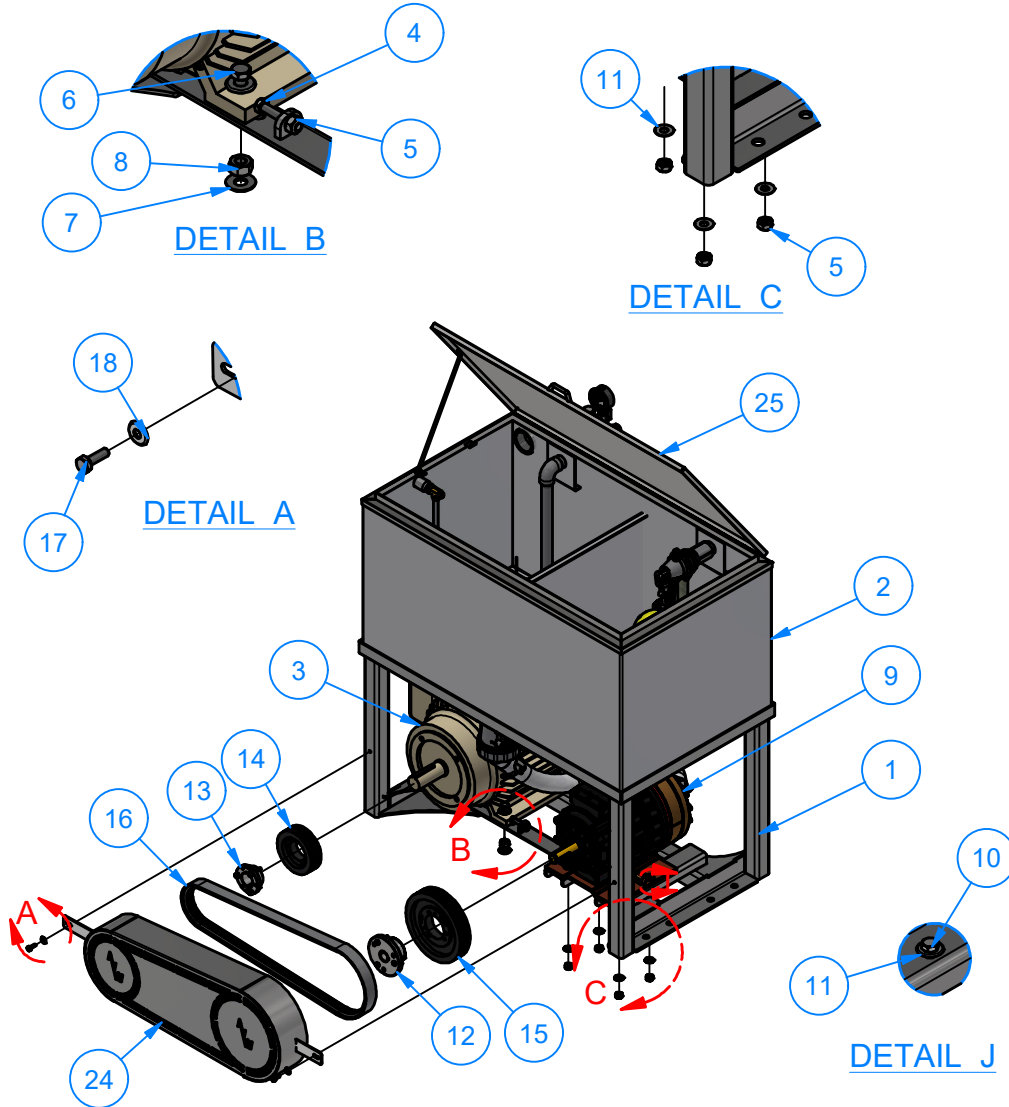

PSH25 - SINGLE PUMPING STATION

ITEM	QTY	DESCRIPTION
1	1	SINGLE PUMPING STATION STAND
2	1	Single Pumping Station Tank
3	1	ELECTRIC MOTOR 15HP
4	2	3/8" - 16 x 2" UNC Hex Screw
5	6	3/8"-16 18-8ss Heavy Hex Nut
6	4	1/2"-13 x 2" L Hex Screw
7	8	1/2" Flat Washer
8	4	1/2-13 HEX NUT
9	1	Hydra Cell H25 Pump
10	4	3/8" - 16 x 1" UNC HEX SCREW
11	8	3/8" FLAT WASHER
12	1	SK 1-1/8 Pump Taper Bushing
13	1	3D3 1-5/8 Motor Taper Bushing
14	1	3V500SD3 Motor Pulley
15	1	3V800SK Pump Pulley
16	1	3VX600 Belt 60" LG
17	2	1/4"-20 UNC x3/4" LG. HEX SCREW
18	2	1/4" FLAT WASHER
19	1	1" Global Crimp Fitting (male)
20	1	Intake Hose
21	1	Angle Hose Barb 2" X 1-1/2" NPTM
22	2	1 1/2" Tiger Clamp
23	1	Dishcharge Hose
24	1	H25 MOTOR BELT GUARD
25	1	Single Pumping Station Lid Assembly



AVW EQUIPMENT CO., INC.
105 S. 9TH AVENUE
MAYWOOD, IL 60153
Tel: 708-343-7738 Fax: 708-343-9065
WWW.AVWEQUIPMENT.COM

- COMPANY PROPRIETARY NOTE -

THIS DRAWING AND ITS DESIGNS ARE PROPERTY OF AVW EQUIPMENT CO. & IT IS NOT TO BE USED OR REPRODUCED WITHOUT THE PERMISSION FROM AVW CO.

DRAWN BY	Darpan	CUSTOMER: AVW EQUIPMENT CO.	
CHECKED BY		PROJECT: PSH25 - SINGLE PUMPING STATION	
QTY		DESCRIPTION: SINGLE PUMPING STATION	
RELEASE DATE	6/16/2021	PART NUMBER: PSH25	REV# 1
DIMENSION ARE IN INCHES & PROVIDED PRIOR TO SURFACE TREATMENTS, UNLESS NOTED.		SIZE A	EST WEIGHT: 301 lbmass
			SHEET 2 of 23

REDESIGNED STAND FOR EASIER
MANUFACTURING AND ASSEMBLING

PATH:L:\Designs\Product Lines\Pumping Stations\H25\PSH25 - Single Pumping Station - w revised tank\PSH25.iam

PSH25 - SINGLE PUMPING STATION

Parts List		
ITEM	QTY	DESCRIPTION
19	1	1" Global Crimp Fitting (male)
20	1	Intake Hose
21	1	Angle Hose Barb 2" X 1-1/2" NPTM
22	2	1 1/2" Tiger Clamp
23	1	Dishcharge Hose

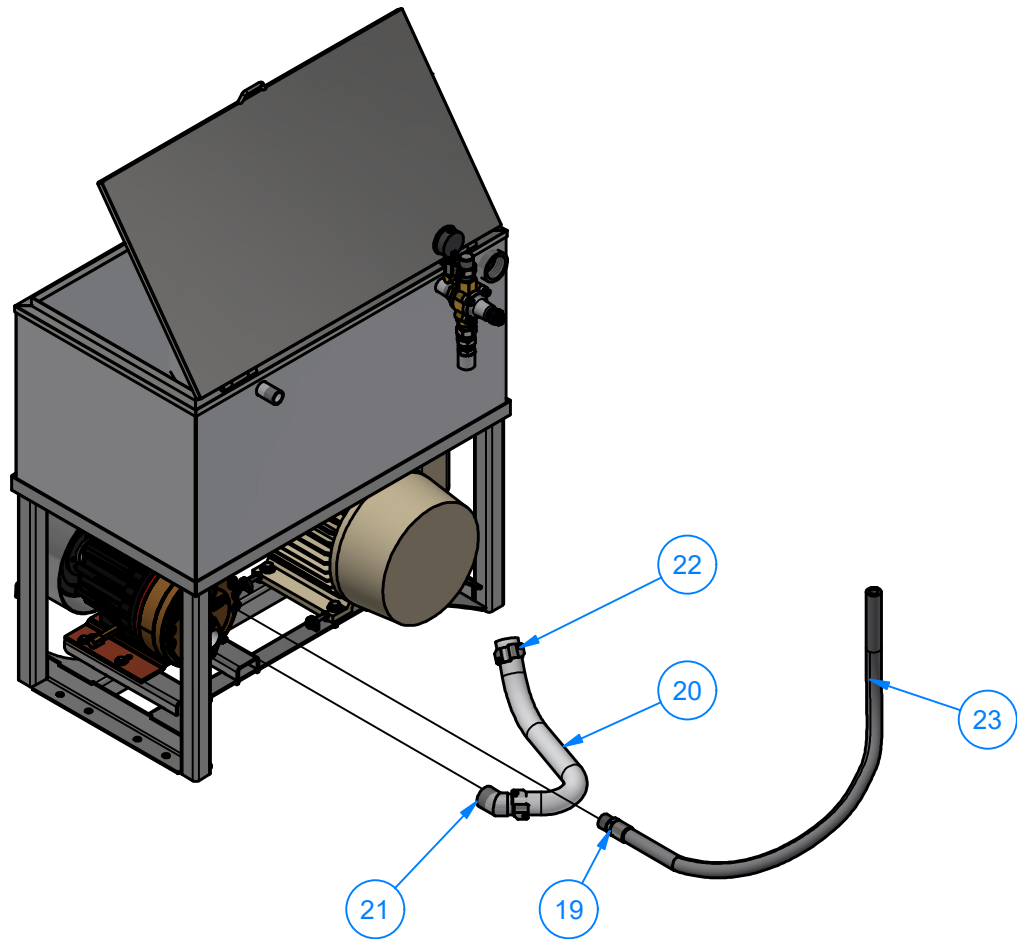

AVW EQUIPMENT CO., INC.
105 S. 9TH AVENUE
MAYWOOD, IL 60153
Tel: 708-343-7738 Fax: 708-343-9065
WWW.AVWEQUIPMENT.COM

- COMPANY PROPRIETARY NOTE -
THIS DRAWING AND ITS DESIGNS ARE PROPERTY OF AVW EQUIPMENT CO. &
IT IS NOT TO BE USED OR REPRODUCED WITHOUT THE PERMISSION FROM AVW CO.

DRAWN BY	Darpan	CUSTOMER: AVW EQUIPMENT CO.	
CHECKED BY		PROJECT: PSH25 - SINGLE PUMPING STATION	
QTY		DESCRIPTION: SINGLE PUMPING STATION	
RELEASE DATE	6/16/2021	PART NUMBER: PSH25	REV# 1
DIMENSION ARE IN INCHES & PROVIDED PRIOR TO SURFACE TREATMENTS, UNLESS NOTED.		SIZE A	EST WEIGHT: 301 lbmass
			SHEET 3 of 23

PSH25A - SINGLE PUMPING STATION STAND

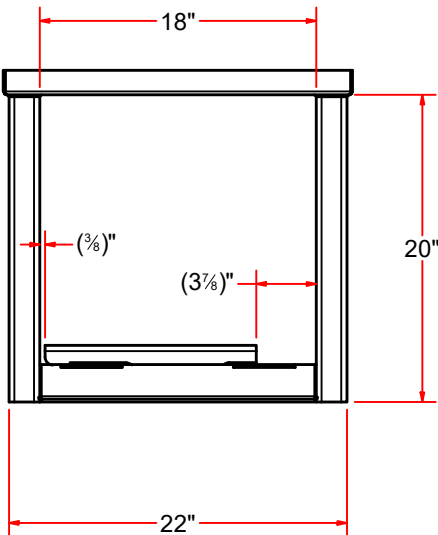
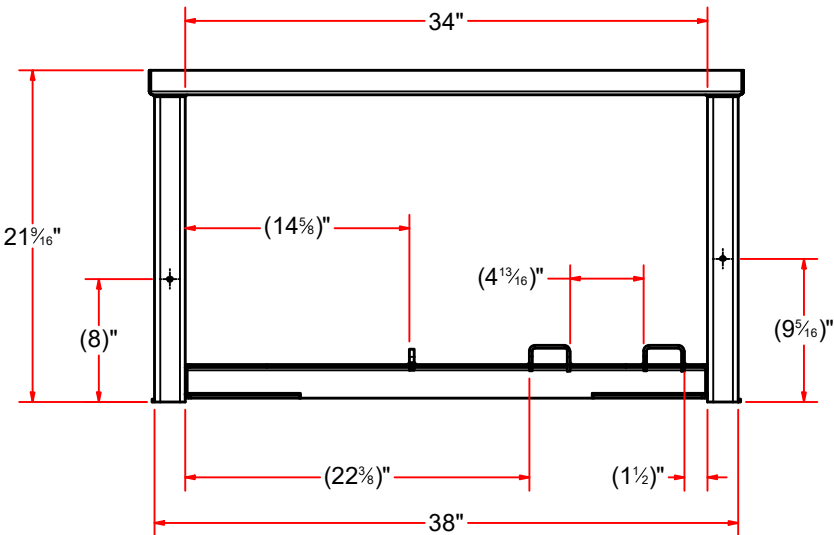
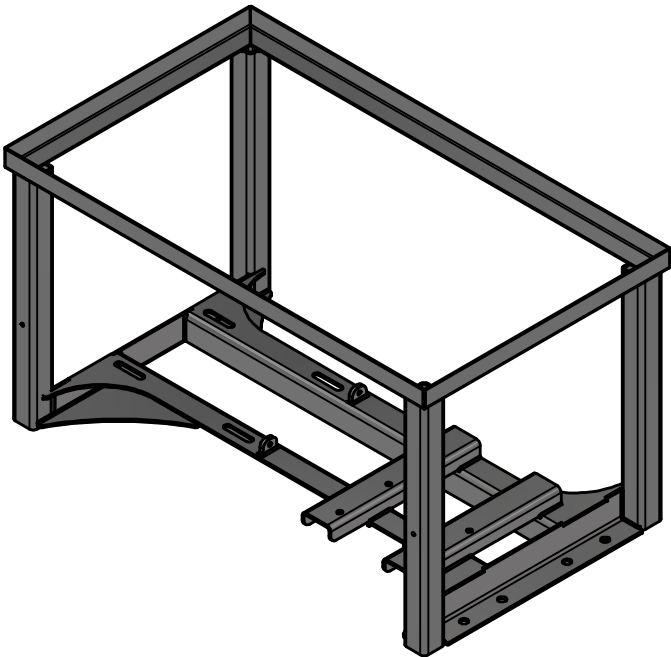
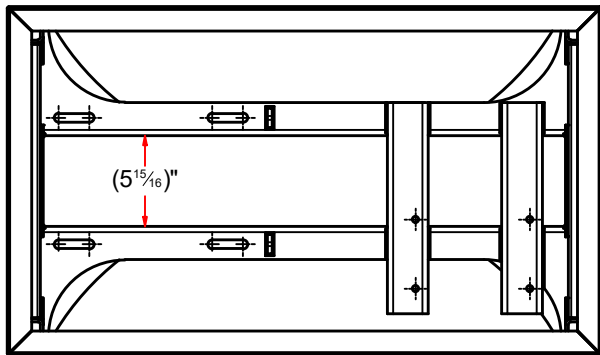

AVW EQUIPMENT CO., INC.
105 S. 9TH AVENUE
MAYWOOD, IL 60153
Tel: 708-343-7738 Fax: 708-343-9065
WWW.AVWEQUIPMENT.COM

- COMPANY PROPRIETARY NOTE -
THIS DRAWING AND ITS DESIGNS ARE PROPERTY OF AVW EQUIPMENT CO. &
IT IS NOT TO BE USED OR REPRODUCED WITHOUT THE PERMISSION FROM AVW CO.

DRAWN BY	Darpan	CUSTOMER: AVW EQUIPMENT CO.	
CHECKED BY		PROJECT: PSH25 - SINGLE PUMPING STATION	
QTY		DESCRIPTION: SINGLE PUMPING STATION STAND	
RELEASE DATE	6/16/2021	PART NUMBER: PSH25A	REV# 1
DIMENSION ARE IN INCHES & PROVIDED PRIOR TO SURFACE TREATMENTS, UNLESS NOTED.		SIZE A	EST WEIGHT: 60 lbmass
			SHEET 4 of 23

PSH25A - SINGLE PUMPING STATION STAND

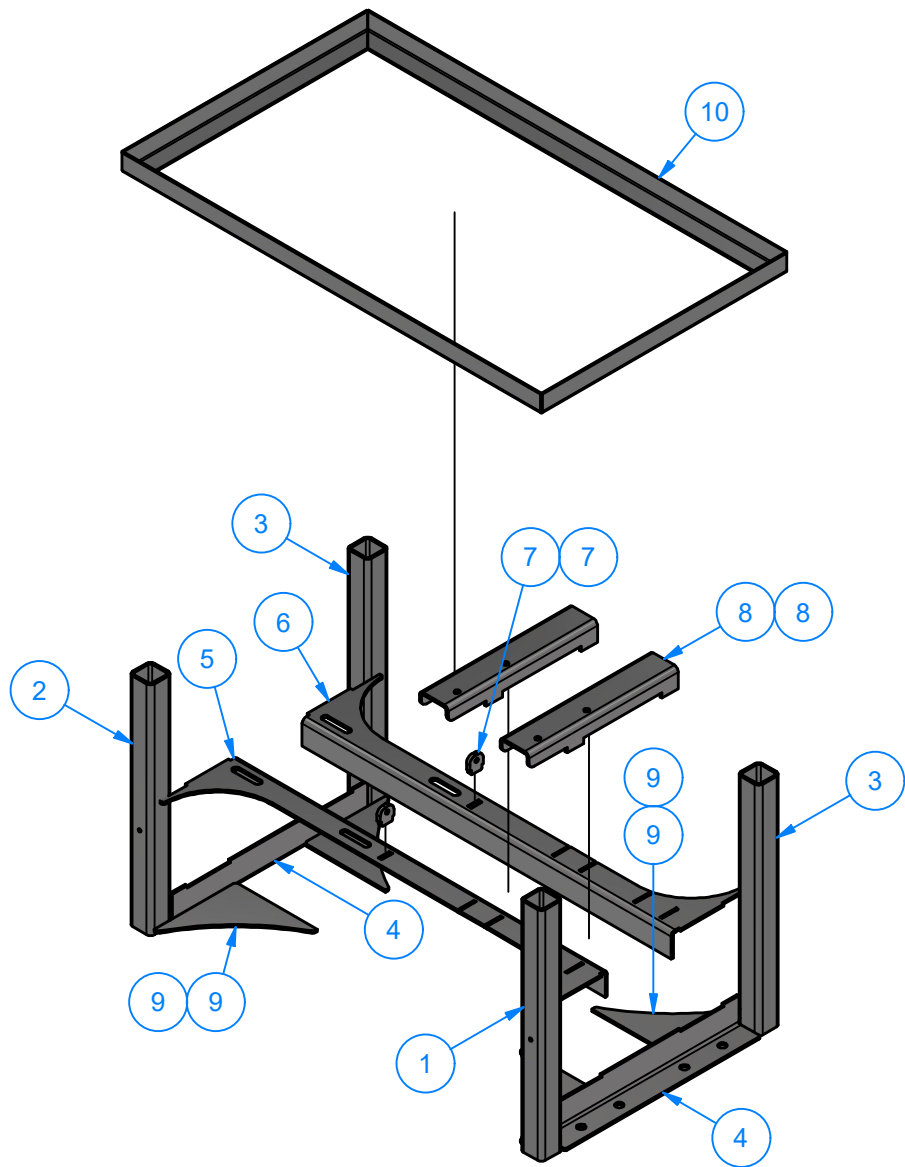

PSH25-A_SINGLE PUMPING STATION STAND		
ITEM	QTY	DESCRIPTION
1	1	Sqt. Tube #11Ga x 2" x 2" x 20"
2	1	Sqt. Tube #11Ga x 2" x 2" x 20"
3	2	Sq. Tube #11Ga. 2 x 20 LG.
4	2	Plate #3/16" x 4 1/4" x 18" LG.
5	1	Plate #3/16" x 9" x 34 3/8" LG.
6	1	Plate #3/16" x 9" x 34 3/8" LG.
7	2	Plate #5/16" x 1 1/4" x 1 3/8" LG.
8	2	Plate #3/16" x 5 3/8" x 13 3/4" LG.
9	4	Gusset #3/16" x 7 1/2" x 7 1/2"
10	1	STAND TOP 22 1/2" x 38 1/2" LG.

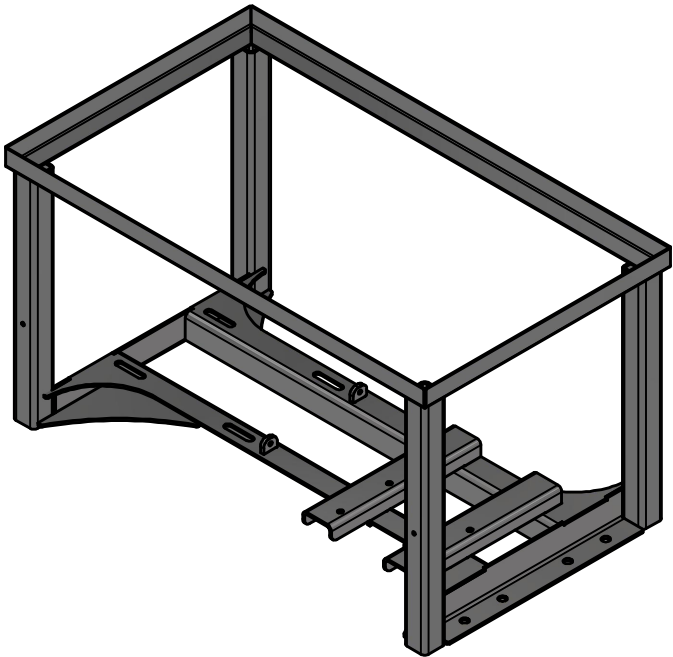

AVW EQUIPMENT CO., INC.
105 S. 9TH AVENUE
MAYWOOD, IL 60153
Tel: 708-343-7738 Fax: 708-343-9065
WWW.AVWEQUIPMENT.COM

- COMPANY PROPRIETARY NOTE -
THIS DRAWING AND ITS DESIGNS ARE PROPERTY OF AVW EQUIPMENT CO. &
IT IS NOT TO BE USED OR REPRODUCED WITHOUT THE PERMISSION FROM AVW CO.

DRAWN BY	Darpan	CUSTOMER: AVW EQUIPMENT CO.	
CHECKED BY		PROJECT: PSH25 - SINGLE PUMPING STATION	
QTY		DESCRIPTION: SINGLE PUMPING STATION STAND	
RELEASE DATE	6/16/2021	PART NUMBER: PSH25A	REV# 1
DIMENSION ARE IN INCHES & PROVIDED PRIOR TO SURFACE TREATMENTS, UNLESS NOTED.		SIZE A	EST WEIGHT: 60 lbmass
			SHEET 5 of 23

PARTS FOR PSH25-A SINGLE PUMPING STATION STAND

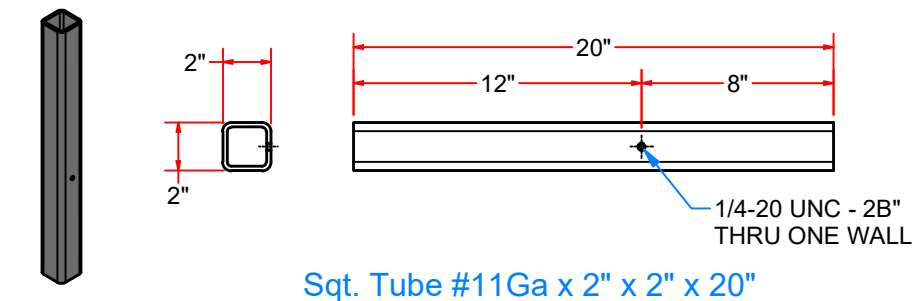

ITEM 2

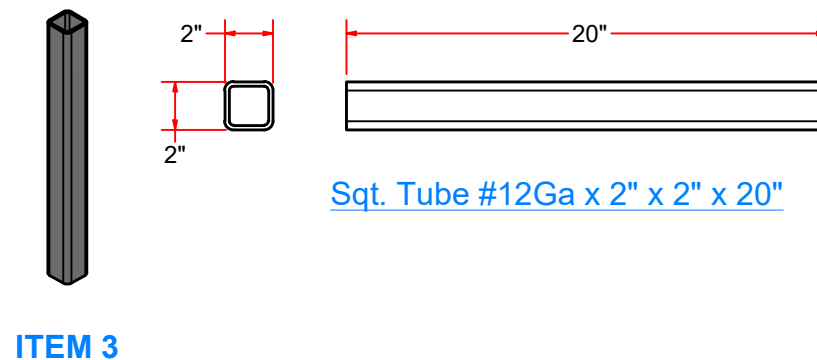

ITEM 3

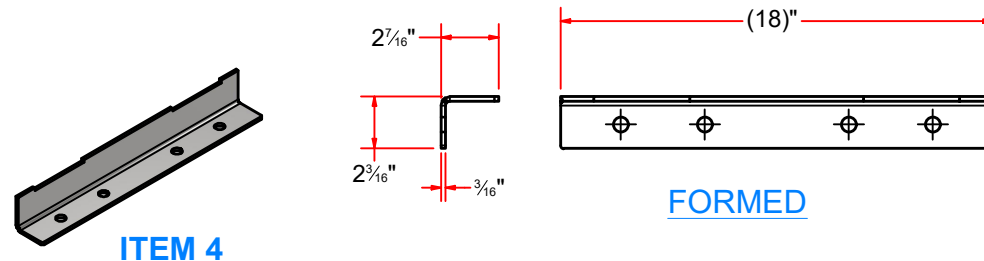

ITEM 4

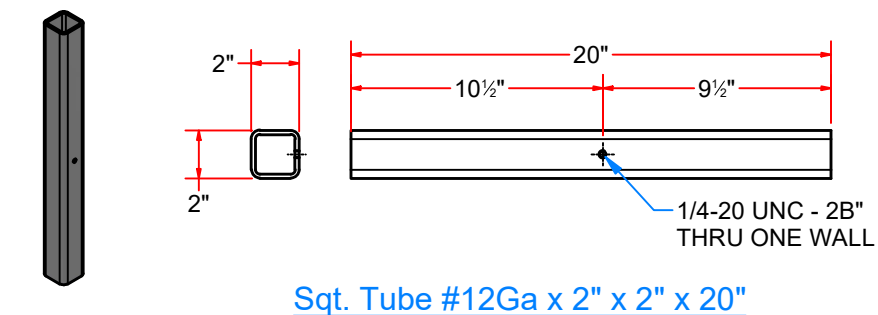

ITEM 1

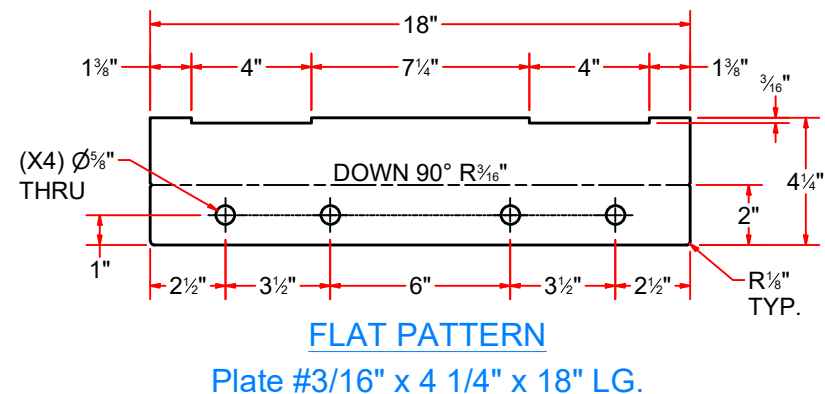

AVW EQUIPMENT CO., INC.
105 S. 9TH AVENUE
MAYWOOD, IL 60153
Tel: 708-343-7738 Fax: 708-343-9065
WWW.AVWEQUIPMENT.COM

- COMPANY PROPRIETARY NOTE -

THIS DRAWING AND ITS DESIGNS ARE PROPERTY OF AVW EQUIPMENT CO. & IT IS NOT TO BE USED OR REPRODUCED WITHOUT THE PERMISSION FROM AVW CO.

DRAWN BY

Darpan

CUSTOMER: AVW EQUIPMENT CO.

CHECKED BY

PROJECT: PSH25 - SINGLE PUMPING STATION

QTY

DESCRIPTION: Sqt. Tube #12Ga x 2" x 2" x 20"

RELEASE DATE

6/16/2021

PART NUMBER: H25SPSF002

REV#

DIMENSION ARE IN INCHES & PROVIDED PRIOR TO SURFACE TREATMENTS, UNLESS NOTED.

SIZE A

EST WEIGHT:

SHEET 6 of 23

PATH:C:\Local Vault\Designs\Product Lines\Backroom\Pumping Stations\H25-Pumping Stations\H25SPS - H25 Single Pumping Station\Parts\H25SPSF - H25 Single Pumping Station Frame\Parts\H25SPSF002.ipt

PARTS FOR PSH25-A SINGLE PUMPING STATION STAND

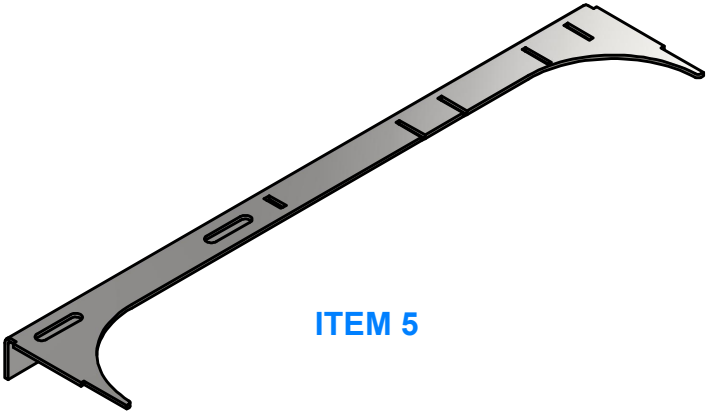

ITEM 5

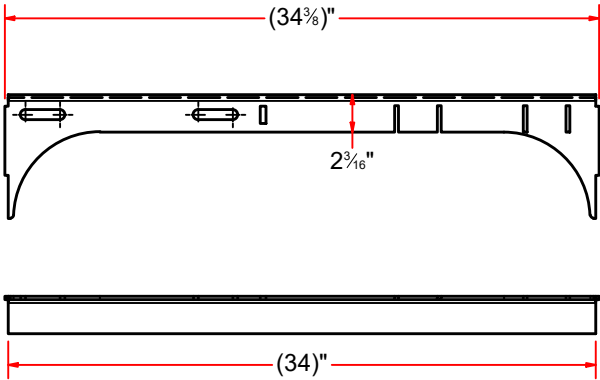

FORMED

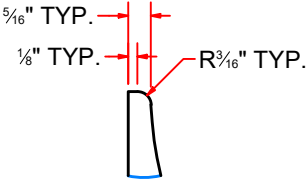
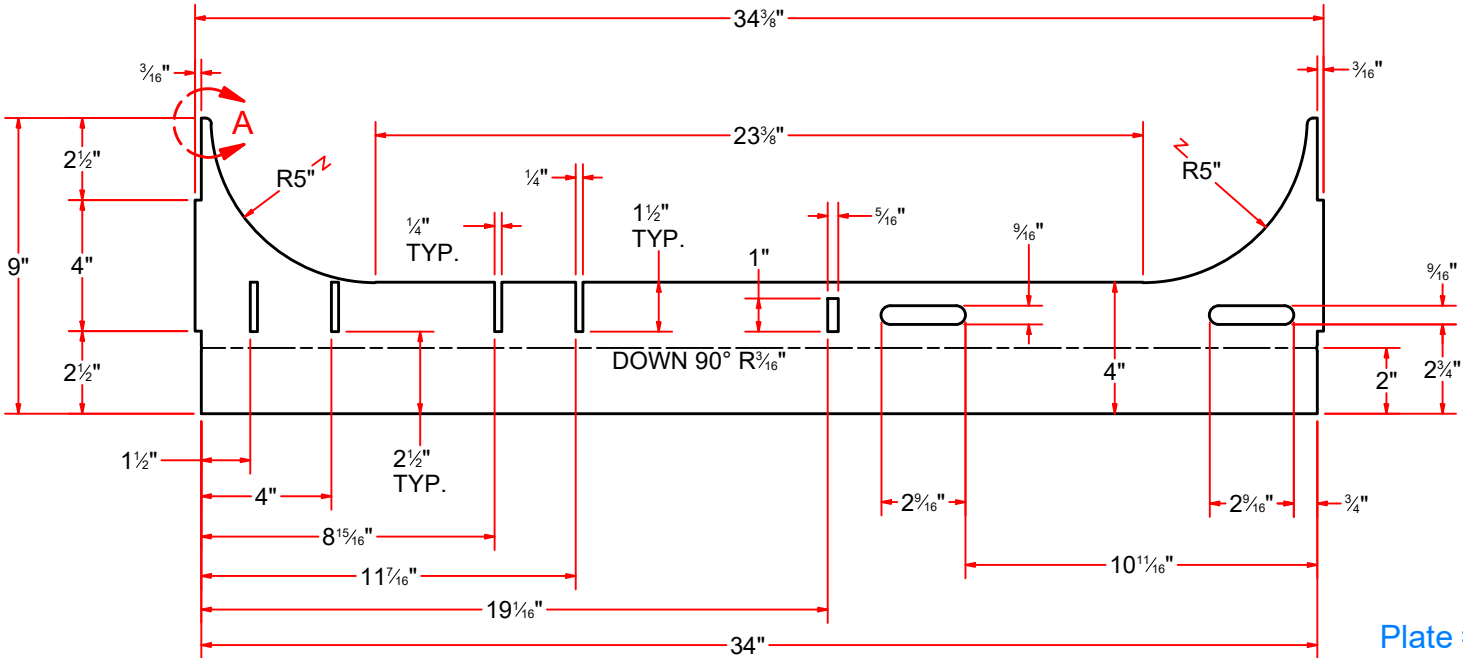
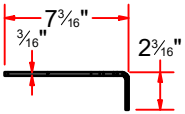

DETAIL A

FLAT PATTERN
Plate #3/16" x 9" x 34 3/8" LG.



AVW EQUIPMENT CO., INC.
105 S. 9TH AVENUE
MAYWOOD, IL 60153
Tel: 708-343-7738 Fax: 708-343-9065
WWW.AVWEQUIPMENT.COM

- COMPANY PROPRIETARY NOTE -
THIS DRAWING AND ITS DESIGNS ARE PROPERTY OF AVW EQUIPMENT CO. &
IT IS NOT TO BE USED OR REPRODUCED WITHOUT THE PERMISSION FROM AVW CO.

DRAWN BY	Darpan	CUSTOMER: AVW EQUIPMENT CO.	
CHECKED BY		PROJECT: PSH25 - SINGLE PUMPING STATION	
QTY		DESCRIPTION: Plate #3/16" x 9" x 34 3/8" LG.	
RELEASE DATE	6/16/2021	PART NUMBER: PSH25AB	REV#
DIMENSION ARE IN INCHES & PROVIDED PRIOR TO SURFACE TREATMENTS, UNLESS NOTED.		SIZE A	EST WEIGHT:
			SHEET 7 of 23

PARTS FOR PSH25-A SINGLE PUMPING STATION STAND

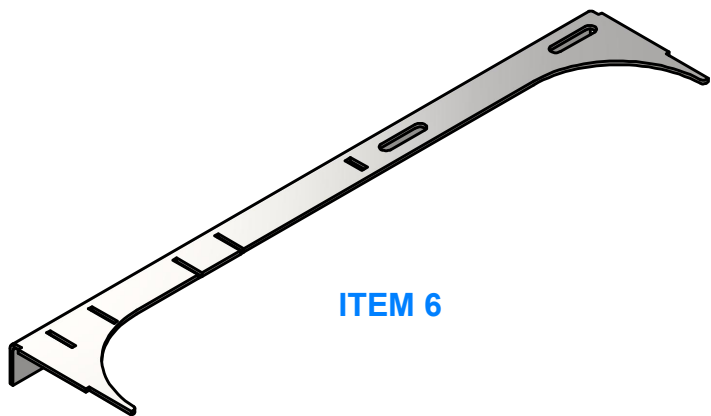

ITEM 6

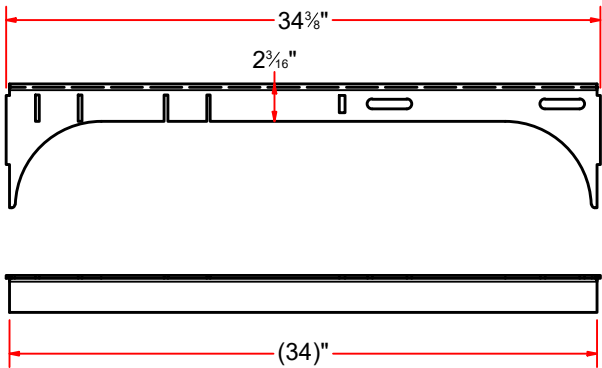

FORMED

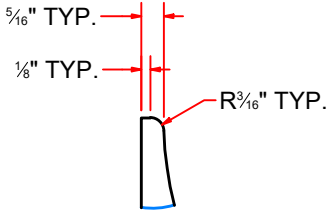
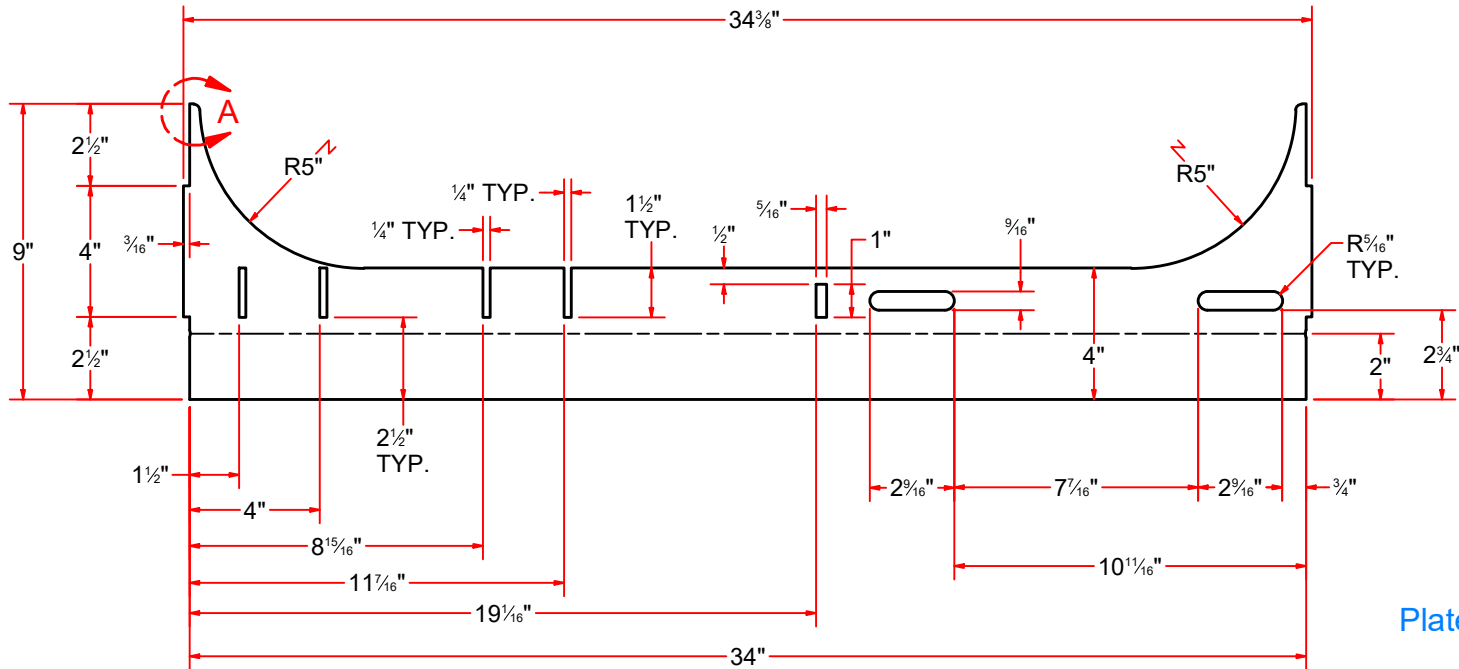
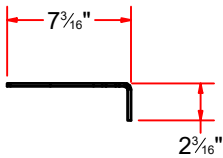

DETAIL A

FLAT PATTERN
Plate #3/16" x 9" x 34 3/8" LG.



AVW EQUIPMENT CO., INC.
105 S. 9TH AVENUE
MAYWOOD, IL 60153
Tel: 708-343-7738 Fax: 708-343-9065
WWW.AVWEQUIPMENT.COM

- COMPANY PROPRIETARY NOTE -
THIS DRAWING AND ITS DESIGNS ARE PROPERTY OF AVW EQUIPMENT CO. &
IT IS NOT TO BE USED OR REPRODUCED WITHOUT THE PERMISSION FROM AVW CO.

DRAWN BY	Darpan	CUSTOMER: AVW EQUIPMENT CO.	
CHECKED BY		PROJECT: PSH25 - SINGLE PUMPING STATION	
QTY		DESCRIPTION: Plate #3/16" x 9" x 34 3/8" LG.	
RELEASE DATE	6/16/2021	PART NUMBER: PSH25AC	REV#
DIMENSION ARE IN INCHES & PROVIDED PRIOR TO SURFACE TREATMENTS, UNLESS NOTED.		SIZE A	EST WEIGHT:
			SHEET 8 of 23

PARTS FOR PSH25-A SINGLE PUMPING STATION STAND

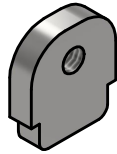

ITEM 7

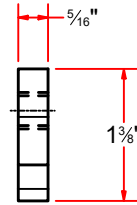
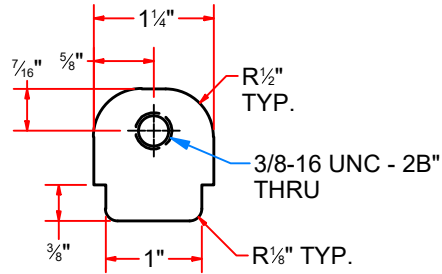
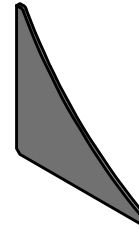
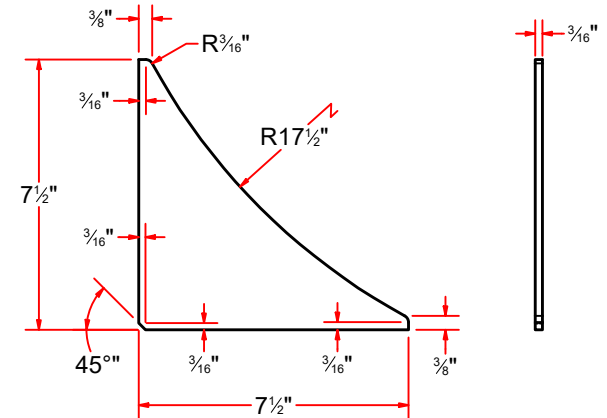

Plate #5/16" x 1 1/4" x 1 3/8" LG.



ITEM 9



Gusset #3/16" x 7 1/2" x 7 1/2"

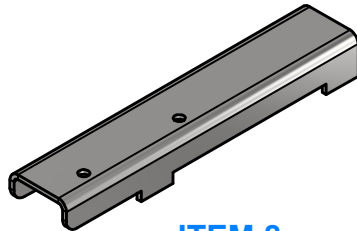

ITEM 8

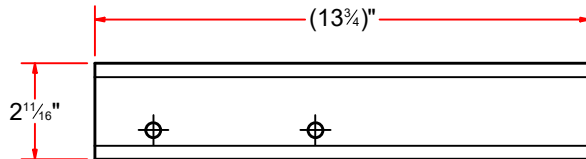

FORMED

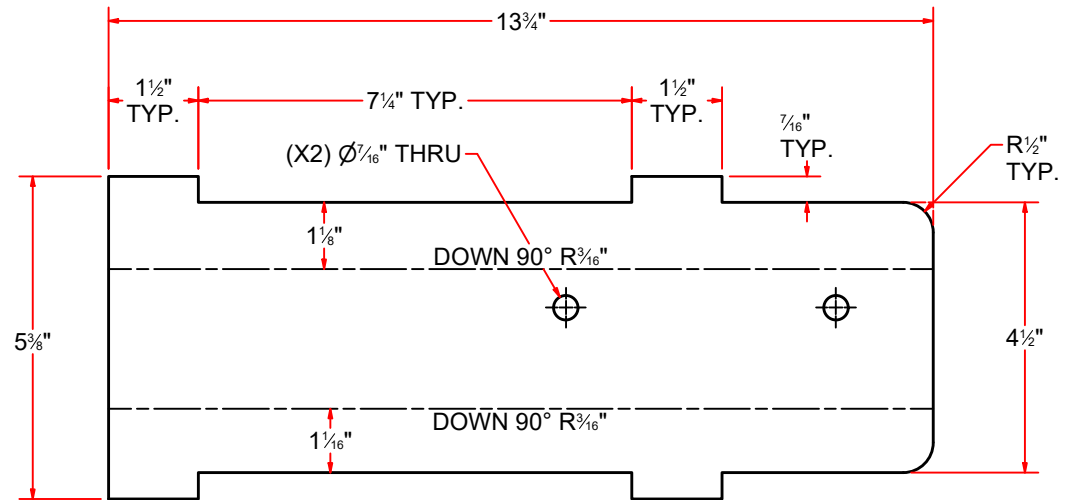
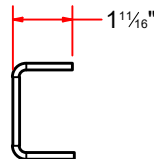

FLAT PATTERN

Plate #3/16" x 5 3/8" x 13 3/4" LG.



AVW EQUIPMENT CO., INC.
105 S. 9TH AVENUE
MAYWOOD, IL 60153
Tel: 708-343-7738 Fax: 708-343-9065
WWW.AVWEQUIPMENT.COM

- COMPANY PROPRIETARY NOTE -

THIS DRAWING AND ITS DESIGNS ARE PROPERTY OF AVW EQUIPMENT CO. & IT IS NOT TO BE USED OR REPRODUCED WITHOUT THE PERMISSION FROM AVW CO.

DRAWN BY

Darpan

CUSTOMER: AVW EQUIPMENT CO.

CHECKED BY

PROJECT: PSH25 - SINGLE PUMPING STATION

QTY

DESCRIPTION: Plate #5/16" x 1 1/4" x 1 3/8" LG.

RELEASE DATE

6/16/2021

PART NUMBER: PSH25AD

REV#

DIMENSION ARE IN INCHES & PROVIDED PRIOR TO SURFACE TREATMENTS, UNLESS NOTED.

SIZE A

EST WEIGHT:

SHEET 9 of 23

PS2H25AJ - STAND TOP 22 1/2" x 38 1/2" LG.

H25SPSFT - STAND TOP		
ITEM	QTY	DESCRIPTION
1	2	Angle #12Ga 1 1/2" x 1 1/2" x 38 1/2" LG.
2	2	Angle #12Ga 1 1/2" x 1 1/2" x 22 1/2" LG.

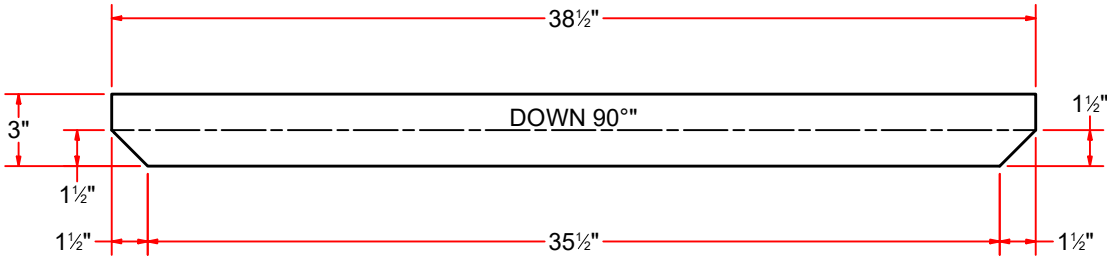
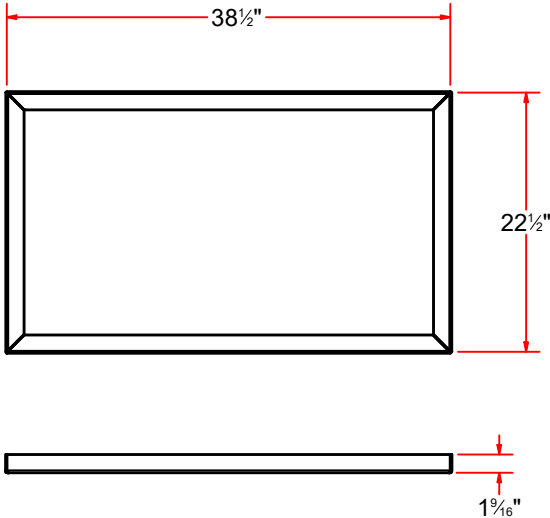
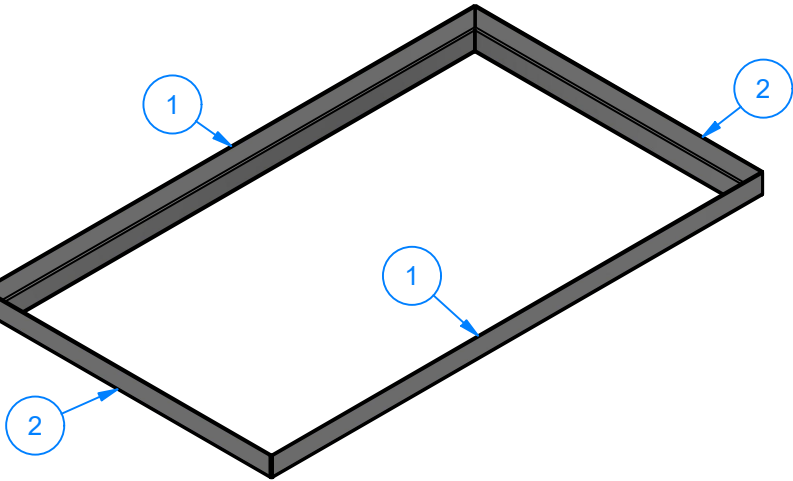

Angle #12Ga 1 1/2" x 1 1/2" x 38 1/2" LG.

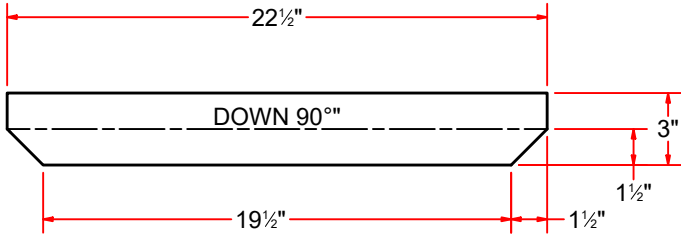

Angle #12Ga 1 1/2" x 1 1/2" x 22 1/2" LG.



AVW EQUIPMENT CO., INC.
105 S. 9TH AVENUE
MAYWOOD, IL 60153
Tel: 708-343-7738 Fax: 708-343-9065
WWW.AVWEQUIPMENT.COM

- COMPANY PROPRIETARY NOTE -
THIS DRAWING AND ITS DESIGNS ARE PROPERTY OF AVW EQUIPMENT CO. &
IT IS NOT TO BE USED OR REPRODUCED WITHOUT THE PERMISSION FROM AVW CO.

DRAWN BY	Darpan	CUSTOMER: AVW EQUIPMENT CO.	
CHECKED BY		PROJECT: PSH25 - SINGLE PUMPING STATION	
QTY		DESCRIPTION: STAND TOP 22 1/2" x 38 1/2" LG.	
RELEASE DATE	6/16/2021	PART NUMBER: PS2H25AJ	REV#
DIMENSION ARE IN INCHES & PROVIDED PRIOR TO SURFACE TREATMENTS, UNLESS NOTED.		SIZE A	EST WEIGHT: 7 lbmass
			SHEET 10 of 23

PSH25V - Single Pumping Station Lid Assembly

Parts List		
ITEM	QTY	DESCRIPTION
1	1	LID FRAME ASSEMBLY
2	1	Lid -#18Ga (38 x 22)
3	2	HIN - Hinge
4	1	Rod R3/8" x 4"
5	1	Rod D1/4" x 15"
6	2	Sheet Metal #12Ga x 1" x 1"
7	1	

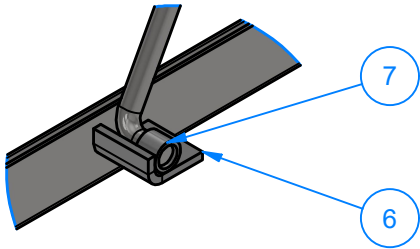
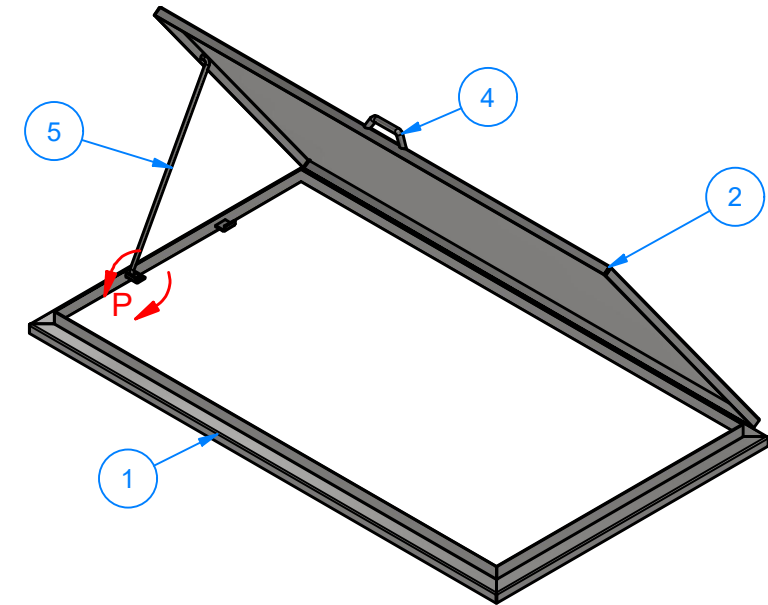

DETAIL P

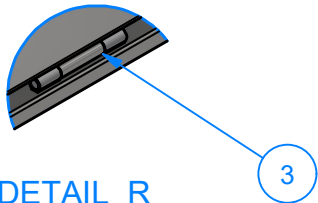

DETAIL R

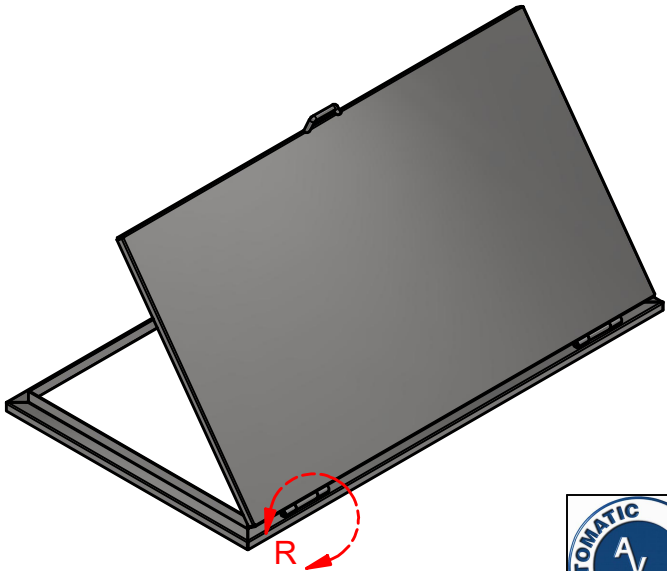

AVW EQUIPMENT CO., INC.
105 S. 9TH AVENUE
MAYWOOD, IL 60153
Tel: 708-343-7738 Fax: 708-343-9065
WWW.AVWEQUIPMENT.COM

- COMPANY PROPRIETARY NOTE -
THIS DRAWING AND ITS DESIGNS ARE PROPERTY OF AVW EQUIPMENT CO. &
IT IS NOT TO BE USED OR REPRODUCED WITHOUT THE PERMISSION FROM AVW CO.

DRAWN BY	Darpan	CUSTOMER: AVW EQUIPMENT CO.	
CHECKED BY		PROJECT: PSH25 - SINGLE PUMPING STATION	
QTY		DESCRIPTION: Single Pumping Station Lid Assembly	
RELEASE DATE	6/16/2021	PART NUMBER: PSH25V	REV#
DIMENSION ARE IN INCHES & PROVIDED PRIOR TO SURFACE TREATMENTS, UNLESS NOTED.		SIZE A	EST WEIGHT: 16 lbmass
			SHEET 11 of 23

PSH25VA - LID FRAME ASSEMBLY

Parts List		
ITEM	QTY	DESCRIPTION
1	2	Lid Frame Long Side - #18 Ga (38 3/16")
2	2	Lid Frame Short Side - #18Ga (22 3/16")

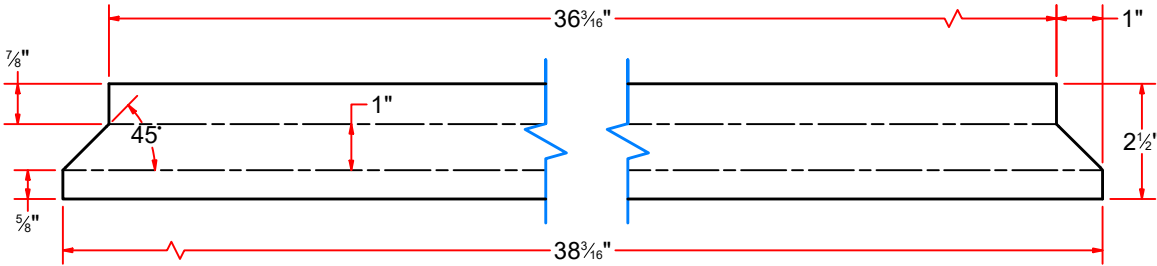
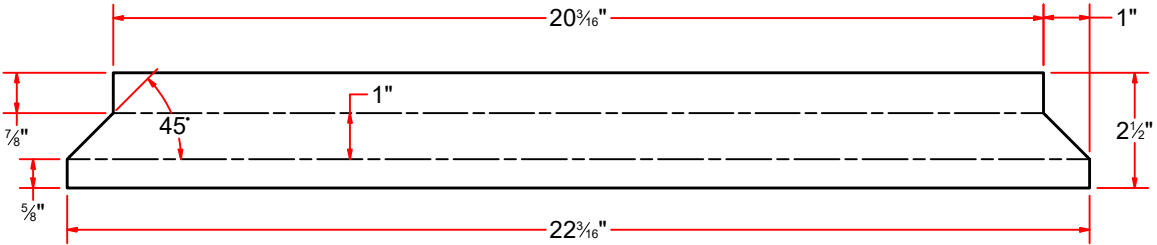
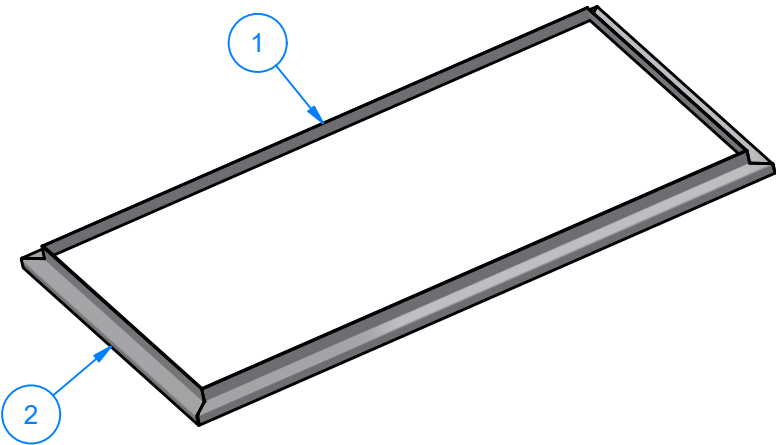

AVW EQUIPMENT CO., INC.
105 S. 9TH AVENUE
MAYWOOD, IL 60153
Tel: 708-343-7738 Fax: 708-343-9065
WWW.AVWEQUIPMENT.COM

- COMPANY PROPRIETARY NOTE -
THIS DRAWING AND ITS DESIGNS ARE PROPERTY OF AVW EQUIPMENT CO. &
IT IS NOT TO BE USED OR REPRODUCED WITHOUT THE PERMISSION FROM AVW CO.

DRAWN BY	Darpan	CUSTOMER: AVW EQUIPMENT CO.	
CHECKED BY		PROJECT: PSH25 - SINGLE PUMPING STATION	
QTY		DESCRIPTION: LID FRAME ASSEMBLY	
RELEASE DATE	6/16/2021	PART NUMBER: PSH25VA	REV#
DIMENSION ARE IN INCHES & PROVIDED PRIOR TO SURFACE TREATMENTS, UNLESS NOTED.		SIZE A EST WEIGHT: 4 lbmass	SHEET 12 of 23

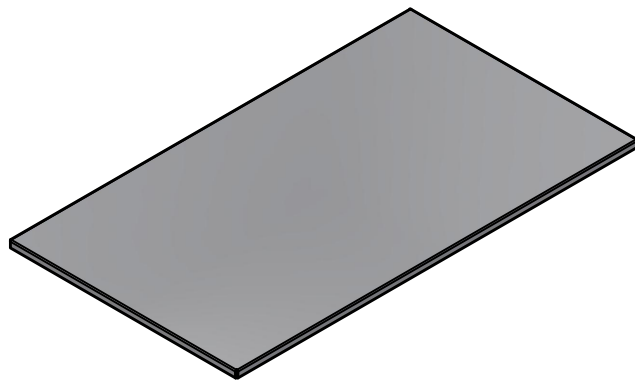

Lid -#18Ga (38 x 22)

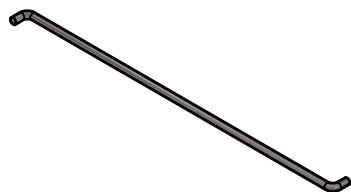
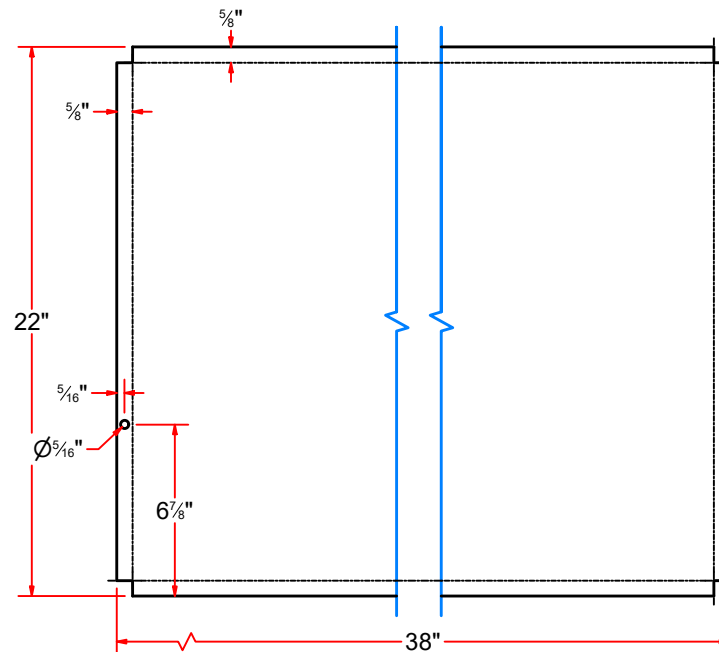

Rod D1/4" x 15"

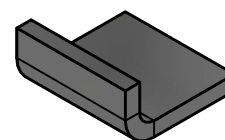
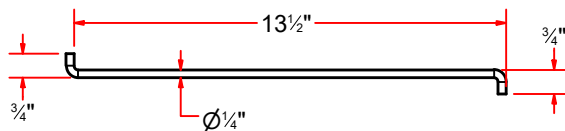

Sheet Metal #12Ga x 1" x 1"

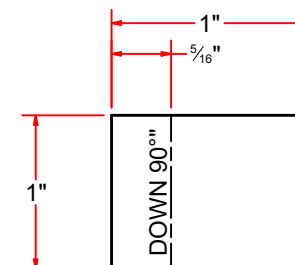

[VIEW112](#)



AVW EQUIPMENT CO., INC.
105 S. 9TH AVENUE
MAYWOOD, IL 60153
Tel: 708-343-7738 Fax: 708-343-9065
WWW.AVWEQUIPMENT.COM

- COMPANY PROPRIETARY NOTE -

THIS DRAWING AND ITS DESIGNS ARE PROPERTY OF AVW EQUIPMENT CO. & IT IS NOT TO BE USED OR REPRODUCED WITHOUT THE PERMISSION FROM AVW CO.

DRAWN BY

Darpan

CUSTOMER: AVW EQUIPMENT CO.

CHECKED BY

PROJECT: PSH25 - SINGLE PUMPING STATION

QTY

DESCRIPTION: Lid -#18Ga (38 x 22)

RELEASE DATE

6/16/2021

PART NUMBER: PSH25VB

REV#

DIMENSION ARE IN INCHES & PROVIDED PRIOR TO SURFACE TREATMENTS, UNLESS NOTED.

SIZE
A

EST WEIGHT:

SHEET 13 of 23

PATH:L:\Designs\Product Lines\Pumping Stations\H25\PS2H25 - Double Pumping Station - w revised tank\Parts\Lid -#18Ga(38 x 22).ipt

PSH25T - Single Pumping Station Tank

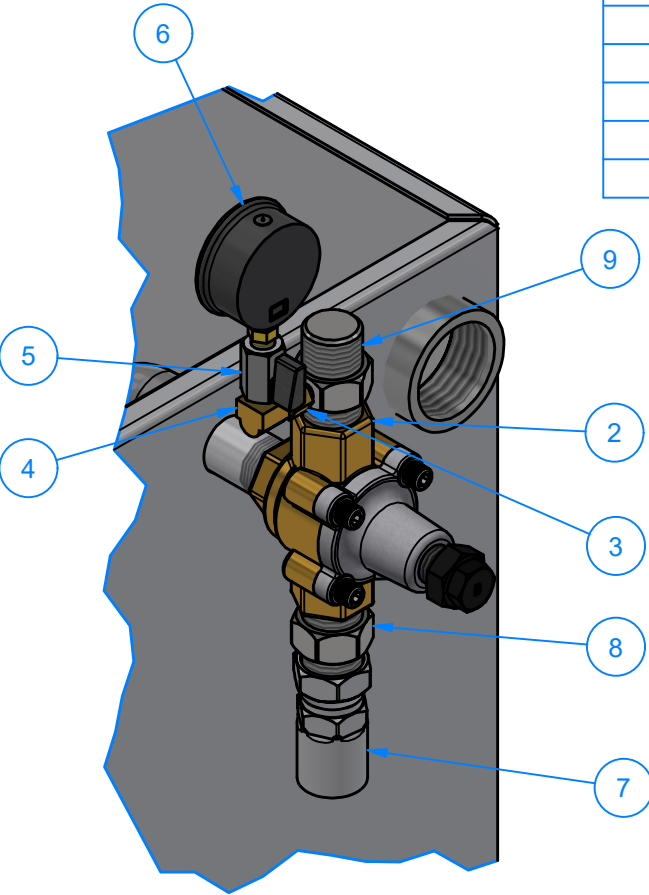
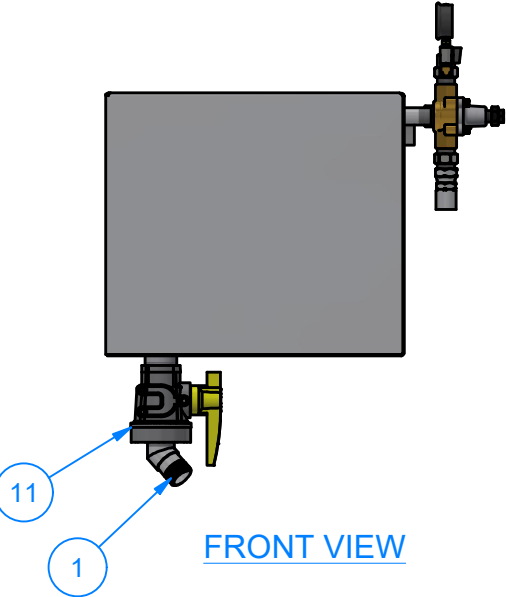
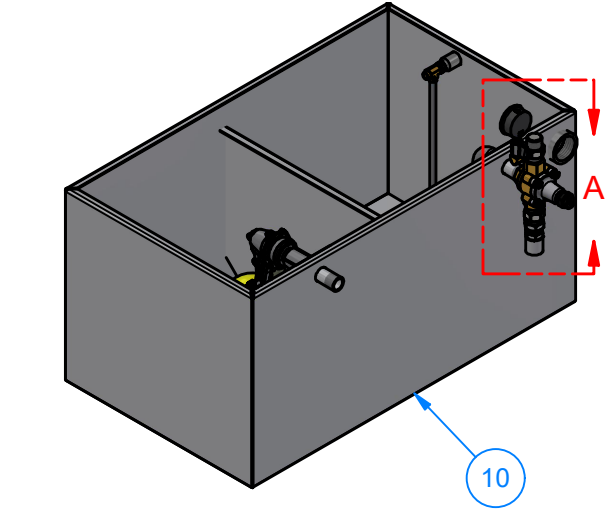

DETAIL A

TANK ASSEMBLY - COMPLETE W/ PRESS REG VALVE		
ITEM	QTY	DESCRIPTION
1	1	Angle Hose Barb 2" X 1-1/2" NPTM
2	1	Pressure Regulation valve C23
3	1	Adapter 1/4"
4	1	Street Elbow 1/4"
5	1	Needle Valve 1/4"
6	1	Manometer
7	1	Crimp Fitting: 1" x 1", Female
8	1	1" JIC Adapter Straight
9	1	1" JIC Adapter Straight (with hole)
10	1	Single Pumping Station Tank Assembly
11	1	Plastic Ball Valve 2" NPT x 2" NPT



AVW EQUIPMENT CO., INC.
105 S. 9TH AVENUE
MAYWOOD, IL 60153
Tel: 708-343-7738 Fax: 708-343-9065
WWW.AVWEQUIPMENT.COM

- COMPANY PROPRIETARY NOTE -
THIS DRAWING AND ITS DESIGNS ARE PROPERTY OF AVW EQUIPMENT CO. &
IT IS NOT TO BE USED OR REPRODUCED WITHOUT THE PERMISSION FROM AVW CO.

DRAWN BY	Darpan	CUSTOMER: AVW EQUIPMENT CO.	
CHECKED BY		PROJECT: PSH25 - SINGLE PUMPING STATION	
QTY		DESCRIPTION: Single Pumping Station Tank	
RELEASE DATE	6/16/2021	PART NUMBER: PSH25T	REV#
DIMENSION ARE IN INCHES & PROVIDED PRIOR TO SURFACE TREATMENTS, UNLESS NOTED.		SIZE A	EST WEIGHT: 121 lbmass
			SHEET 14 of 23

PSH25TA - Single Pumping Station Tank Assembly

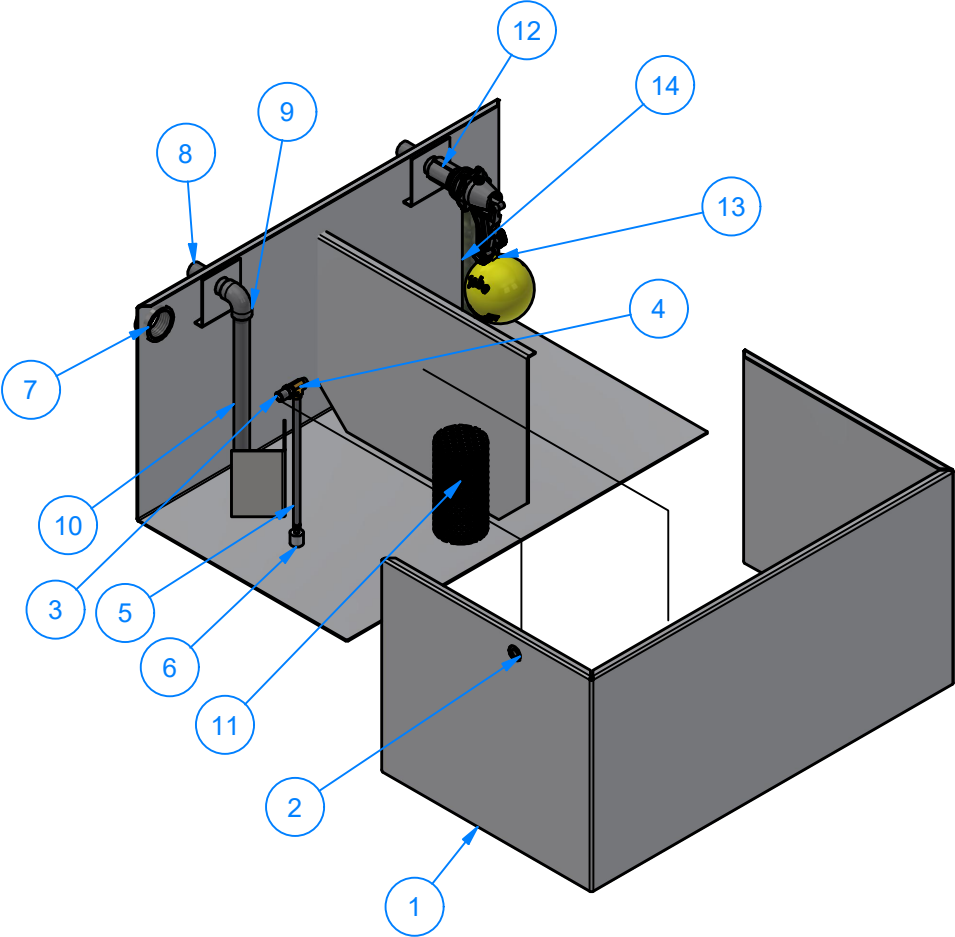

Parts List		
ITEM	QTY	DESCRIPTION
1	1	Single Pumping Station Tank Sheet Metal
2	1	1/2" Full Coupling
3	1	Adapter Reducer - 1/2" M-NPT x 1/4" F-NPT
4	1	1/2" male - female - female tee
5	1	1/4" x 12" Nipple
6	1	1/4" x 12" Nipple
7	1	2" Half Coupling
8	2	Nipple - 1" NPT x 4" LG
9	1	1" Elbow
10	1	1" PVC Pipe
11	1	Hydraulic Suction Strainer H25
12	1	1" Pipe Coupling
13	1	Topaz Floating Valve
14	1	1" Hose

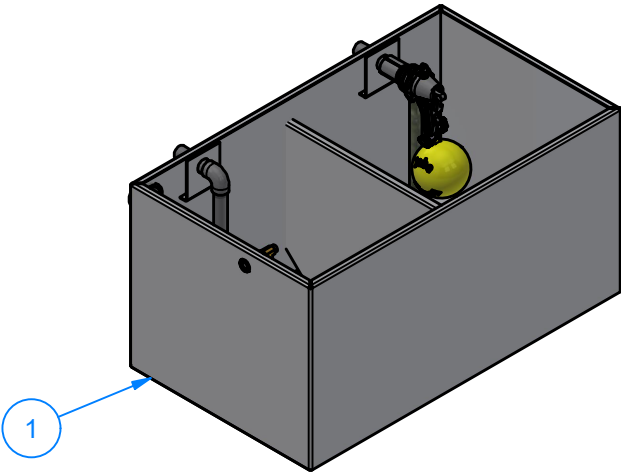

AVW EQUIPMENT CO., INC.
105 S. 9TH AVENUE
MAYWOOD, IL 60153
Tel: 708-343-7738 Fax: 708-343-9065
WWW.AVWEQUIPMENT.COM

- COMPANY PROPRIETARY NOTE -
THIS DRAWING AND ITS DESIGNS ARE PROPERTY OF AVW EQUIPMENT CO. &
IT IS NOT TO BE USED OR REPRODUCED WITHOUT THE PERMISSION FROM AVW CO.

DRAWN BY	Darpan	CUSTOMER: AVW EQUIPMENT CO.	
CHECKED BY		PROJECT: PSH25 - SINGLE PUMPING STATION	
QTY		DESCRIPTION: Single Pumping Station Tank Assembly	
RELEASE DATE	6/16/2021	PART NUMBER: PSH25TA	REV#
DIMENSION ARE IN INCHES & PROVIDED PRIOR TO SURFACE TREATMENTS, UNLESS NOTED.		SIZE A	EST WEIGHT: 117 lbmass
			SHEET 15 of 23

PSH25TAA - Single Pumping Station Tank Sheet Metal

Parts List		
ITEM	QTY	DESCRIPTION
1	1	Tank Front -#12Ga(82 x 20)
2	1	Tank Back -#12Ga(42 x 38)
3	1	Baffle #12Ga (0.1046 in) x 17" x 22" LG.
4	2	5 x 4 -#12Ga
5	1	SS Sheet Metal #12Ga (0.1046 in) x 6" x 7 13/16" LG.

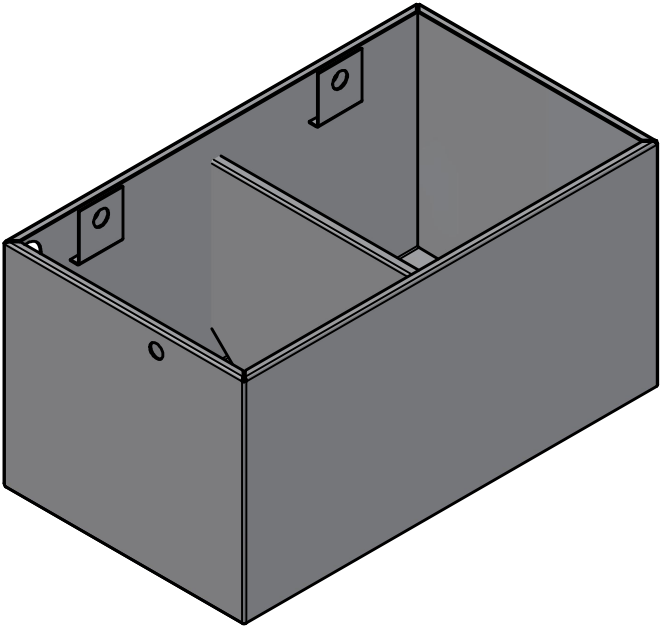
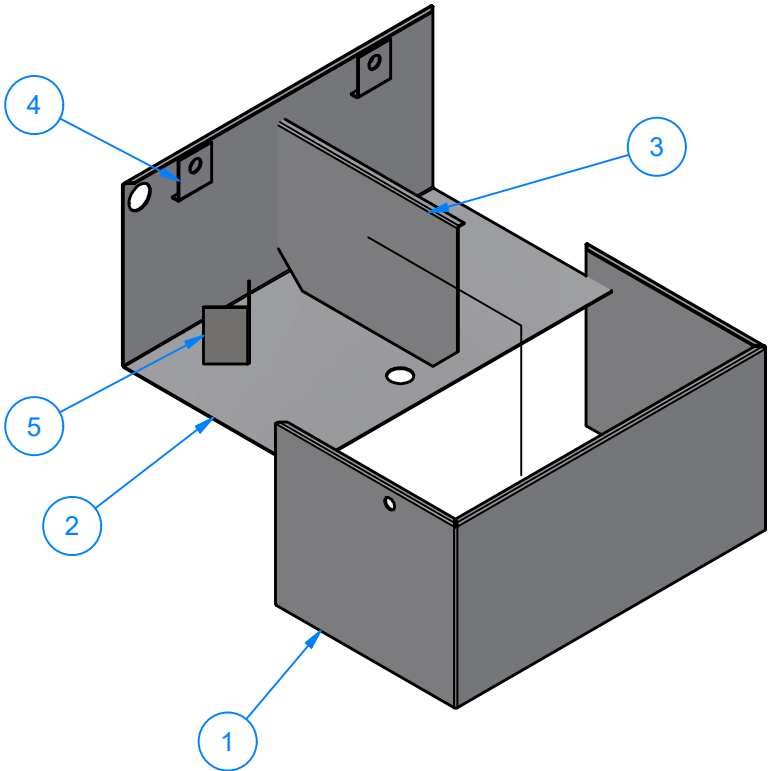

AVW EQUIPMENT CO., INC.
105 S. 9TH AVENUE
MAYWOOD, IL 60153
Tel: 708-343-7738 Fax: 708-343-9065
WWW.AVWEQUIPMENT.COM

- COMPANY PROPRIETARY NOTE -
THIS DRAWING AND ITS DESIGNS ARE PROPERTY OF AVW EQUIPMENT CO. &
IT IS NOT TO BE USED OR REPRODUCED WITHOUT THE PERMISSION FROM AVW CO.

DRAWN BY	Darpan	CUSTOMER: AVW EQUIPMENT CO.	
CHECKED BY		PROJECT: PSH25 - SINGLE PUMPING STATION	
QTY		DESCRIPTION: Single Pumping Station Tank Sheet Metal	
RELEASE DATE	6/16/2021	PART NUMBER: PSH25TAA	REV#
DIMENSION ARE IN INCHES & PROVIDED PRIOR TO SURFACE TREATMENTS, UNLESS NOTED.		SIZE A	EST WEIGHT: 111 lbmass
			SHEET 16 of 23

PSH25TAA - Single Pumping Station Tank Sheet Metal

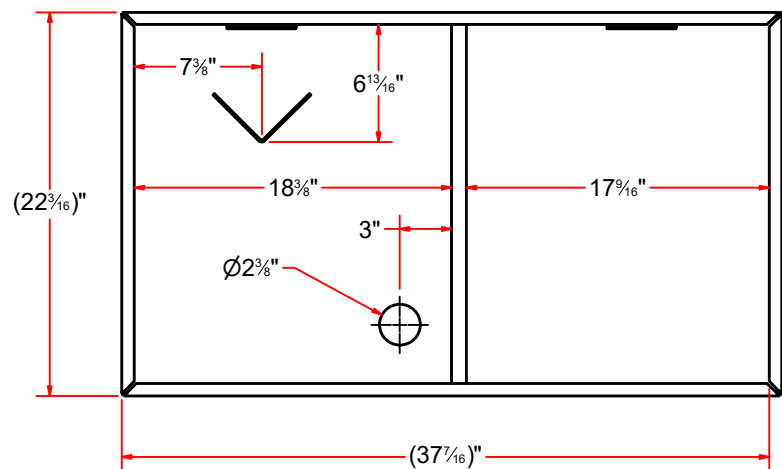

TOP VIEW

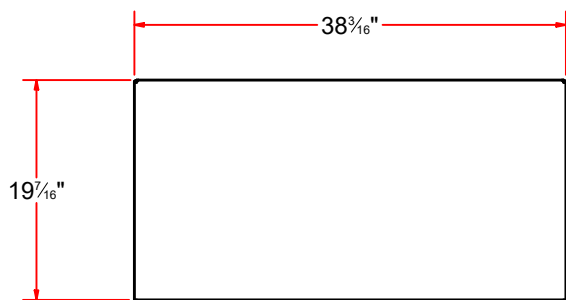

FRONT VIEW

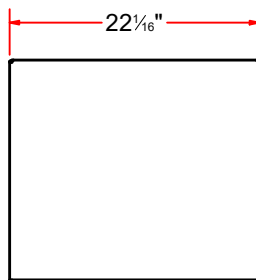

SIDE VIEW

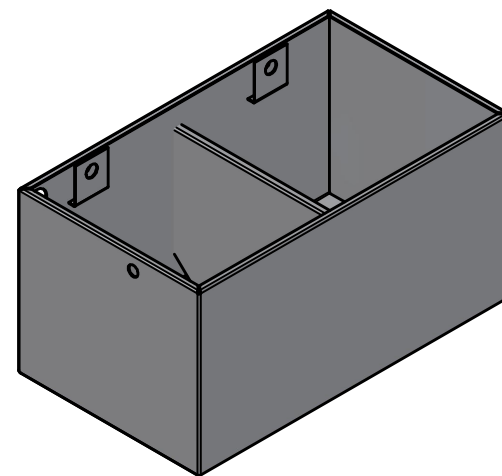

AVW EQUIPMENT CO., INC.
105 S. 9TH AVENUE
MAYWOOD, IL 60153
Tel: 708-343-7738 Fax: 708-343-9065
WWW.AVWEQUIPMENT.COM

- COMPANY PROPRIETARY NOTE -
THIS DRAWING AND ITS DESIGNS ARE PROPERTY OF AVW EQUIPMENT CO. &
IT IS NOT TO BE USED OR REPRODUCED WITHOUT THE PERMISSION FROM AVW CO.

DRAWN BY

Darpan

CUSTOMER: AVW EQUIPMENT CO.

CHECKED BY

PROJECT: PSH25 - SINGLE PUMPING STATION

QTY

DESCRIPTION: Single Pumping Station Tank Sheet Metal

RELEASE
DATE

6/16/2021

PART NUMBER: PSH25TAA

REV#

DIMENSION ARE IN INCHES & PROVIDED PRIOR
TO SURFACE TREATMENTS, UNLESS NOTED.

SIZE
A

EST WEIGHT: 111 lbmass

SHEET 17 of 23

PATH:L:\Designs\Product Lines\Pumping Stations\H25\PSH25 - Single Pumping Station - w revised tank\Parts\H25SPST - H25 Single Pumping Station Tank\Parts\H25SPST-00.iam

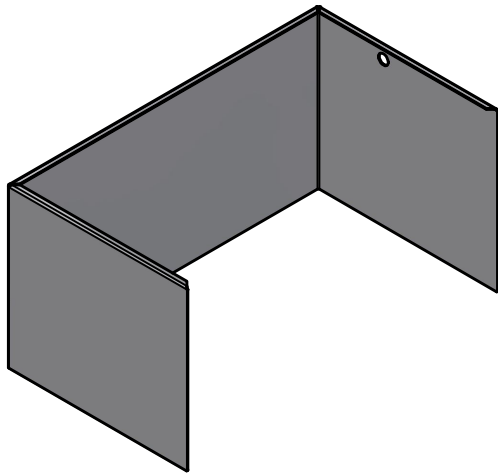

Tank Front -#12Ga(82 x 20)

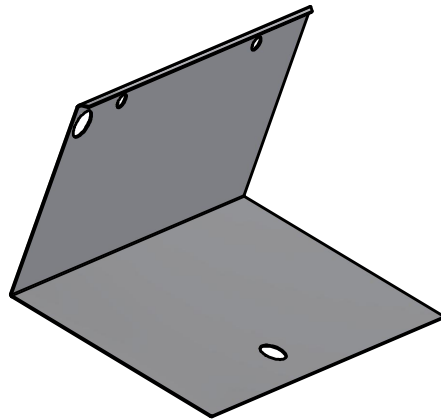

Tank Back -#12Ga(42 x 38)

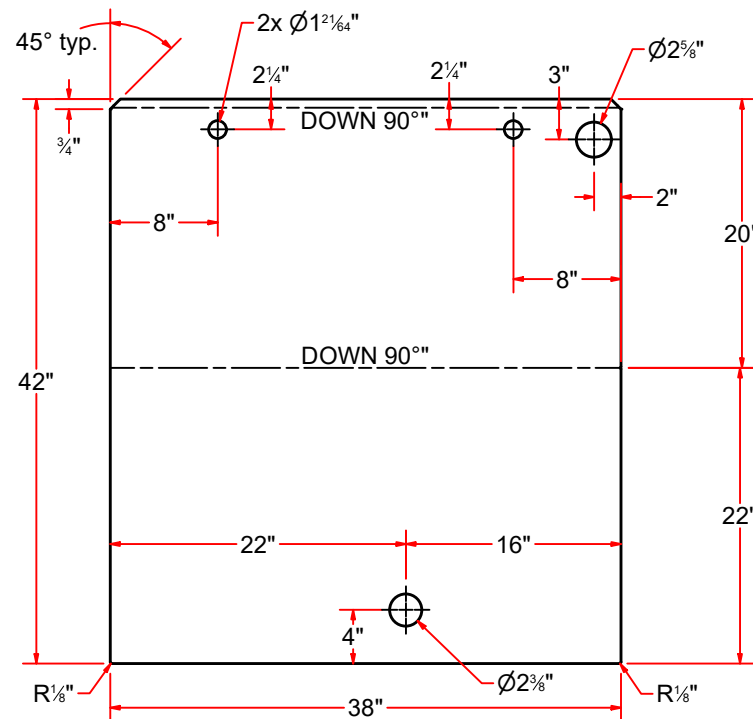
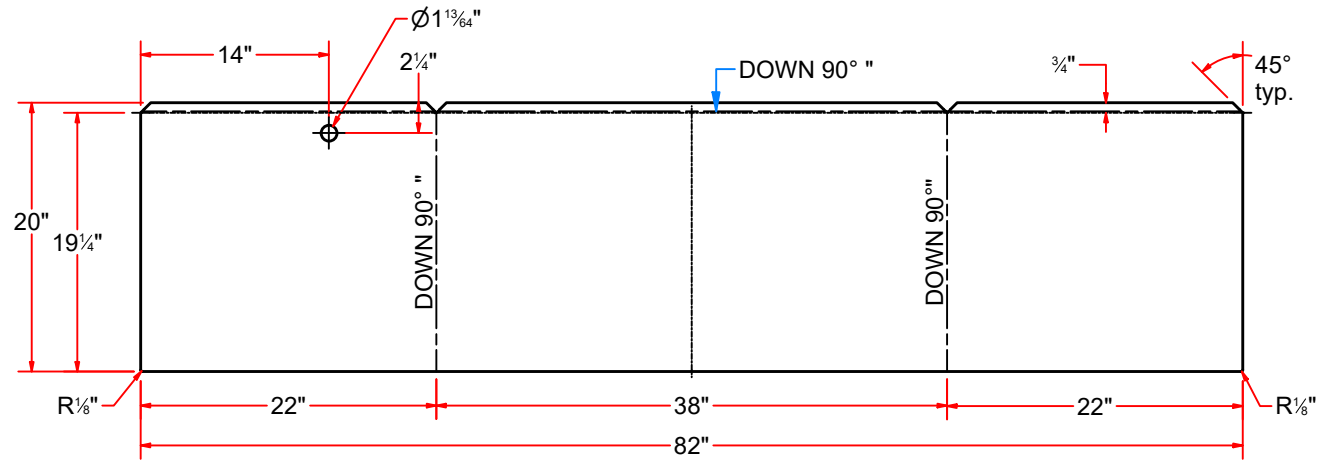

AVW EQUIPMENT CO., INC.
105 S. 9TH AVENUE
MAYWOOD, IL 60153
Tel: 708-343-7738 Fax: 708-343-9065
WWW.AVWEQUIPMENT.COM

- COMPANY PROPRIETARY NOTE -

THIS DRAWING AND ITS DESIGNS ARE PROPERTY OF AVW EQUIPMENT CO. & IT IS NOT TO BE USED OR REPRODUCED WITHOUT THE PERMISSION FROM AVW CO.

DRAWN BY

Darpan

CUSTOMER: AVW EQUIPMENT CO.

CHECKED BY

PROJECT: PSH25 - SINGLE PUMPING STATION

QTY

DESCRIPTION: Tank Front -#12Ga(82 x 20)

RELEASE DATE

6/16/2021

PART NUMBER: PSH25TAAB

REV#

DIMENSION ARE IN INCHES & PROVIDED PRIOR TO SURFACE TREATMENTS, UNLESS NOTED.

SIZE
A

EST WEIGHT:

SHEET 18 of 23

Baffle #12Ga (0.1046 in) x 17" x 22" LG.

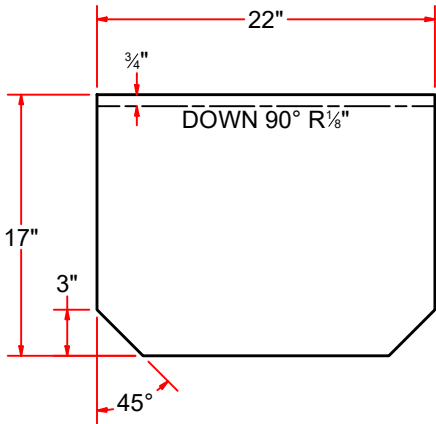
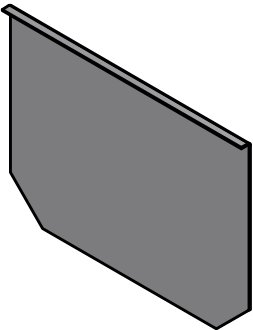

SS Sheet Metal #12Ga (0.1046 in) x 6" x 7 13/16" LG.

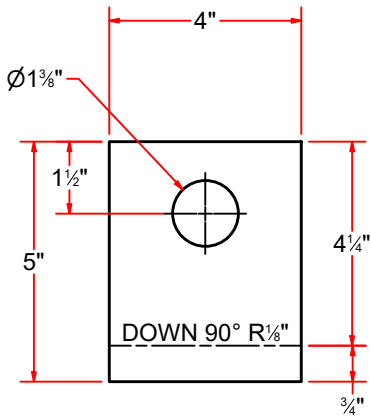
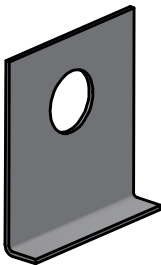
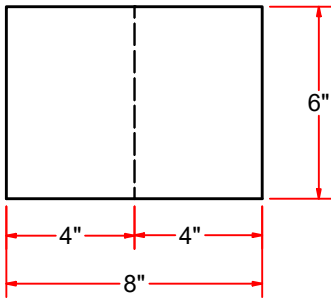
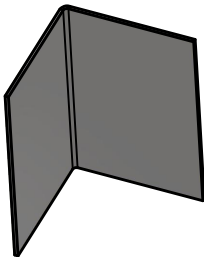

5 x 4 -#12Ga



AVW EQUIPMENT CO., INC.
105 S. 9TH AVENUE
MAYWOOD, IL 60153
Tel: 708-343-7738 Fax: 708-343-9065
WWW.AVWEQUIPMENT.COM

- COMPANY PROPRIETARY NOTE -
THIS DRAWING AND ITS DESIGNS ARE PROPERTY OF AVW EQUIPMENT CO. &
IT IS NOT TO BE USED OR REPRODUCED WITHOUT THE PERMISSION FROM AVW CO.

DRAWN BY	Darpan	CUSTOMER: AVW EQUIPMENT CO.	
CHECKED BY		PROJECT: PSH25 - SINGLE PUMPING STATION	
QTY		DESCRIPTION: Baffle #12Ga (0.1046 in) x 17" x 22" LG.	
RELEASE DATE	6/16/2021	PART NUMBER: PSH25TAAD	REV#
DIMENSION ARE IN INCHES & PROVIDED PRIOR TO SURFACE TREATMENTS, UNLESS NOTED.		SIZE A	EST WEIGHT:
			SHEET 19 of 23

PSH25PC - H25 MOTOR BELT GUARD

Parts List		
ITEM	QTY	DESCRIPTION
1	1	SS Sheet Metal #12Ga (0.1046 in) x 18 7/16" x 28 5/8" LG.
2	1	SS Sheet Metal #12Ga (0.1046 in) x 4" x 17 1/16" LG.
3	1	SS Sheet Metal #12Ga (0.1046 in) x 4" x 12 15/16" LG.
4	1	SS Sheet Metal #12Ga (0.1046 in) x 1 1/2" x 3 13/16" LG.
5	1	SS Sheet Metal #12Ga (0.1046 in) x 1 1/2" x 5 5/8" LG.

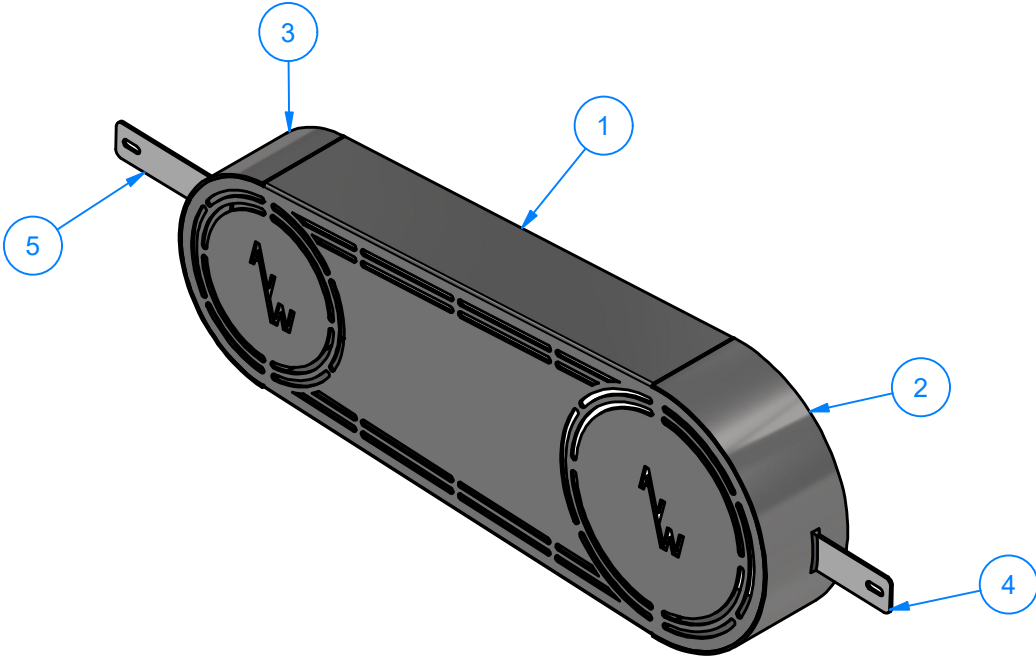

AVW EQUIPMENT CO., INC.
105 S. 9TH AVENUE
MAYWOOD, IL 60153
Tel: 708-343-7738 Fax: 708-343-9065
WWW.AVWEQUIPMENT.COM

- COMPANY PROPRIETARY NOTE -
THIS DRAWING AND ITS DESIGNS ARE PROPERTY OF AVW EQUIPMENT CO. &
IT IS NOT TO BE USED OR REPRODUCED WITHOUT THE PERMISSION FROM AVW CO.

DRAWN BY	Darpan	CUSTOMER: AVW EQUIPMENT CO.	
CHECKED BY		PROJECT: PSH25 - SINGLE PUMPING STATION	
QTY		DESCRIPTION: H25 MOTOR BELT GUARD	
RELEASE DATE	6/16/2021	PART NUMBER: PSH25PC	REV#
DIMENSION ARE IN INCHES & PROVIDED PRIOR TO SURFACE TREATMENTS, UNLESS NOTED.		SIZE A	EST WEIGHT: 15 lbmass
			SHEET 20 of 23

PATH:L:\Libraries\AVW Components\Motor Belt Guards\Pumping Stations\H25\PSH25MBG.iam

SS Sheet Metal #12Ga (0.1046 in) x 18 7/16" x 28 5/8" LG.

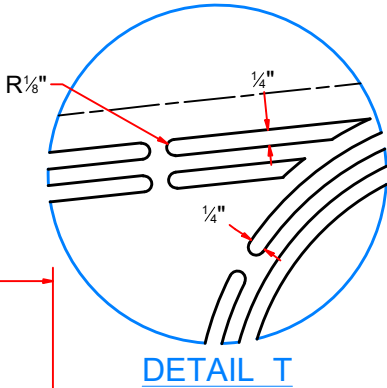
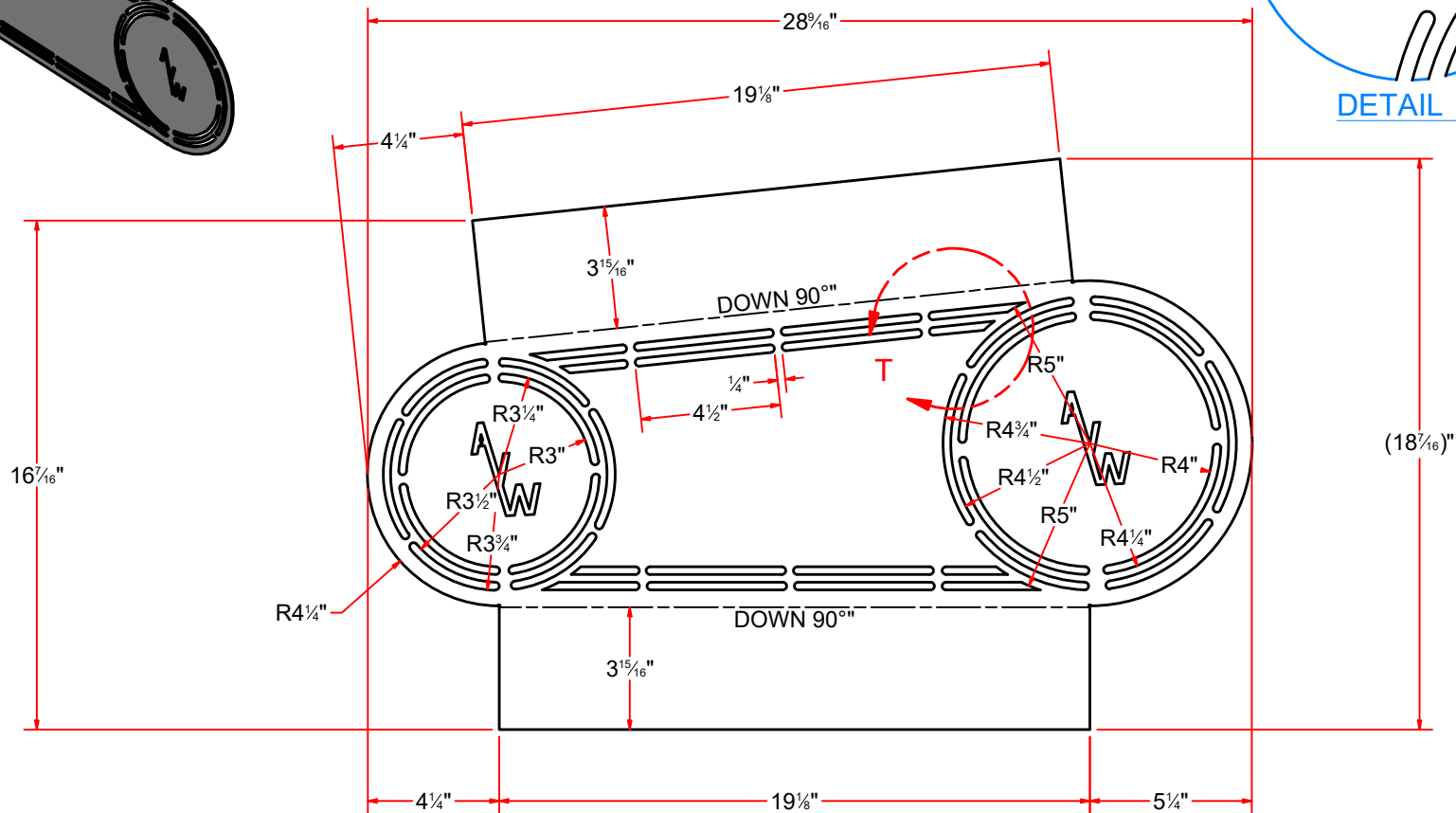
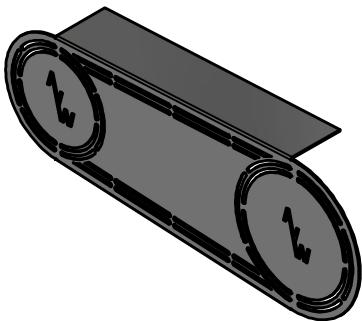

AVW EQUIPMENT CO., INC.
105 S. 9TH AVENUE
MAYWOOD, IL 60153
Tel: 708-343-7738 Fax: 708-343-9065
WWW.AVWEQUIPMENT.COM

- COMPANY PROPRIETARY NOTE -
THIS DRAWING AND ITS DESIGNS ARE PROPERTY OF AVW EQUIPMENT CO. &
IT IS NOT TO BE USED OR REPRODUCED WITHOUT THE PERMISSION FROM AVW CO.

DRAWN BY	Darpan	CUSTOMER: AVW EQUIPMENT CO.	
CHECKED BY		PROJECT: PSH25 - SINGLE PUMPING STATION	
QTY		DESCRIPTION: SS Sheet Metal #12Ga (0.1046 in) x 18 7/16" x 28 5/8" LG.	
RELEASE DATE	6/16/2021	PART NUMBER: PSH25PCA	REV#
DIMENSION ARE IN INCHES & PROVIDED PRIOR TO SURFACE TREATMENTS, UNLESS NOTED.		SIZE A	EST WEIGHT:
			SHEET 21 of 23

PATH:L:\Libraries\AVW Components\Motor Belt Guards\Pumping Stations\H25\Parts\PSH25MBG-01.ipt

SS Sheet Metal #12Ga (0.1046 in) x 1 1/2" x 5 5/8" LG.

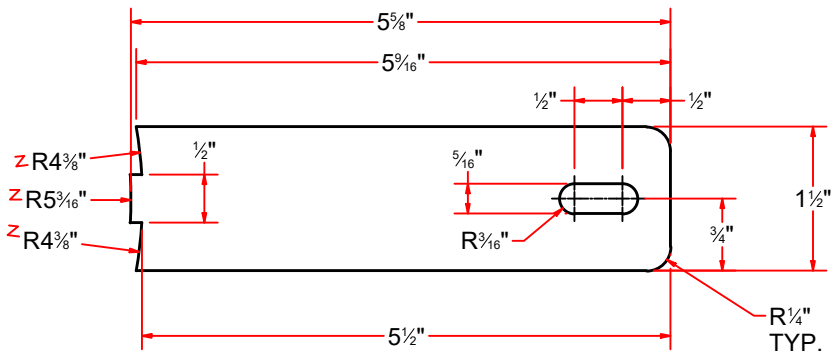
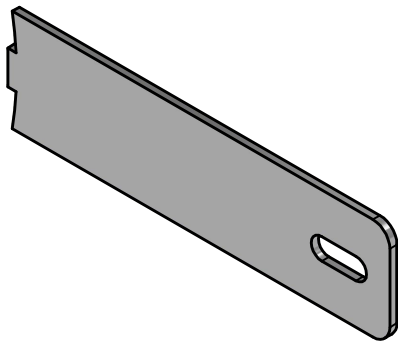

SS Sheet Metal #12Ga (0.1046 in) x 1 1/2" x 3 13/16" LG.

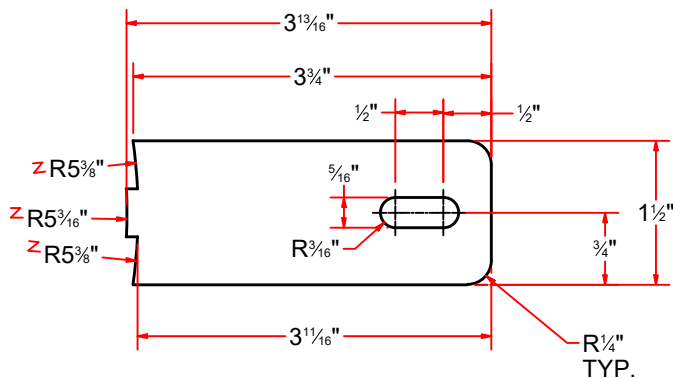
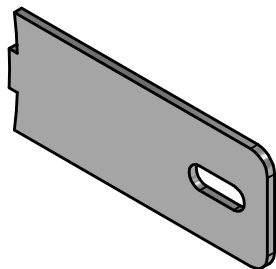

AVW EQUIPMENT CO., INC.
105 S. 9TH AVENUE
MAYWOOD, IL 60153
Tel: 708-343-7738 Fax: 708-343-9065
WWW.AVWEQUIPMENT.COM

- COMPANY PROPRIETARY NOTE -
THIS DRAWING AND ITS DESIGNS ARE PROPERTY OF AVW EQUIPMENT CO. &
IT IS NOT TO BE USED OR REPRODUCED WITHOUT THE PERMISSION FROM AVW CO.

DRAWN BY	Darpan	CUSTOMER: AVW EQUIPMENT CO.	
CHECKED BY		PROJECT: PSH25 - SINGLE PUMPING STATION	
QTY		DESCRIPTION: SS Sheet Metal #12Ga (0.1046 in) x 1 1/2" x 5 5/8" LG.	
RELEASE DATE	6/16/2021	PART NUMBER: PSH25PCE	REV#
DIMENSION ARE IN INCHES & PROVIDED PRIOR TO SURFACE TREATMENTS, UNLESS NOTED.		SIZE A	EST WEIGHT: SHEET 22 of 23

SS Sheet Metal #12Ga (0.1046 in) x 4" x 12 15/16" LG.

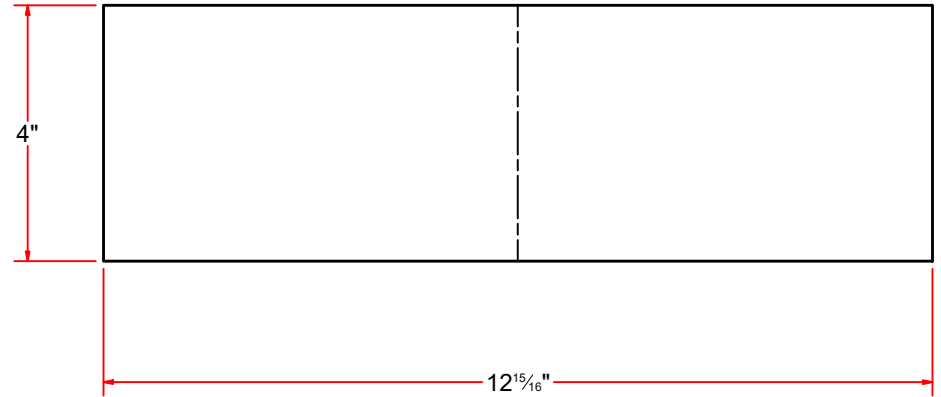
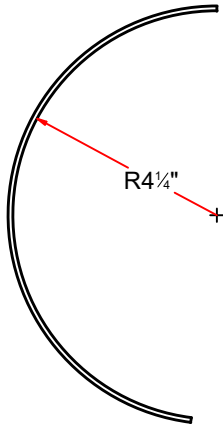
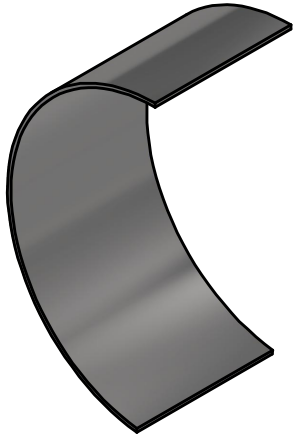

SS Sheet Metal #12Ga (0.1046 in) x 4" x 17 1/16" LG.

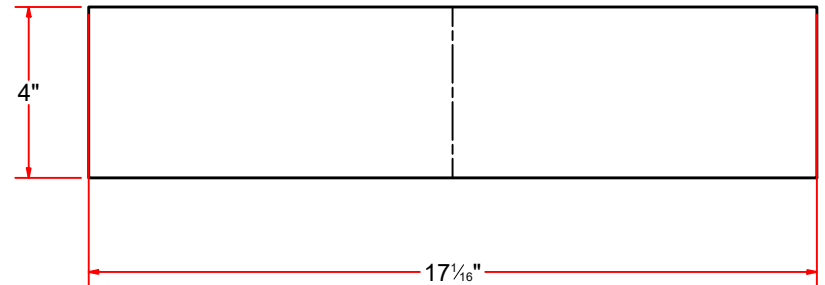
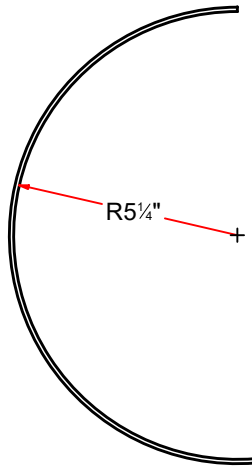
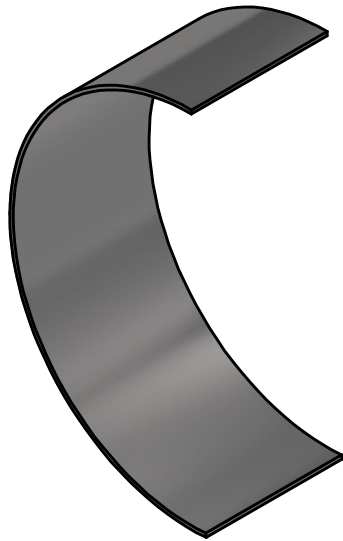

AVW EQUIPMENT CO., INC.
105 S. 9TH AVENUE
MAYWOOD, IL 60153
Tel: 708-343-7738 Fax: 708-343-9065
WWW.AVWEQUIPMENT.COM

- COMPANY PROPRIETARY NOTE -

THIS DRAWING AND ITS DESIGNS ARE PROPERTY OF AVW EQUIPMENT CO. & IT IS NOT TO BE USED OR REPRODUCED WITHOUT THE PERMISSION FROM AVW CO.

DRAWN BY

Darpan

CUSTOMER: AVW EQUIPMENT CO.

CHECKED BY

PROJECT: PSH25 - SINGLE PUMPING STATION

QTY

DESCRIPTION: SS Sheet Metal #12Ga (0.1046 in) x 4" x 12 15/16" LG.

RELEASE DATE

6/16/2021

PART NUMBER: PSH25PCC

REV#

DIMENSION ARE IN INCHES & PROVIDED PRIOR TO SURFACE TREATMENTS, UNLESS NOTED.

SIZE
A

EST WEIGHT:

SHEET 23 of 23