



Chemical Pump Panel w/ Blue-White Pump (Non-Foaming)

CPS1-B



Chemical Pump Panel w/ Blue-White Pump (Non-Foaming) - CPS1-B

The Blue-White chemical pump panel (non-foaming) is used to deliver chemicals to AVW Equipment, as well as control chemical output.

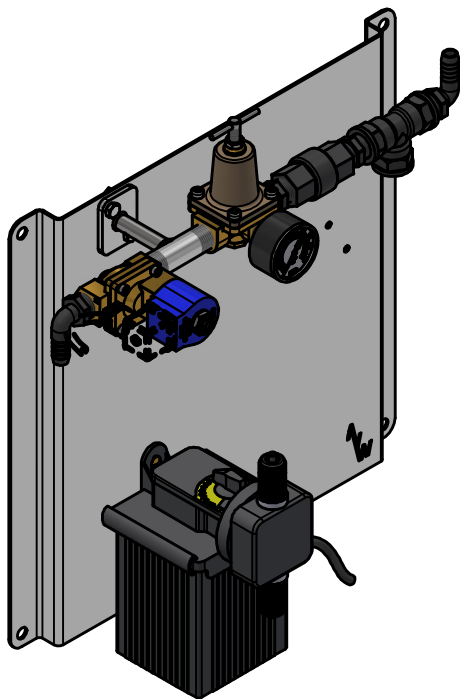



Chemical Pump Panel w/ Blue-White Pump (Non-Foaming) - CPS1-B

Parts List		
PART NUMBER	QTY	DESCRIPTION
CPS1A	1	Chemical Pump Panel Weldment
SV1-2B	1	Stand Off Bracket Assembly
CPS1B-2-7OZ115V	1	Blue-White Chem Feed Noir Pump (Non Foaming), Includes Hose and connectors
3WREG1	1	3-Way Small Water Pressure Regulator 1/4" - 1/2" NPT
AREG1-G14	1	0-160 PSI Gauge 1/4"NPT
NPLPVC050CL	2	PVC Hex Nipple 1/2" NPT
HHCS1420050	2	1/4" - 20 x 0.5" UNC Hex Screw
SLCV12-PPBLK	1	1/2" NPT Check Valve
TEEPP050	1	1/2" NPT Female Tee
BRBPP050x050	2	Barb 1/2" NPT x1/2" NPT
SRMS1032050-BR	2	10-32 x 1/2" Brass Slotted Round Head Machine Screw
SL1-2-G-120V	1	2 Way Brass Body 1/2" NPT Port, DIN Connector Solenoid

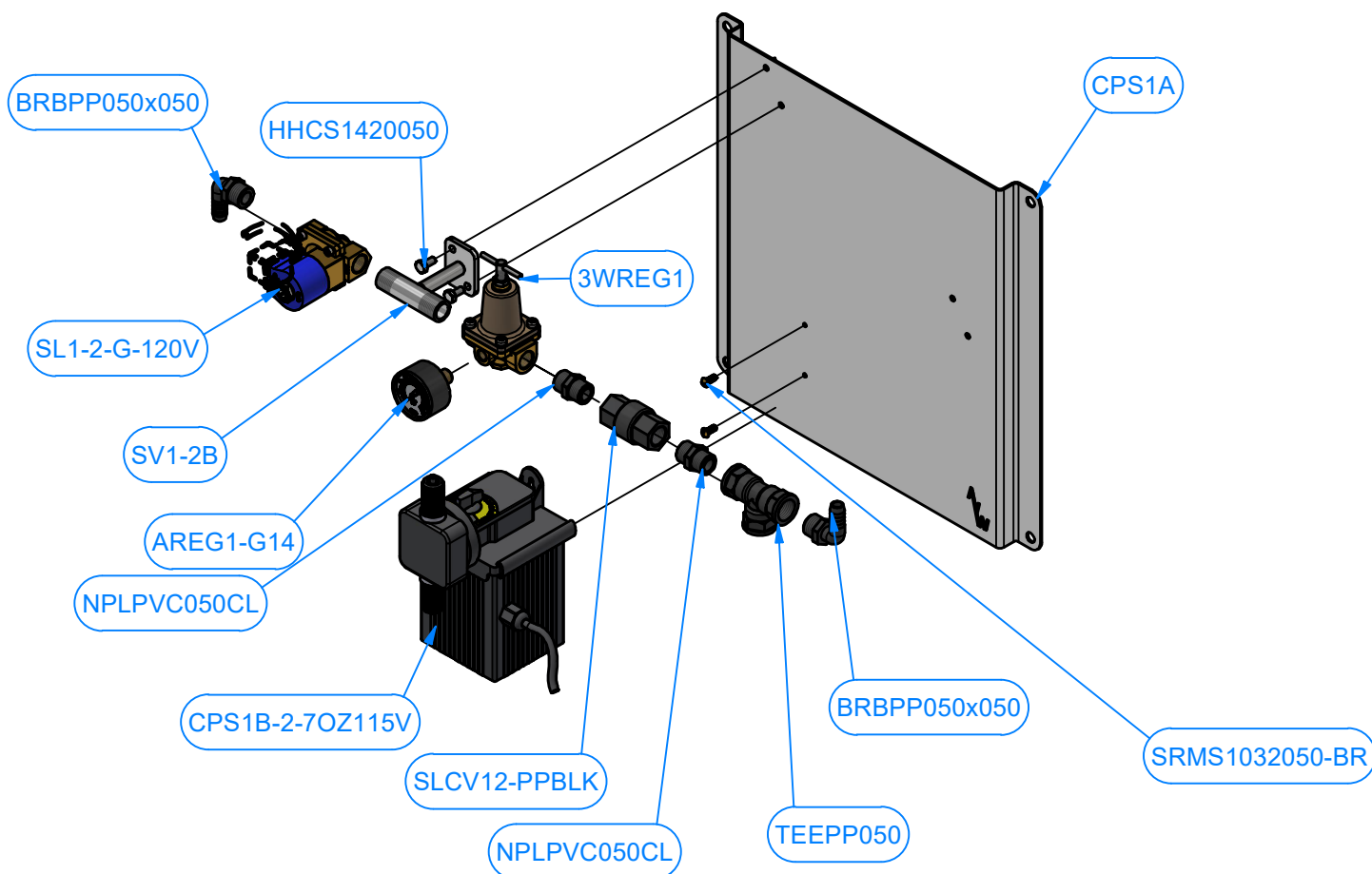

3 of 3