

# OT2-AA1-HP1 - OCTASQUARE HIGH PRESSURE APPLICATOR ARCH

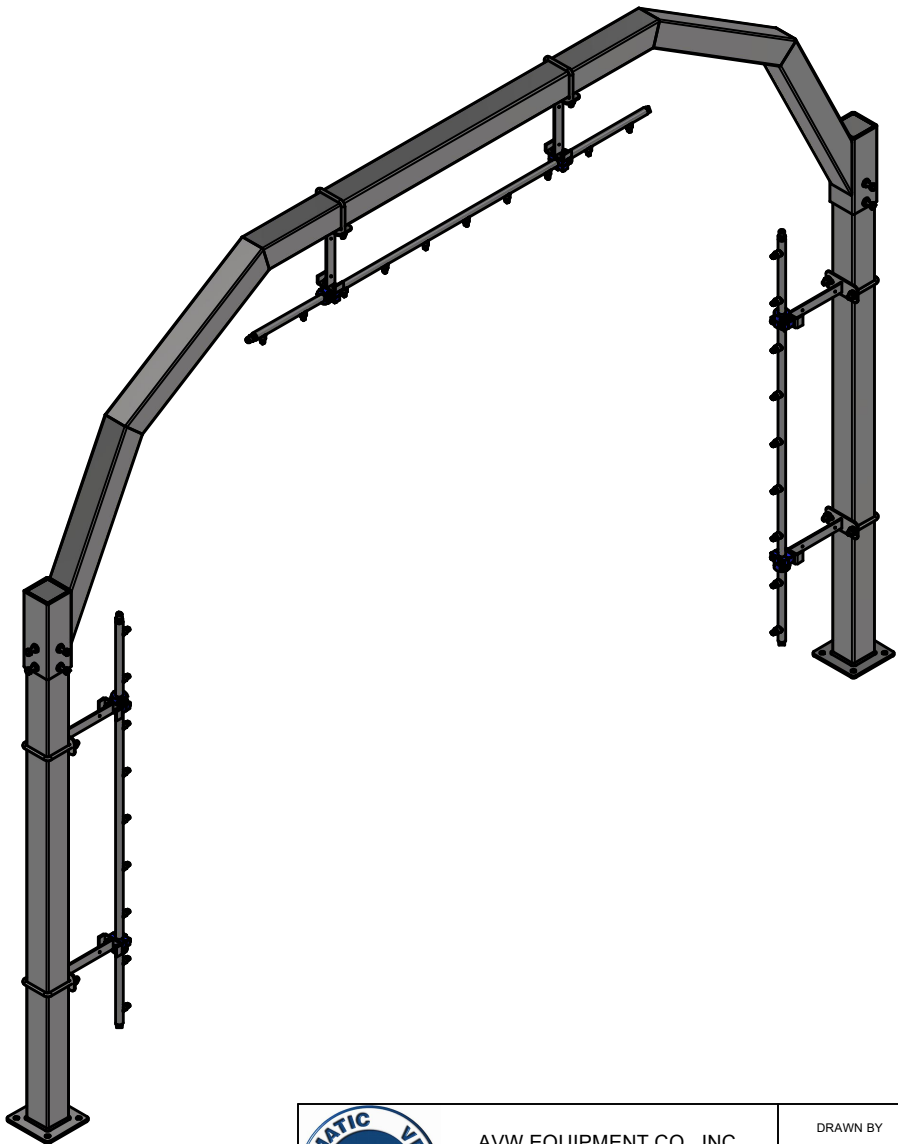

AVW EQUIPMENT CO., INC.  
105 S. 9TH AVENUE  
MAYWOOD, IL 60153  
Tel: 708-343-7738 Fax: 708-343-9065  
WWW.AVWEQUIPMENT.COM

**- COMPANY PROPRIETARY NOTE -**  
THIS DRAWING AND ITS DESIGNS ARE PROPERTY OF AVW EQUIPMENT CO. &  
IT IS NOT TO BE USED OR REPRODUCED WITHOUT THE PERMISSION FROM AVW CO.

DRAWN BY	Darpan	CUSTOMER: AVW EQUIPMENT CO.	
CHECKED BY		PROJECT: OT2-AA1_OCTASQUARE APPLICATOR ARCH	
QTY		DESCRIPTION: OCTASQUARE HIGH PRESSURE APPLICATOR ARCH	
RELEASE DATE	8/25/2021	PART NUMBER: OT2-AA1-HP1	REV# 1
DIMENSION ARE IN INCHES & PROVIDED PRIOR TO SURFACE TREATMENTS, UNLESS NOTED.		SIZE A	EST WEIGHT: 327 lbmass
			SHEET 1 of 14

PATH:L:\Designs\Product Lines\High Pressure Arches\Octasquare\OT2-AA1-HP1\OT2-AA1-HP1.iam

# OT2-AA1-HP1 - OCTASQUARE HIGH PRESSURE APPLICATOR ARCH

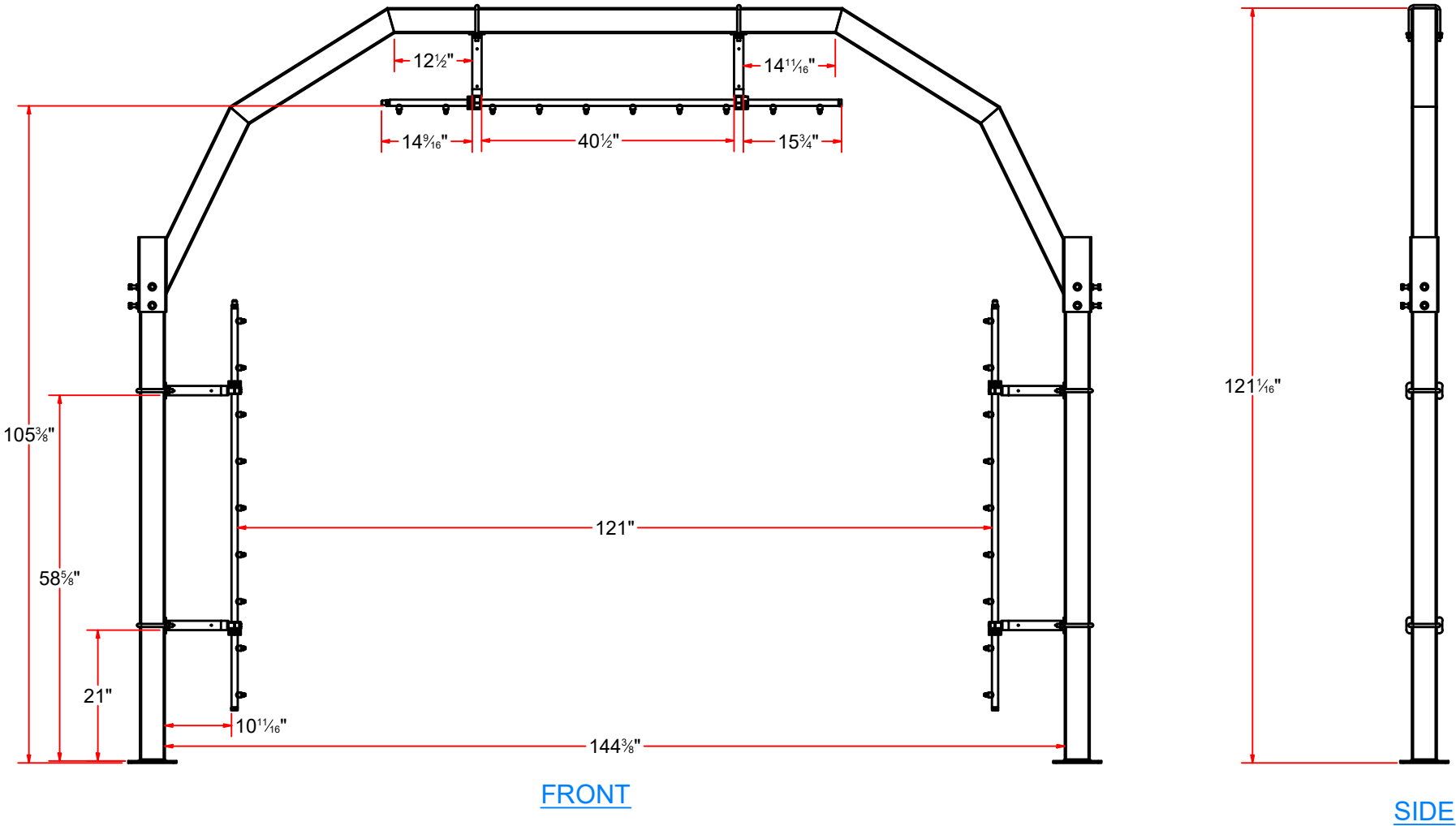

AVW EQUIPMENT CO., INC.  
105 S. 9TH AVENUE  
MAYWOOD, IL 60153  
Tel: 708-343-7738 Fax: 708-343-9065  
WWW.AVWEQUIPMENT.COM

**- COMPANY PROPRIETARY NOTE -**  
THIS DRAWING AND ITS DESIGNS ARE PROPERTY OF AVW EQUIPMENT CO. &  
IT IS NOT TO BE USED OR REPRODUCED WITHOUT THE PERMISSION FROM AVW CO.

PATH:L:\Designs\Product Lines\High Pressure Arches\Octasquare\OT2-AA1-HP1\OT2-AA1-HP1.iam

DRAWN BY	Darpan	CUSTOMER: AVW EQUIPMENT CO.	
CHECKED BY		PROJECT: OT2-AA1_OCTASQUARE APPLICATOR ARCH	
QTY		DESCRIPTION: OCTASQUARE HIGH PRESSURE APPLICATOR ARCH	
RELEASE DATE	8/25/2021	PART NUMBER: OT2-AA1-HP1	REV# 1
DIMENSION ARE IN INCHES & PROVIDED PRIOR TO SURFACE TREATMENTS, UNLESS NOTED.		SIZE A	EST WEIGHT: 327 lbmass
		SHEET 2 of 14	

OT2-AA1-HP1 - OCTASQUARE HIGH PRESSURE APPLICATOR ARCH

Parts List		
ITEM	QTY	DESCRIPTION
1	1	OCTASQUARE EMPTY ARCH
2	6	Square U Bolt D 1/2" x 4" x 6 1/4" LG
3	12	1/2" Split Lock Washer
4	12	1/2-13 HEX NUT
5	2	OCTASQUARE HIGH PRESSURE SIDE MANIFOLD
6	1	OCTASQUARE HIGH PRESSURE TOP MANIFOLD

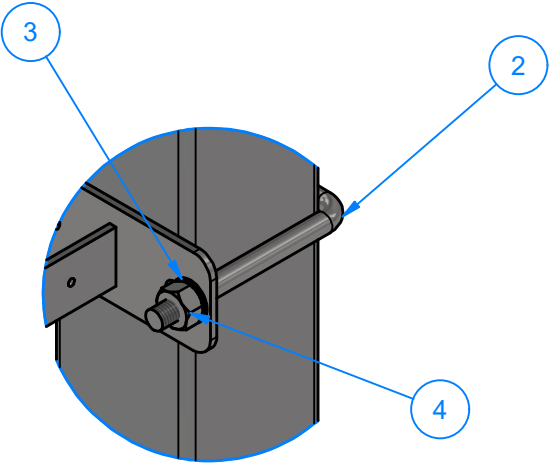
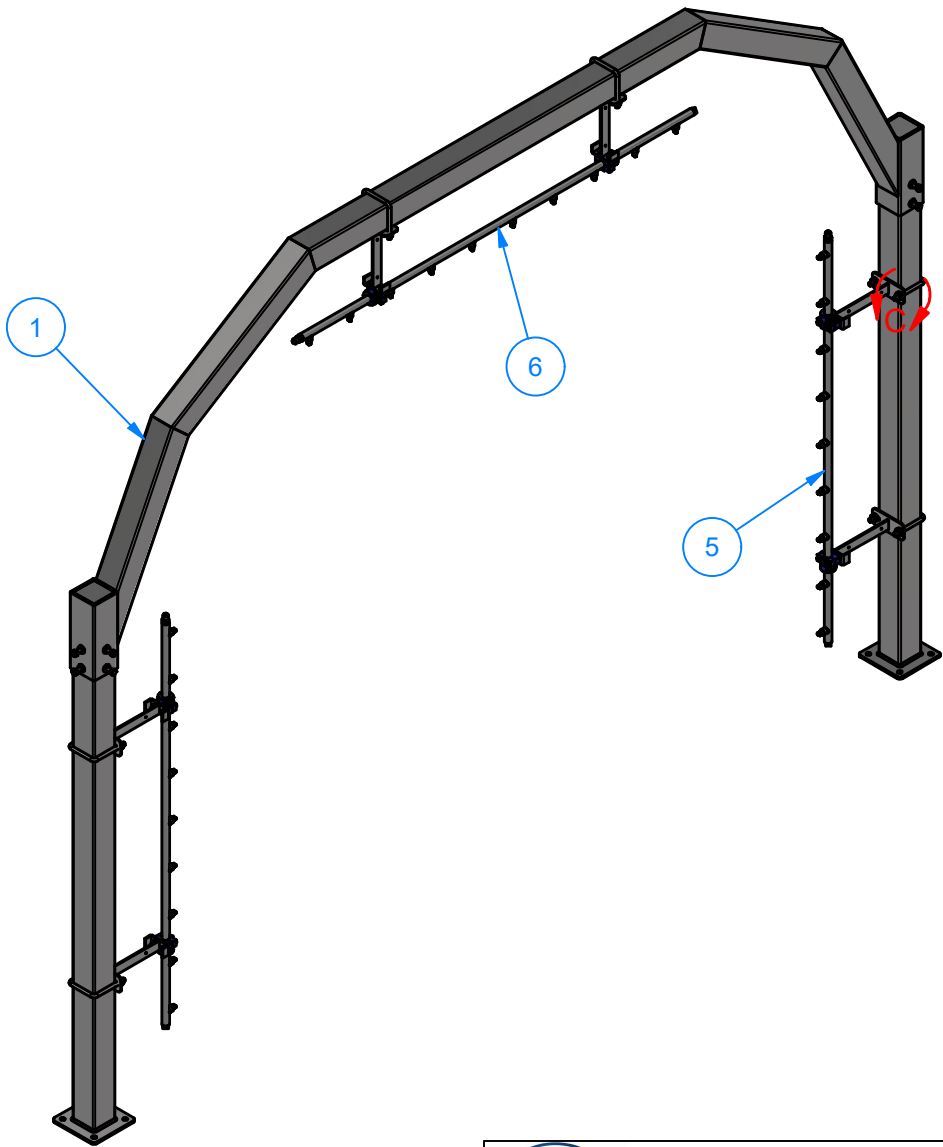

DETAIL C



AVW EQUIPMENT CO., INC.  
105 S. 9TH AVENUE  
MAYWOOD, IL 60153  
Tel: 708-343-7738 Fax: 708-343-9065  
WWW.AVWEQUIPMENT.COM

- COMPANY PROPRIETARY NOTE -  
THIS DRAWING AND ITS DESIGNS ARE PROPERTY OF AVW EQUIPMENT CO. &  
IT IS NOT TO BE USED OR REPRODUCED WITHOUT THE PERMISSION FROM AVW CO.

DRAWN BY	Darpan	CUSTOMER: AVW EQUIPMENT CO.	
CHECKED BY		PROJECT: OT2-AA1_OCTASQUARE APPLICATOR ARCH	
QTY		DESCRIPTION: OCTASQUARE HIGH PRESSURE APPLICATOR ARCH	
RELEASE DATE	8/25/2021	PART NUMBER: OT2-AA1-HP1	REV# 1
DIMENSION ARE IN INCHES & PROVIDED PRIOR TO SURFACE TREATMENTS, UNLESS NOTED.		SIZE A	EST WEIGHT: 327 lbmass
			SHEET 3 of 14

# OT1-AA1-HP1A - OCTASQUARE HIGH PRESSURE SIDE MANIFOLD

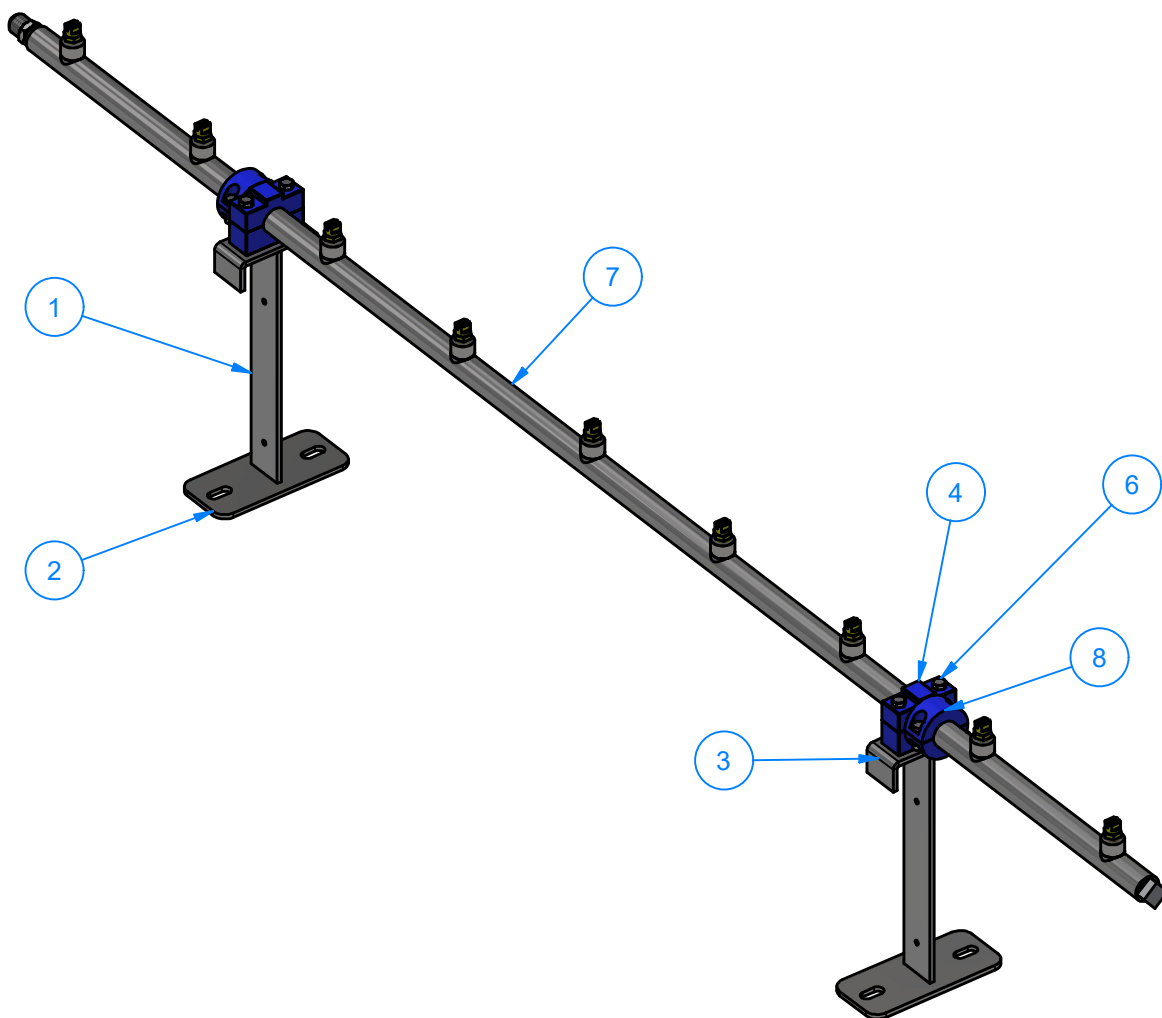

Parts List		
ITEM	QTY	DESCRIPTION
1	2	Plate #3/16" x 1 1/2" x 10" LG.
2	2	Plate #3/16" x 3" x 5 3/4" LG.
3	2	Sheet Metal #3/16" x 1 1/2" x 5" L
4	2	UHMW Manifold Block 1" ID
5	4	1/4"-20 HEX NUT
6	4	Hex Head Cap Screw 1/4"-20 x 2.5"
7	1	Pivoting Arch Side Manifold
8	2	1" ID UHMW Split Collar



AVW EQUIPMENT CO., INC.  
105 S. 9TH AVENUE  
MAYWOOD, IL 60153  
Tel: 708-343-7738 Fax: 708-343-9065  
WWW.AVWEQUIPMENT.COM

## - COMPANY PROPRIETARY NOTE -

THIS DRAWING AND ITS DESIGNS ARE PROPERTY OF AVW EQUIPMENT CO. & IT IS NOT TO BE USED OR REPRODUCED WITHOUT THE PERMISSION FROM AVW CO.

DRAWN BY

Darpan

CUSTOMER: AVW EQUIPMENT CO.

CHECKED BY

PROJECT: OT2-AA1\_OCTASQUARE APPLICATOR ARCH

QTY

DESCRIPTION: OCTASQUARE HIGH PRESSURE SIDE MANIFOLD

RELEASE DATE

8/25/2021

PART NUMBER: OT1-AA1-HP1A

REV# 1

DIMENSION ARE IN INCHES & PROVIDED PRIOR TO SURFACE TREATMENTS, UNLESS NOTED.

SIZE  
A

EST WEIGHT: 1 lbmass

SHEET 4 of 14

PATH:L:\Designs\Product Lines\High Pressure Arches\Octasquare\OT2-AA1-HP1\Parts\OT1-AA1-HP1A.iam

PA1SM - Pivoting Arch Side Manifold

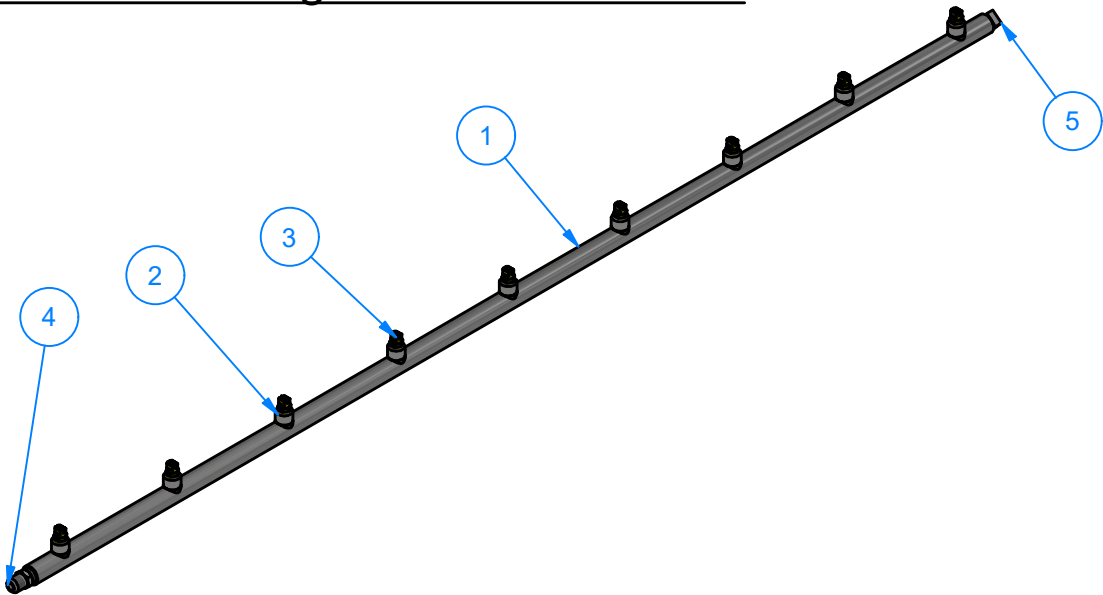

Parts List		
ITEM	QTY	DESCRIPTION
1	1	1" Tubing #.120" Wall x 64" LG.
2	9	1/4" Half Coupling
3	9	NOZZLE - YELLOW - 1/4" MNPT
4	1	Adapter for 1/2" Tube OD x 1/2" NPT Male Pipe
5	1	3/4" Plug

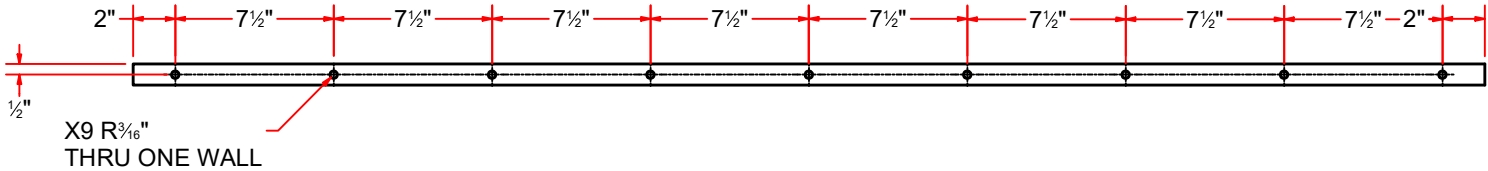

1" Tubing #.120" Wall x 64" LG.



AVW EQUIPMENT CO., INC.  
105 S. 9TH AVENUE  
MAYWOOD, IL 60153  
Tel: 708-343-7738 Fax: 708-343-9065  
WWW.AVWEQUIPMENT.COM

- COMPANY PROPRIETARY NOTE -  
THIS DRAWING AND ITS DESIGNS ARE PROPERTY OF AVW EQUIPMENT CO. &  
IT IS NOT TO BE USED OR REPRODUCED WITHOUT THE PERMISSION FROM AVW CO.

DRAWN BY	Darpan	CUSTOMER: AVW EQUIPMENT CO.	
CHECKED BY		PROJECT: OT2-AA1_OCTASQUARE APPLICATOR ARCH	
QTY		DESCRIPTION: Pivoting Arch Side Manifold	
RELEASE DATE	8/25/2021	PART NUMBER: PA1SM	REV# 1
DIMENSION ARE IN INCHES & PROVIDED PRIOR TO SURFACE TREATMENTS, UNLESS NOTED.		SIZE A	EST WEIGHT: SHEET 5 of 14

OT1-AA1-HP1B - OCTASQUARE HIGH PRESSURE TOP MANIFOLD

Parts List		
ITEM	QTY	DESCRIPTION
1	2	Plate #3/16" x 1 1/2" x 10" LG.
2	2	Plate #3/16" x 3" x 5 3/4" LG.
3	2	Sheet Metal #3/16" x 1 1/2" x 5" L
4	2	UHMW Manifold Block 1" ID
5	4	Hex Head Cap Screw 1/4"-20 x 2.5"
6	4	1/4"-20 HEX NUT
7	1	Pivoting Arch Top Manifold
8	2	1" ID UHMW Split Collar

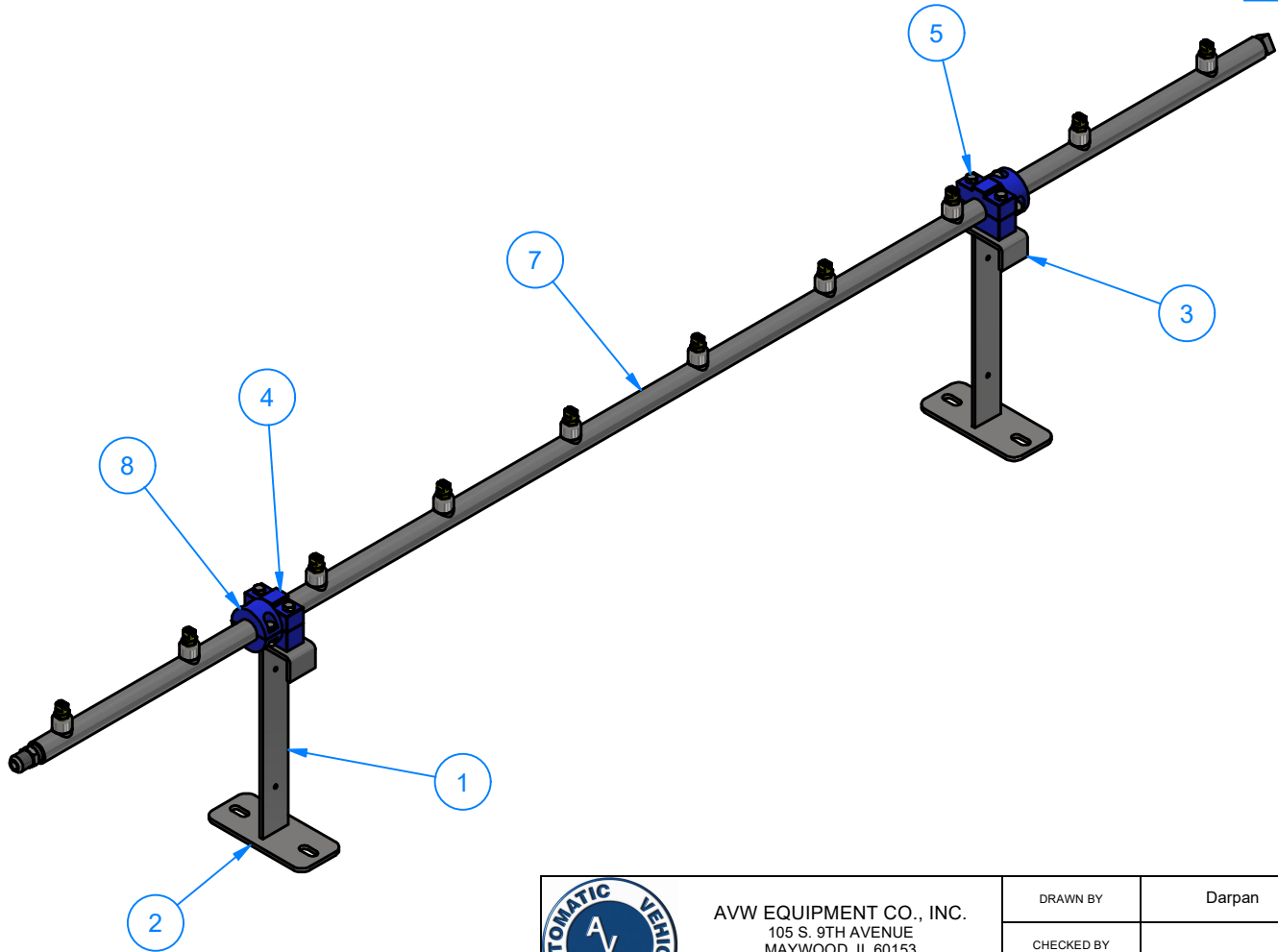

AVW EQUIPMENT CO., INC.  
105 S. 9TH AVENUE  
MAYWOOD, IL 60153  
Tel: 708-343-7738 Fax: 708-343-9065  
WWW.AVWEQUIPMENT.COM

- COMPANY PROPRIETARY NOTE -  
THIS DRAWING AND ITS DESIGNS ARE PROPERTY OF AVW EQUIPMENT CO. &  
IT IS NOT TO BE USED OR REPRODUCED WITHOUT THE PERMISSION FROM AVW CO.

DRAWN BY	Darpan	CUSTOMER: AVW EQUIPMENT CO.	
CHECKED BY		PROJECT: OT2-AA1_OCTASQUARE APPLICATOR ARCH	
QTY		DESCRIPTION: OCTASQUARE HIGH PRESSURE TOP MANIFOLD	
RELEASE DATE	8/25/2021	PART NUMBER: OT1-AA1-HP1B	REV# 1
DIMENSION ARE IN INCHES & PROVIDED PRIOR TO SURFACE TREATMENTS, UNLESS NOTED.		SIZE A	EST WEIGHT: 15 lbmass
			SHEET 6 of 14

PA1TM - Pivoting Arch Top Manifold

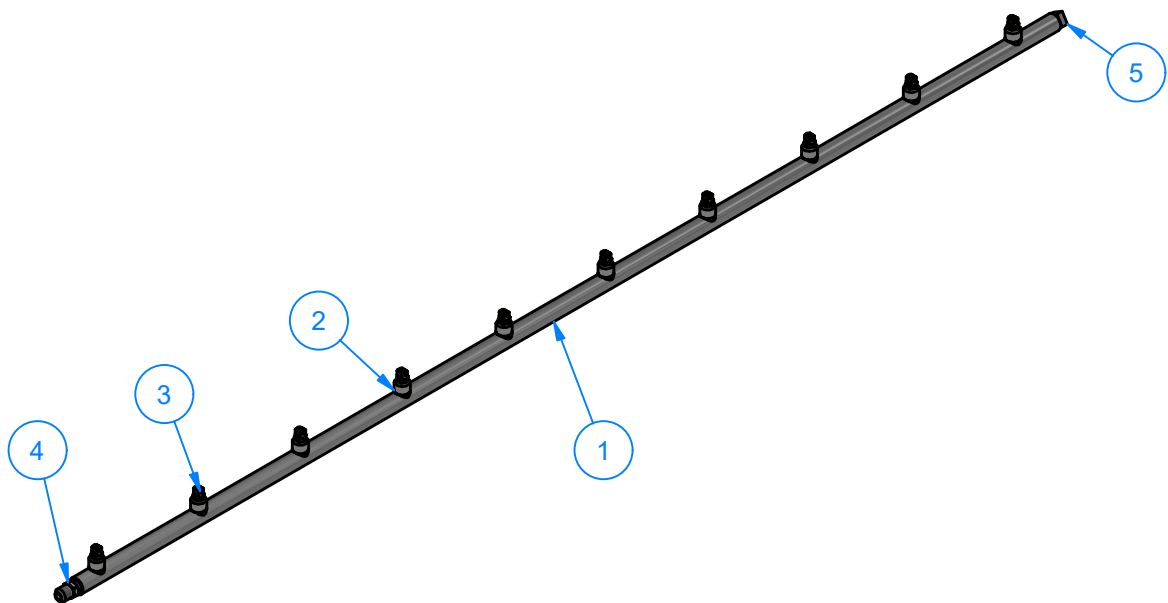

Parts List		
ITEM	QTY	DESCRIPTION
1	1	1" Tubing #.120" Wall x 72" LG.
2	10	1/4" Half Coupling
3	10	NOZZLE - YELLOW - 1/4" MNPT
4	1	Adapter for 1/2" Tube OD x 1/2" NPT Male Pipe
5	1	3/4" Plug

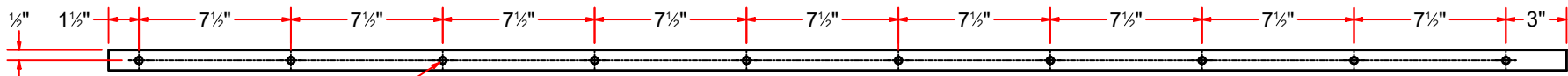

X10 R<sup>3</sup>/<sub>16</sub>"  
THRU ONE WALL

1" Tubing #.120" Wall x 72" LG.



AVW EQUIPMENT CO., INC.  
105 S. 9TH AVENUE  
MAYWOOD, IL 60153  
Tel: 708-343-7738 Fax: 708-343-9065  
WWW.AVWEQUIPMENT.COM

- COMPANY PROPRIETARY NOTE -  
THIS DRAWING AND ITS DESIGNS ARE PROPERTY OF AVW EQUIPMENT CO. &  
IT IS NOT TO BE USED OR REPRODUCED WITHOUT THE PERMISSION FROM AVW CO.

DRAWN BY	Darpan	CUSTOMER: AVW EQUIPMENT CO.	
CHECKED BY		PROJECT: OT2-AA1_OCTASQUARE APPLICATOR ARCH	
QTY		DESCRIPTION: Pivoting Arch Top Manifold	
RELEASE DATE	8/25/2021	PART NUMBER: PA1TM	REV# 1
DIMENSION ARE IN INCHES & PROVIDED PRIOR TO SURFACE TREATMENTS, UNLESS NOTED.		SIZE A	EST WEIGHT: SHEET 7 of 14

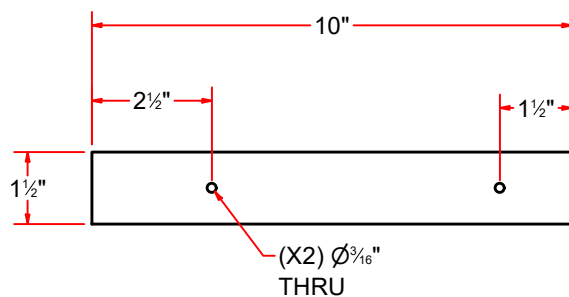
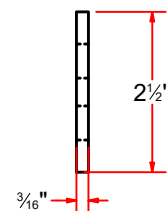

**- COMPANY PROPRIETARY NOTE -**  
THIS DRAWING AND ITS DESIGNS ARE PROPERTY OF AVW EQUIPMENT CO. &  
NOT TO BE USED OR REPRODUCED WITHOUT THE PERMISSION FROM AVW CO.

SHEET 8 of 14

PATH:L:\Designs\Product Lines\Arches\Aplicator Arches\Rainbow Design\Parts\Flat Bracket.ipt



# OT2-AA0 - OCTASQUARE EMPTY ARCH

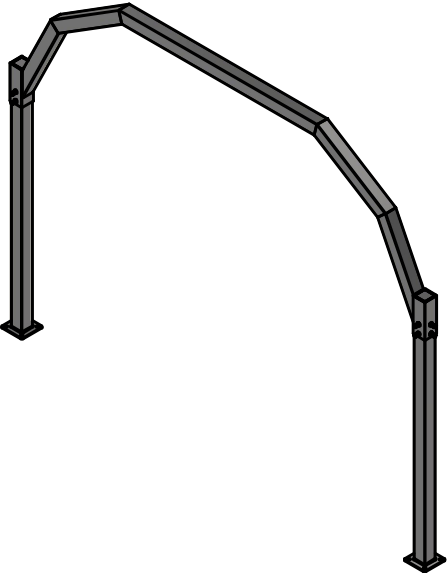
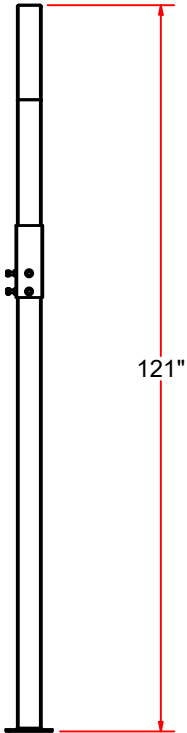
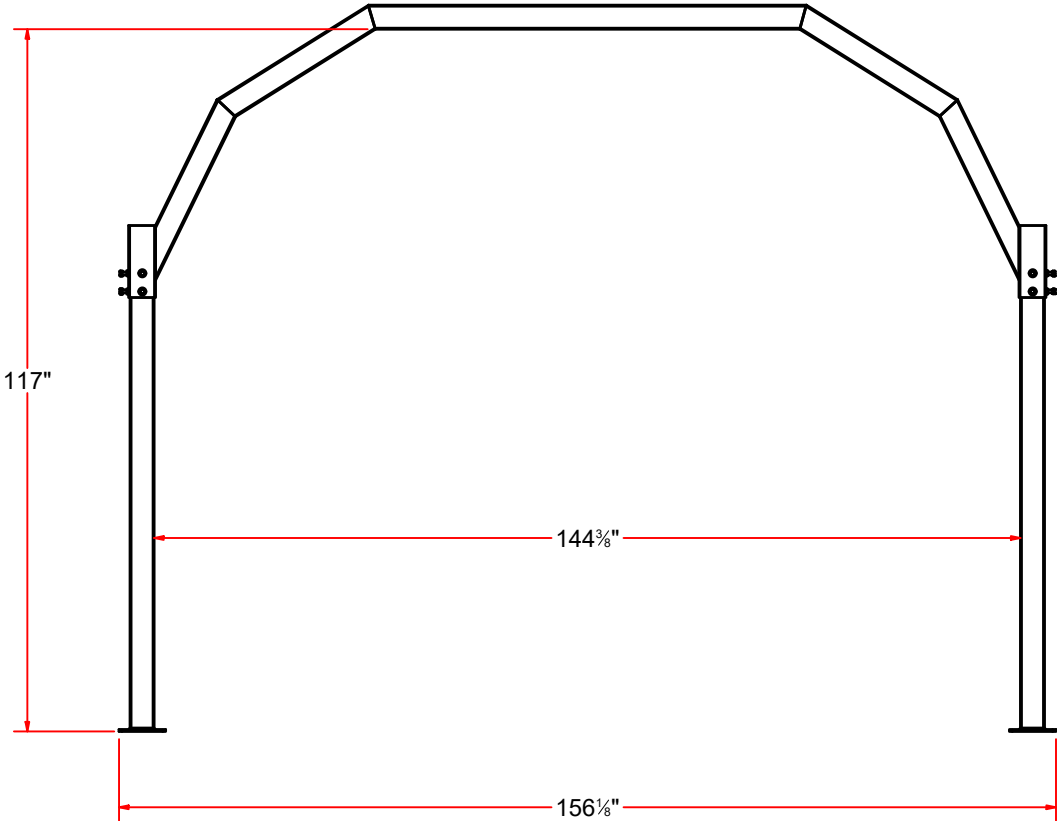

AVW EQUIPMENT CO., INC.  
105 S. 9TH AVENUE  
MAYWOOD, IL 60153  
Tel: 708-343-7738 Fax: 708-343-9065  
WWW.AVWEQUIPMENT.COM

**- COMPANY PROPRIETARY NOTE -**  
THIS DRAWING AND ITS DESIGNS ARE PROPERTY OF AVW EQUIPMENT CO. &  
IT IS NOT TO BE USED OR REPRODUCED WITHOUT THE PERMISSION FROM AVW CO.

DRAWN BY	Darpan	CUSTOMER: AVW EQUIPMENT CO.	
CHECKED BY		PROJECT: OT2-AA1_OCTASQUARE APPLICATOR ARCH	
QTY		DESCRIPTION: OCTASQUARE EMPTY ARCH	
RELEASE DATE	8/25/2021	PART NUMBER: OT2-AA0	REV# 1
DIMENSION ARE IN INCHES & PROVIDED PRIOR TO SURFACE TREATMENTS, UNLESS NOTED.		SIZE A	EST WEIGHT: 308 lbmass
			SHEET 9 of 14

# OT2-AA0 - OCTASQUARE EMPTY ARCH

Parts List		
ITEM	QTY	DESCRIPTION
1	1	OCTASQUARE EMPTY ARCH CROSSBAR
2	2	OCTASQUARE EMPTY ARCH LEG - 84" LG.

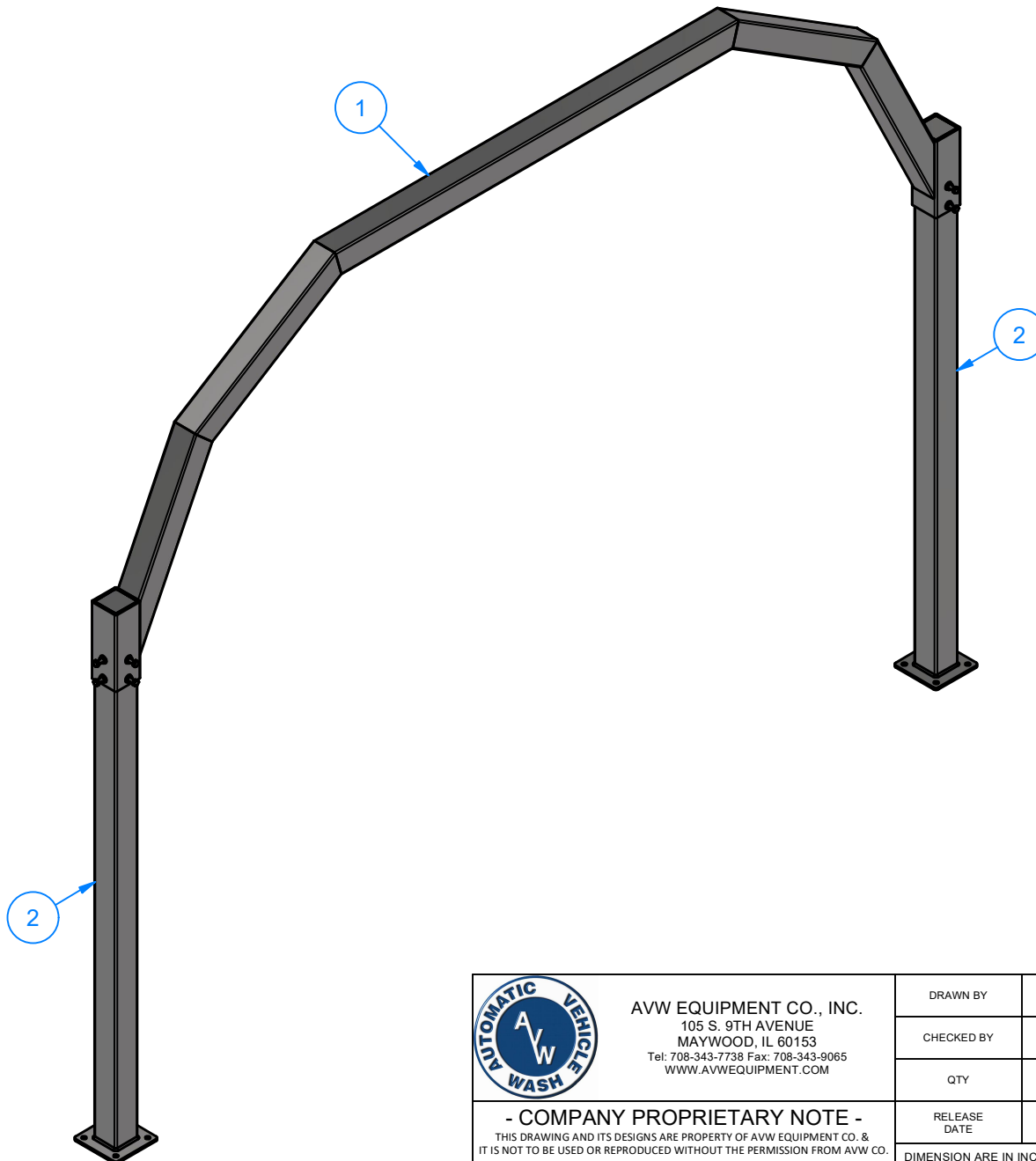

AVW EQUIPMENT CO., INC.  
105 S. 9TH AVENUE  
MAYWOOD, IL 60153  
Tel: 708-343-7738 Fax: 708-343-9065  
WWW.AVWEQUIPMENT.COM

## - COMPANY PROPRIETARY NOTE -

THIS DRAWING AND ITS DESIGNS ARE PROPERTY OF AVW EQUIPMENT CO. & IT IS NOT TO BE USED OR REPRODUCED WITHOUT THE PERMISSION FROM AVW CO.

DRAWN BY

Darpan

CUSTOMER: AVW EQUIPMENT CO.

CHECKED BY

PROJECT: OT2-AA1\_OCTASQUARE APPLICATOR ARCH

QTY

DESCRIPTION: OCTASQUARE EMPTY ARCH

RELEASE DATE

8/25/2021

PART NUMBER: OT2-AA0

REV# 1

DIMENSION ARE IN INCHES & PROVIDED PRIOR TO SURFACE TREATMENTS, UNLESS NOTED.

SIZE  
A

EST WEIGHT: 308 lbmass

SHEET 10 of 14

PATH:L:\Designs\Product Lines\Arches\Empty Arches\OctaSquared Empty Arch\_OT2-AA0 [Rev2]\OT2-AA0.iam

OT2-AA0A - OCTASQUARE EMPTY ARCH LEG - 84" LG.

Parts List		
ITEM	QTY	DESCRIPTION
1	1	Sq. Tubing [7 Gauge] 4" x 84" LG
2	1	SS Sheet Metal #18Ga x 3 7/8"
4	1	SS Plate #5/16" x 7-3/4" x 7-3/4"

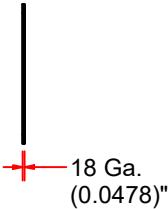
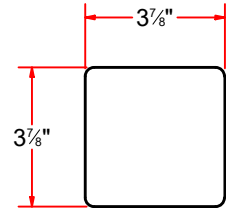
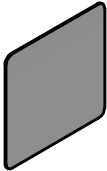
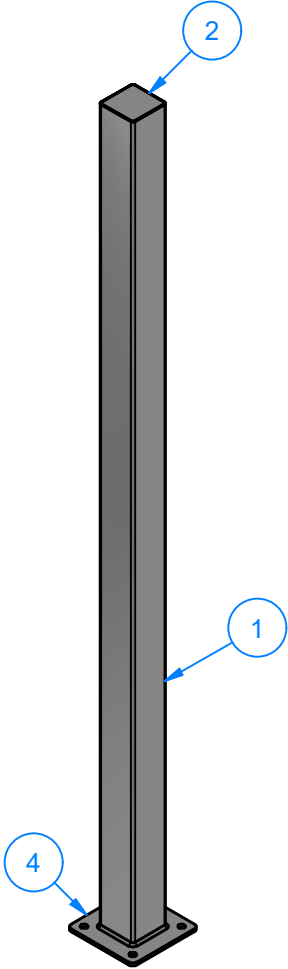
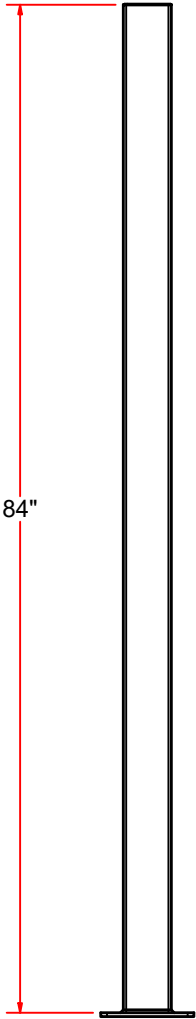
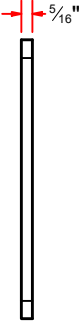
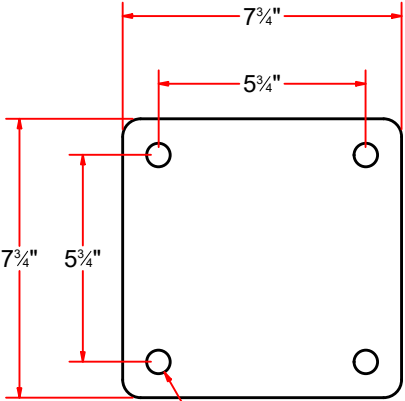
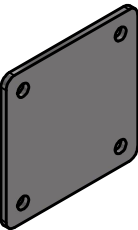

AVW EQUIPMENT CO., INC.  
105 S. 9TH AVENUE  
MAYWOOD, IL 60153  
Tel: 708-343-7738 Fax: 708-343-9065  
WWW.AVWEQUIPMENT.COM

- COMPANY PROPRIETARY NOTE -  
THIS DRAWING AND ITS DESIGNS ARE PROPERTY OF AVW EQUIPMENT CO. &  
IT IS NOT TO BE USED OR REPRODUCED WITHOUT THE PERMISSION FROM AVW CO.

DRAWN BY	Darpan	CUSTOMER: AVW EQUIPMENT CO.	
CHECKED BY		PROJECT: OT2-AA1_OCTASQUARE APPLICATOR ARCH	
QTY		DESCRIPTION: OCTASQUARE EMPTY ARCH LEG - 84" LG.	
RELEASE DATE	8/25/2021	PART NUMBER: OT2-AA0A	REV# 1
DIMENSION ARE IN INCHES & PROVIDED PRIOR TO SURFACE TREATMENTS, UNLESS NOTED.		SIZE A	SHEET 11 of 14

OT2-AA0B - OCTASQUARE EMPTY ARCH CROSSBAR

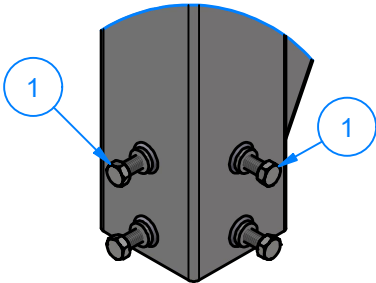
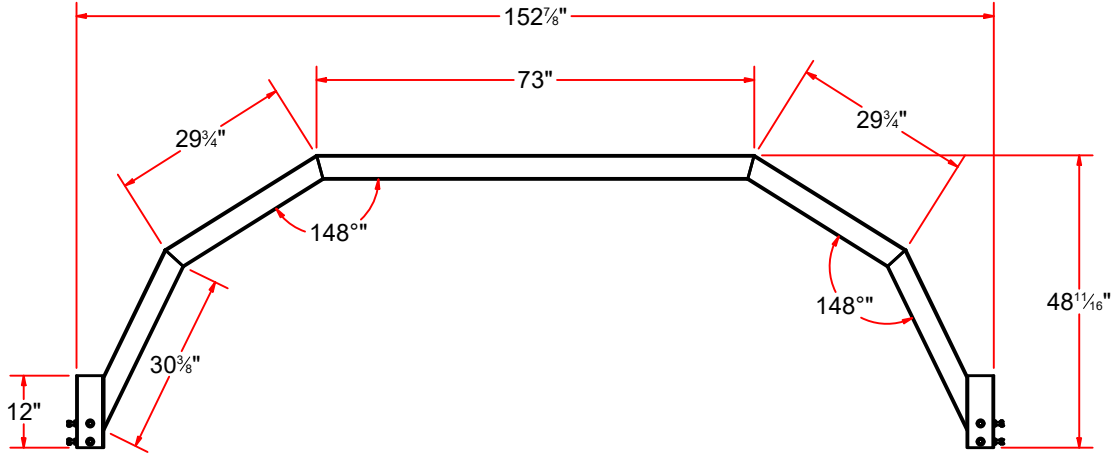

DETAIL A

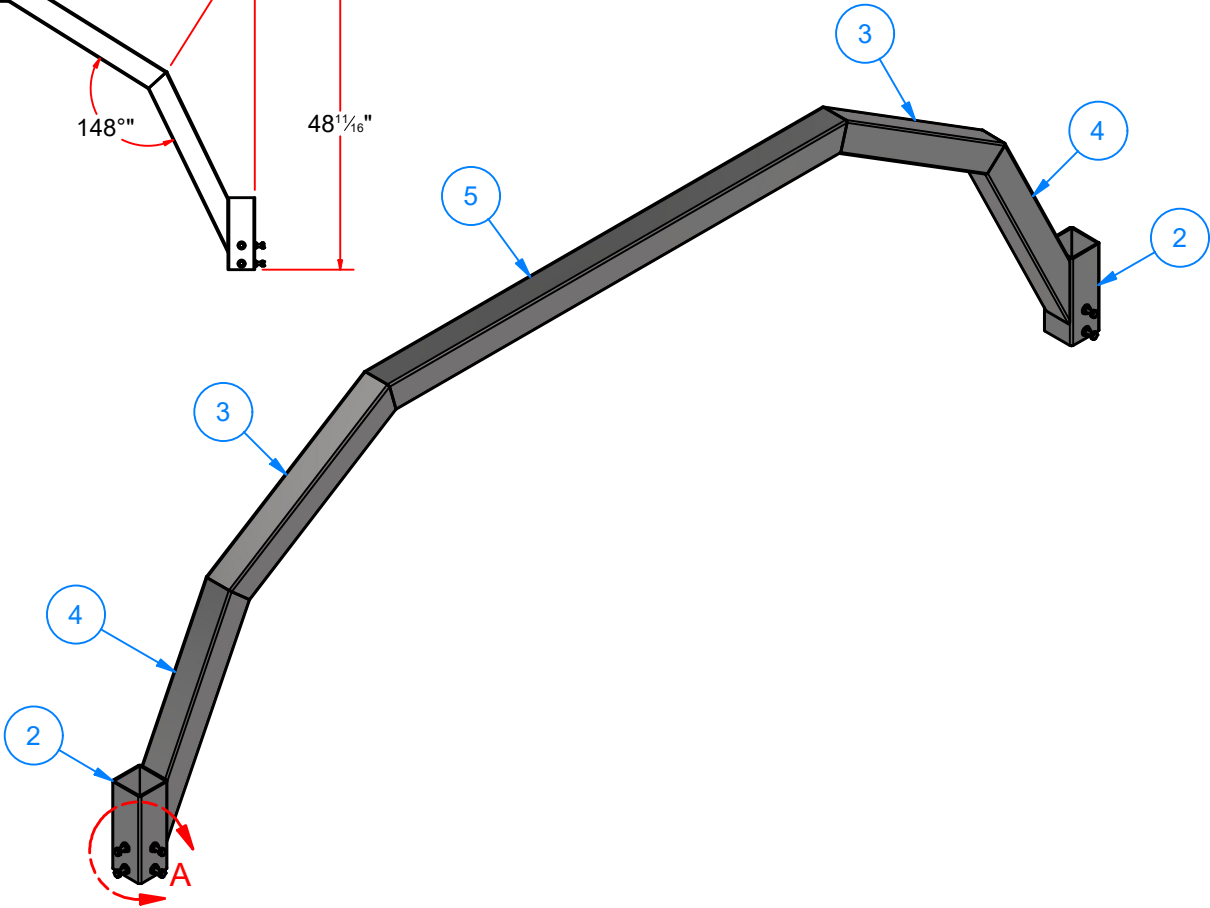

Parts List		
ITEM	QTY	DESCRIPTION
1	8	1/2" - 13 x 1.25" UNC Hex Screw
2	2	SLEEVE 4 1/2" SQ. x 12" LG.
3	2	Sq.Tubing [7 Ga.] 4" x 29 3/4" LG.
4	2	Sq.Tubing [7 Ga.] 4" x 31 1/2" LG.
5	1	Sq.Tubing [7 Ga.] 4" x 73" LG.



AVW EQUIPMENT CO., INC.  
105 S. 9TH AVENUE  
MAYWOOD, IL 60153  
Tel: 708-343-7738 Fax: 708-343-9065  
WWW.AVWEQUIPMENT.COM

- COMPANY PROPRIETARY NOTE -  
THIS DRAWING AND ITS DESIGNS ARE PROPERTY OF AVW EQUIPMENT CO. &  
IT IS NOT TO BE USED OR REPRODUCED WITHOUT THE PERMISSION FROM AVW CO.

DRAWN BY	Darpan	CUSTOMER: AVW EQUIPMENT CO.	
CHECKED BY		PROJECT: OT2-AA1_OCTASQUARE APPLICATOR ARCH	
QTY		DESCRIPTION: OCTASQUARE EMPTY ARCH CROSSBAR	
RELEASE DATE	8/25/2021	PART NUMBER: OT2-AA0B	REV# 1
DIMENSION ARE IN INCHES & PROVIDED PRIOR TO SURFACE TREATMENTS, UNLESS NOTED.		SIZE A	EST WEIGHT: 165 lbmass
			SHEET 12 of 14

# OCTASQUARED TOP CROSSBAR - Parts

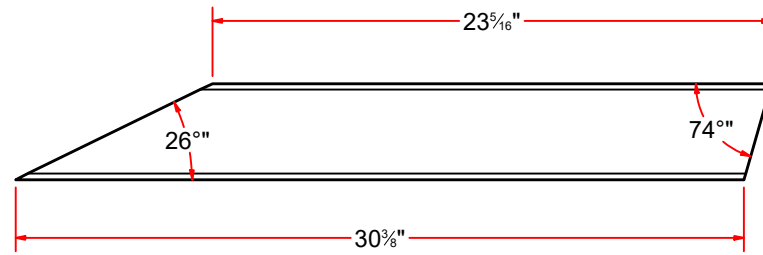
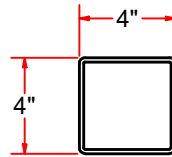
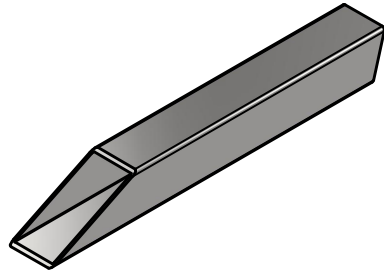

Sq.Tubing [7 Ga.] 4" x 31 1/2" LG.

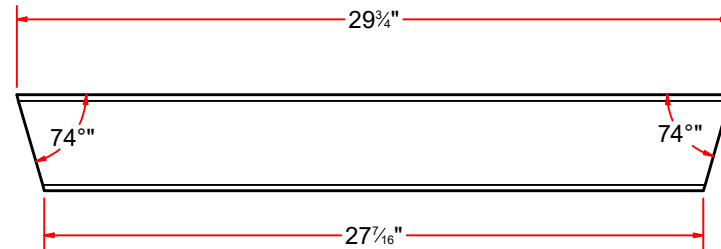
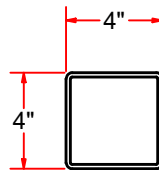
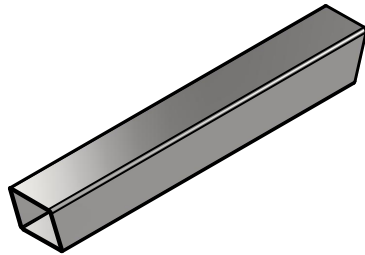

Sq.Tubing [7 Ga.] 4" x 29 3/4" LG.

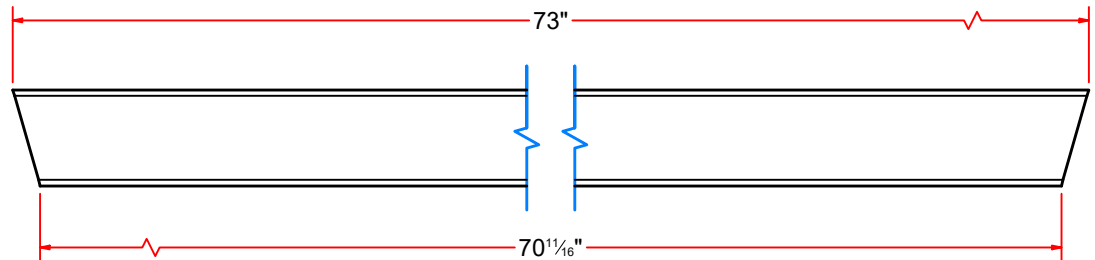
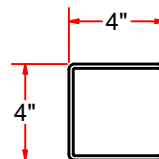
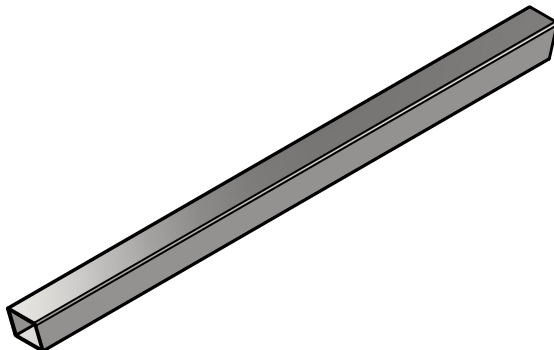

Sq.Tubing [7 Ga.] 4" x 73" LG.



AVW EQUIPMENT CO., INC.  
105 S. 9TH AVENUE  
MAYWOOD, IL 60153  
Tel: 708-343-7738 Fax: 708-343-9065  
WWW.AVWEQUIPMENT.COM

## - COMPANY PROPRIETARY NOTE -

THIS DRAWING AND ITS DESIGNS ARE PROPERTY OF AVW EQUIPMENT CO. & IT IS NOT TO BE USED OR REPRODUCED WITHOUT THE PERMISSION FROM AVW CO.

DRAWN BY

Darpan

CUSTOMER: AVW EQUIPMENT CO.

CHECKED BY

PROJECT: OT2-AA1\_OCTASQUARE APPLICATOR ARCH

QTY

DESCRIPTION: Sq.Tubing [7 Ga.] 4" x 31 1/2" LG.

RELEASE DATE

8/25/2021

PART NUMBER: OT2-AA0BC

REV# 1

DIMENSION ARE IN INCHES & PROVIDED PRIOR TO SURFACE TREATMENTS, UNLESS NOTED.

SIZE  
A

EST WEIGHT:

SHEET 13 of 14

PATH:L:\Libraries\Productivity\Arches\OctaSquared Empty Arch Crossbar\_OT2-AA0B [Rev2]\Parts\OT2-AA0BC.ipt

# SLEEVE 4 1/2" SQ. x 12" LG.

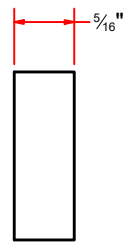
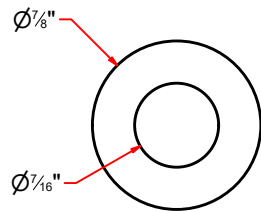
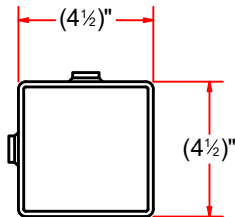
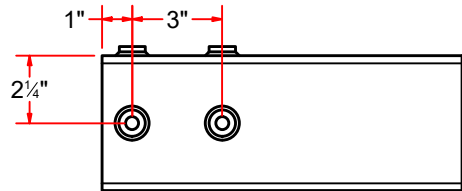
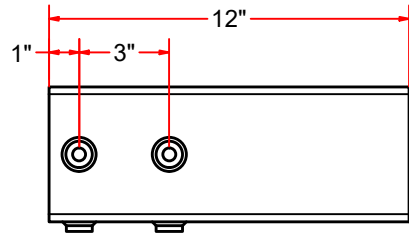

## NOTES:

- 1) WELD NUTS AS SHOWN.
- 2) DRILL THRU SLEEVE USING NUTS AS GUIDE.
- 3) TAP 1/2"-13 THRU ALL HOLES

Parts List		
ITEM	QTY	DESCRIPTION
1	1	Sq.Tubing [7 Ga.] 4 1/2" x 12" LG
2	4	Sleeve Nut 1/2" #5/16" x 7/8"OD x 7/16"ID

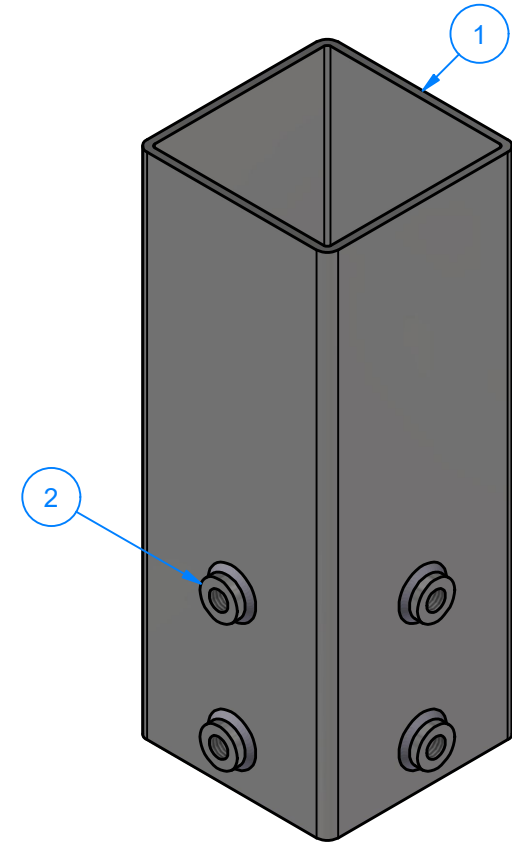

AVW EQUIPMENT CO., INC.  
105 S. 9TH AVENUE  
MAYWOOD, IL 60153  
Tel: 708-343-7738 Fax: 708-343-9065  
WWW.AVWEQUIPMENT.COM

### - COMPANY PROPRIETARY NOTE -

THIS DRAWING AND ITS DESIGNS ARE PROPERTY OF AVW EQUIPMENT CO. & IT IS NOT TO BE USED OR REPRODUCED WITHOUT THE PERMISSION FROM AVW CO.

DRAWN BY

Darpan

CUSTOMER: AVW EQUIPMENT CO.

CHECKED BY

PROJECT: OT2-AA1\_OCTASQUARE APPLICATOR ARCH

QTY

DESCRIPTION: SLEEVE 4 1/2" SQ. x 12" LG.

RELEASE DATE

8/25/2021

PART NUMBER: AA0-BA

REV# 1

DIMENSION ARE IN INCHES & PROVIDED PRIOR TO SURFACE TREATMENTS, UNLESS NOTED.

SIZE  
A

EST WEIGHT: 11

SHEET 14 of 14

PATH:L:\Libraries\Productivity\Sleeves\Sq. Tubing [7 Gauge] 4.5 in x 12 in LG\_Weldment\Sleeve 4.5 in x 12 in LG.iam